

R. 12 W.

R. 11 W.

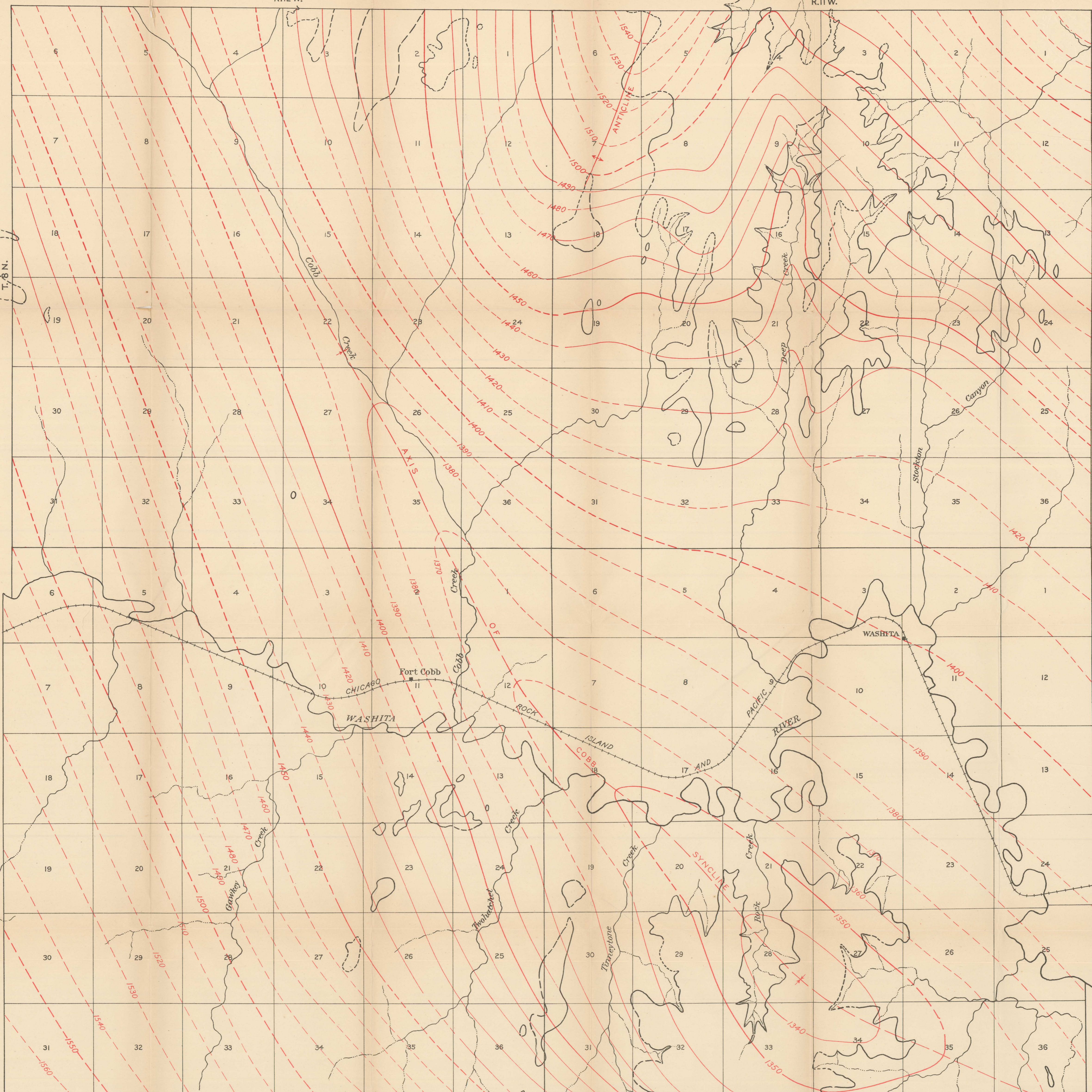

R. 12 W.

EXPLANATION

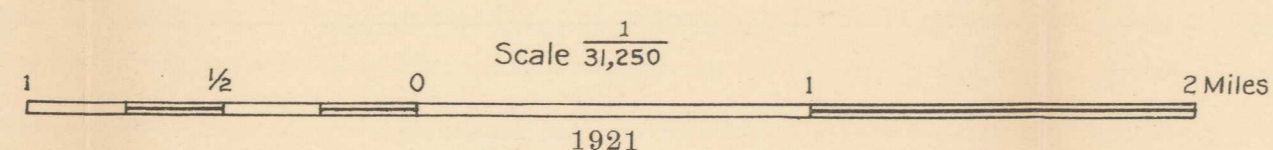
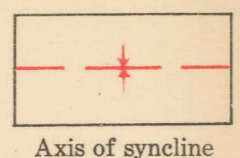
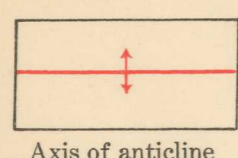
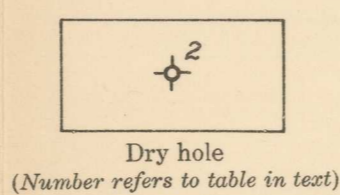
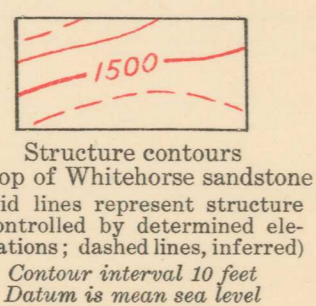
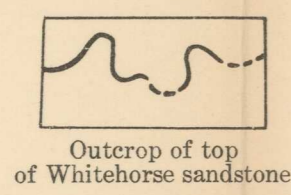

T. 6 N.

T. 6 N.

R. 11 W.

MAP SHOWING GEOLOGIC STRUCTURE OF TPS. 7 AND 8 N., RS. 11 AND 12 W., AND PART OF T. 6 N., R. 11 W., CADDO COUNTY, OKLAHOMA