

EXPLANATION

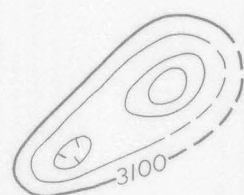

Magnetic contours  
Showing total intensity magnetic field of the earth  
in gammas relative to arbitrary datum. Hachured  
to indicate closed areas of lower magnetic intensity,  
dashed where data are incomplete. Contour interval 20 gammas

Location of measured maximum or minimum  
intensity within closed high or closed low

Flight path  
Showing location and spacing of data

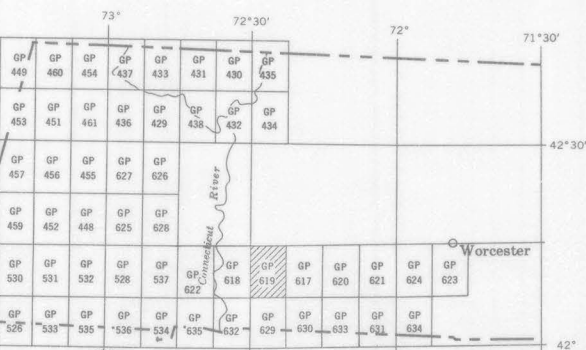

INDEX MAP OF WESTERN MASSACHUSETTS SHOWING  
AEROMAGNETIC MAPS PUBLISHED BY THE U.S.  
GEOLOGICAL SURVEY. AREA OF GP-619, SHADED

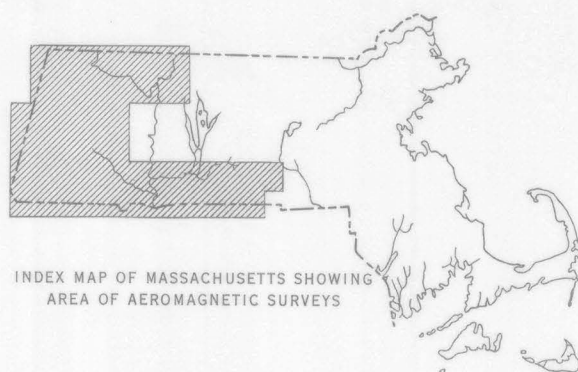

INDEX MAP OF MASSACHUSETTS SHOWING  
AREA OF AEROMAGNETIC SURVEYS



Base from U.S. Geological Survey, 1954

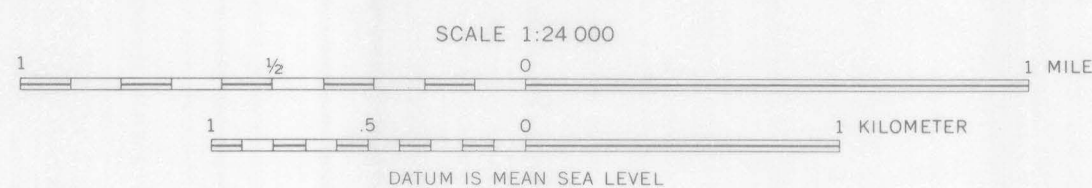
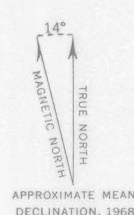

DATUM IS MEAN SEA LEVEL

AEROMAGNETIC MAP OF THE LUDLOW QUADRANGLE  
HAMPDEN AND HAMPSHIRE COUNTIES, MASSACHUSETTS  
1968

Aeromagnetic survey flown 500 feet above  
ground, 1959 by Peter Popenoe, and 1965  
by P. W. Philbin. Compilation supervised  
by F. P. Gilbert

For sale by U.S. Geological Survey, price 50 cents