

EXPLANATION

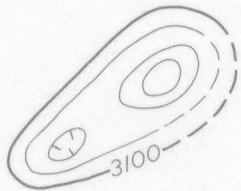

Magnetic contours  
Showing total intensity magnetic field of the earth in gammas relative to arbitrary datum. Hachured to indicate closed areas of lower magnetic intensity, dashed where data are incomplete. Contour interval 20 gammas

Location of measured maximum or minimum intensity within closed high or closed low

Flight path  
Showing location and spacing of data

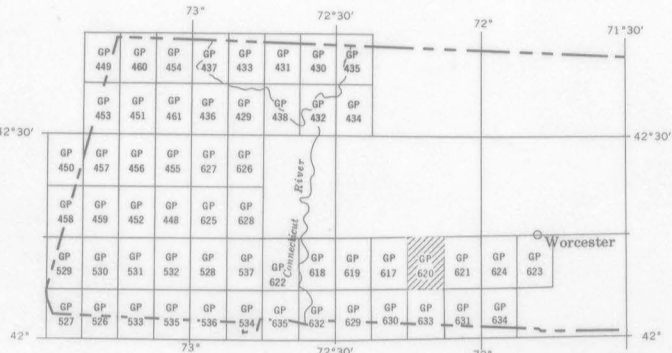

INDEX MAP OF WESTERN MASSACHUSETTS SHOWING AEROMAGNETIC MAPS PUBLISHED BY THE U.S. GEOLOGICAL SURVEY AREA OF GP-620 SHADDED

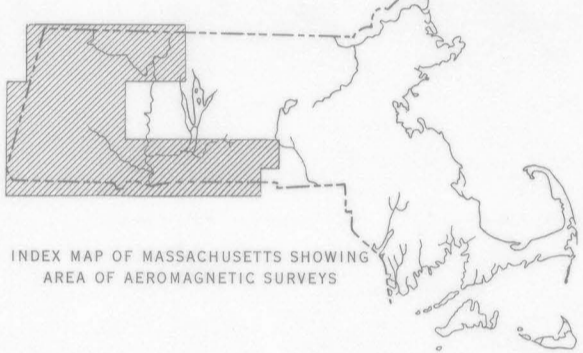

INDEX MAP OF MASSACHUSETTS SHOWING AREA OF AEROMAGNETIC SURVEYS

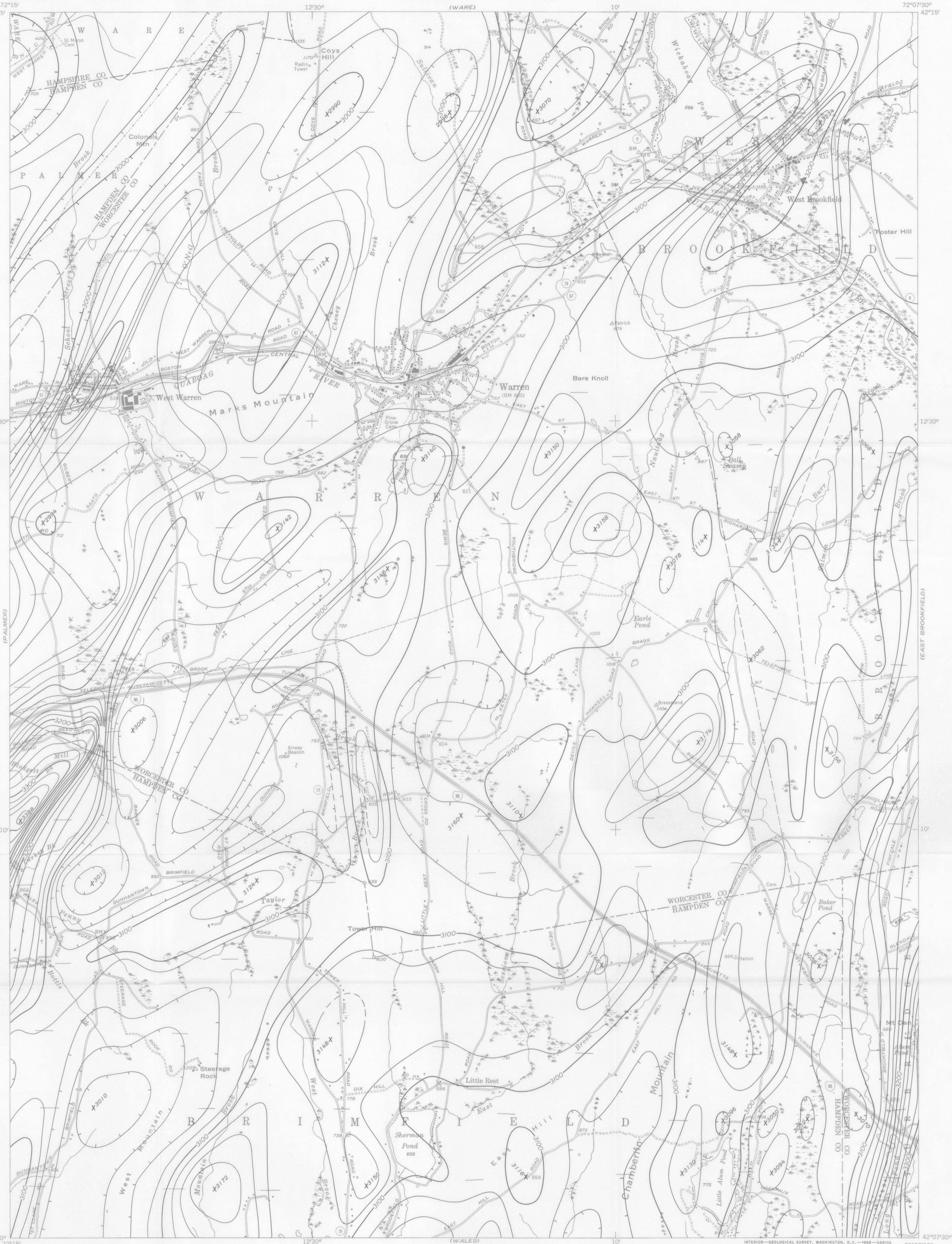

Base from U.S. Geological Survey, 1954

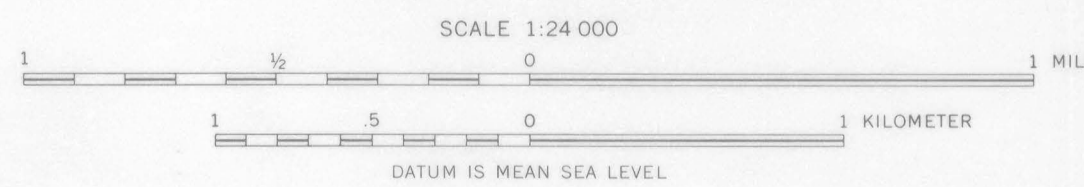
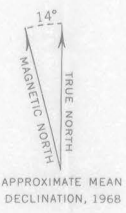

AEROMAGNETIC MAP OF THE WARREN QUADRANGLE  
WORCESTER, HAMPDEN, AND HAMPSHIRE COUNTIES, MASSACHUSETTS  
1968

Aeromagnetic survey flown 500 feet above ground, 1959 by Peter Popenoe, and 1965 by P. W. Philbin. Compilation supervised by F. P. Gilbert

For sale by U.S. Geological Survey, price 50 cents