

MOUNT TOWN
72°37'30"
42°07'30"

42°00'
72°30'
42°07'30"

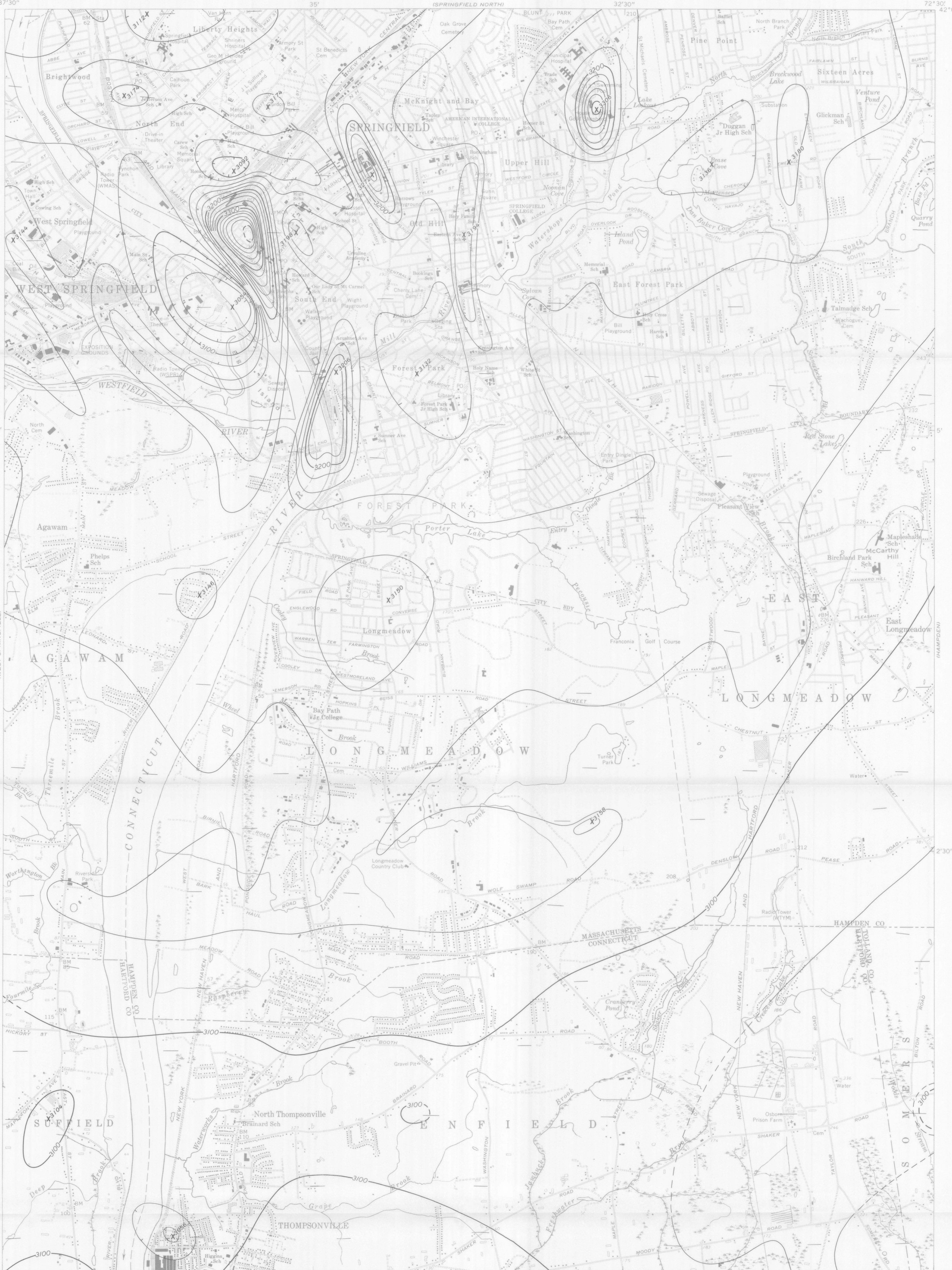

Base from U.S. Geological Survey, 1958

SCALE 1:24 000

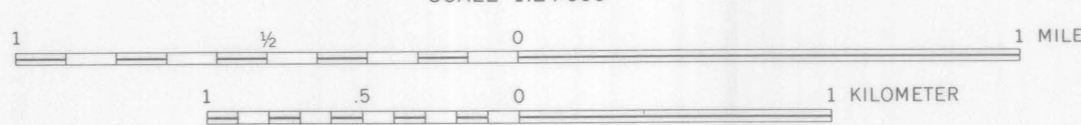

Aeromagnetic survey flown at 500 feet above ground,
1959 by Peter Popenoe, and 1965 by P. W. Philbin.
Compilation supervised by F. P. Gilbert

EXPLANATION

- Magnetic contours
Showing total intensity magnetic field of the earth
in gammas relative to arbitrary datum. Hachured
to indicate closed areas of lower magnetic
intensity, dashed where data are incomplete. Contour
interval 20 gammas
- Location and amount of measured maximum
or minimum intensity within closed high
or closed low
- Flight path
Showing location and spacing of data

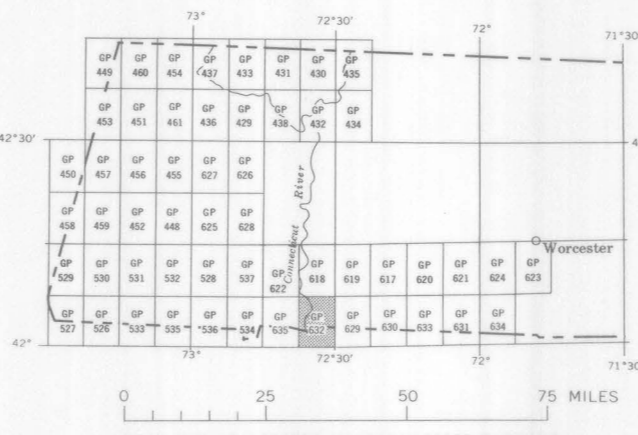
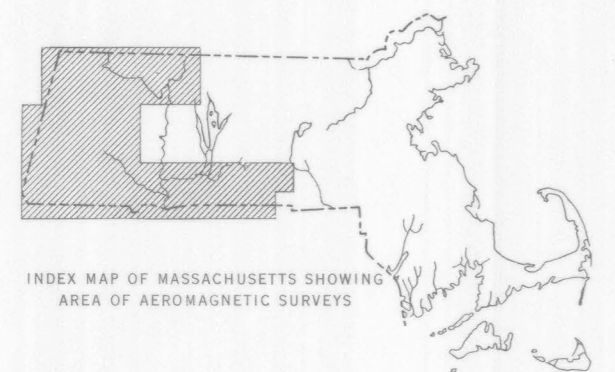

AEROMAGNETIC MAP OF THE SPRINGFIELD SOUTH QUADRANGLE, HAMPDEN COUNTY, MASSACHUSETTS
AND HARTFORD AND TOLLAND COUNTIES, CONNECTICUT