

(EAST BROOKFIELD)

DEPARTMENT OF THE INTERIOR
UNITED STATES GEOLOGICAL SURVEY

PREPARED IN PART IN COOPERATION WITH THE
COMMONWEALTH OF MASSACHUSETTS
DEPARTMENT OF PUBLIC WORKS
(LEICESTER)

GEOPHYSICAL INVESTIGATIONS
MAP GP-634

(WORCESTER SOUTH)

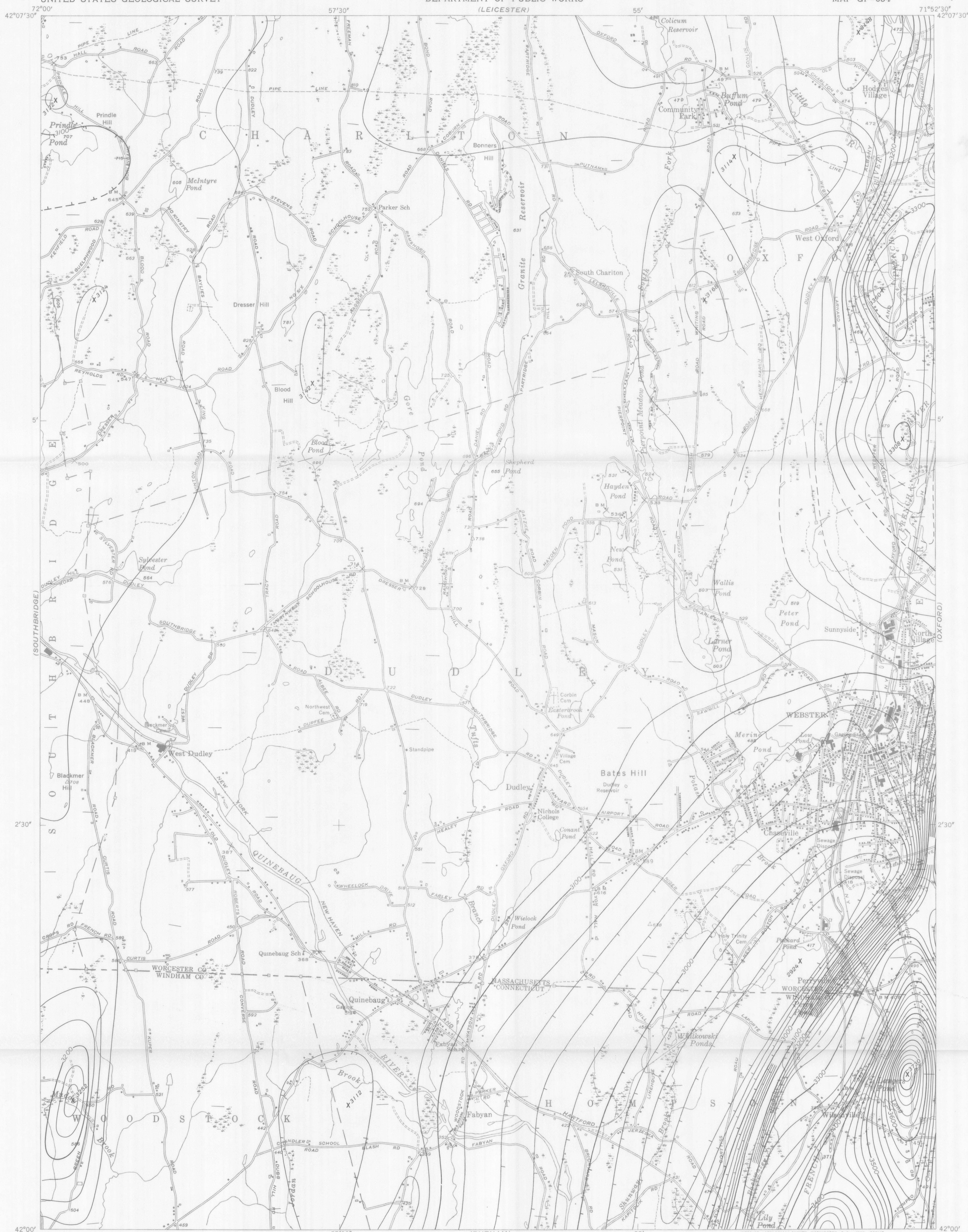

(EAST FORD)

Base from U.S. Geological Survey, 1953

SCALE 1:24 000

Aeromagnetic survey flown at 500 feet above ground,
1959 by Peter Popenoe, and 1963 by P. W. Philbin.
Compilation supervised by F. P. Gilbert

(THOMPSON)

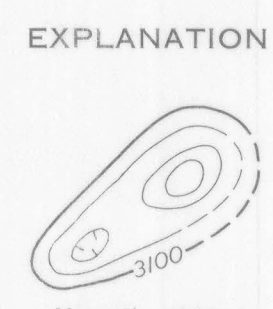
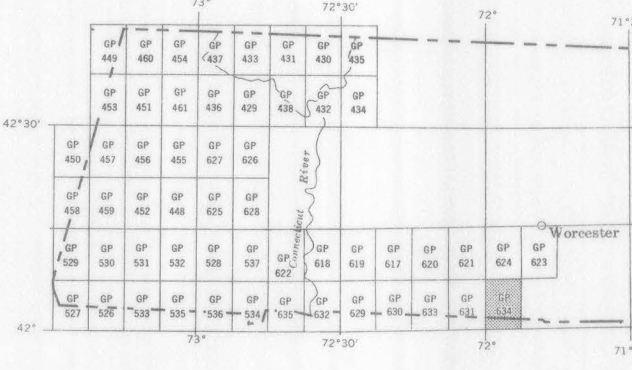
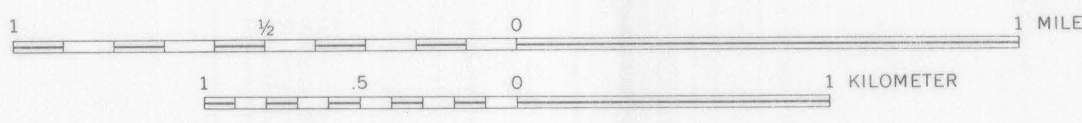
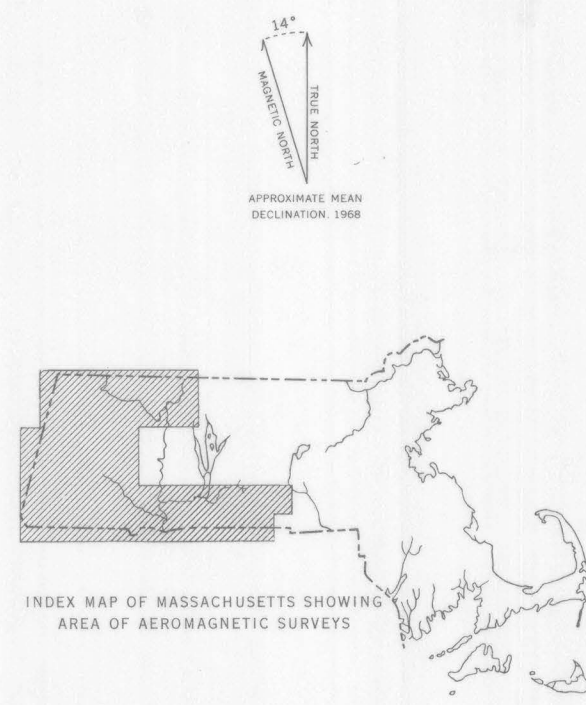

AEROMAGNETIC MAP OF THE WEBSTER QUADRANGLE, WORCESTER COUNTY, MASSACHUSETTS, AND WINDHAM COUNTY, CONNECTICUT