

Base from U.S. Geological Survey, 1947

SCALE 1:24 000

Aeromagnetic survey flown 500 feet above ground,
1959 by Peter Popenoe, and 1966 by E. P. Smith.
Compilation supervised by F. P. Gilbert

EXPLANATION



Magnetic contours
Showing total intensity magnetic field of the earth
in gammas relative to arbitrary datum. Hatched
to indicate closed areas of lower magnetic intensity,
dashed where data are incomplete. Contour
intervals 20 and 100 gammas

Location of measured maximum or minimum
intensity within closed high or closed low

Flight path
Showing location and spacing of data

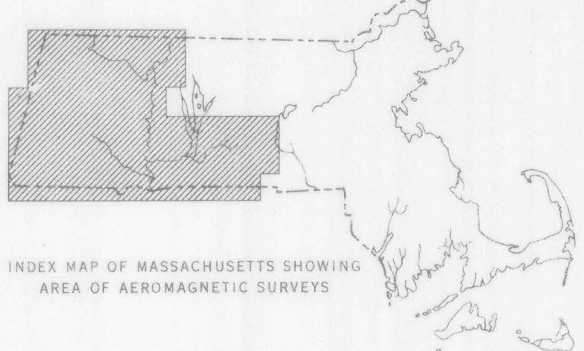

INDEX MAP OF MASSACHUSETTS SHOWING
AREA OF AEROMAGNETIC SURVEYS

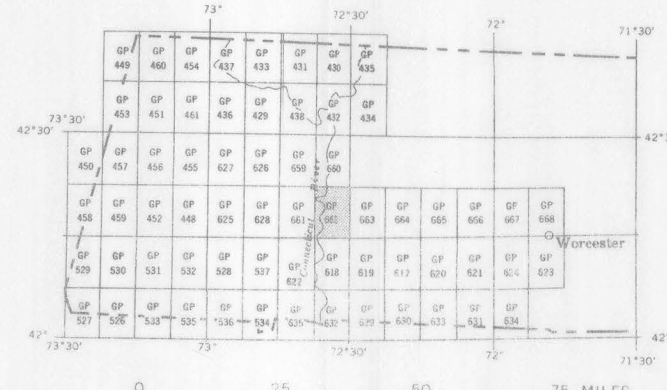

INDEX MAP OF WESTERN MASSACHUSETTS SHOWING
AEROMAGNETIC MAPS PUBLISHED BY THE U.S.
GEOLOGICAL SURVEY AREA OF GP-662 SHADED