

Base from U.S. Geological Survey, 1950

SCALE 1:24 000

Aeromagnetic survey flown 500 feet above ground, 1959 by Peter Popeno, and 1966 by E. P. Smith. Compilation supervised by F. P. Gilbert

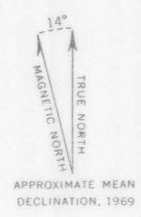

EXPLANATION



Magnetic contours
Showing total intensity magnetic field of the earth in gammas relative to arbitrary datum. Hatched to indicate closed areas of lower magnetic intensity. Contour interval 20 gammas

Location of measured maximum or minimum intensity within closed high or closed low

Flight path
Showing location and spacing of data

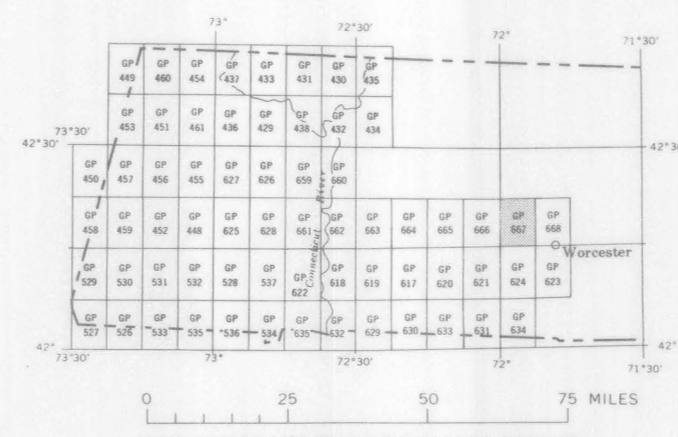
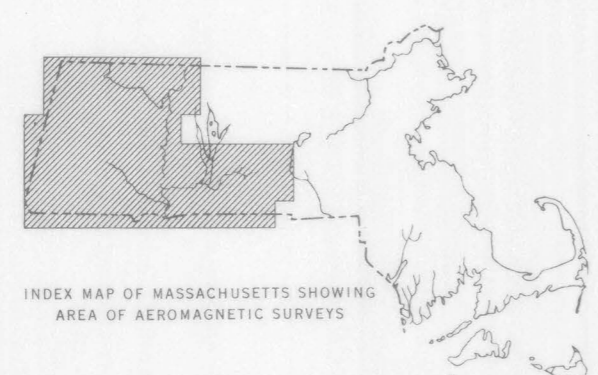

AEROMAGNETIC MAP OF THE PAXTON QUADRANGLE, WORCESTER COUNTY, MASSACHUSETTS