

EXPLANATION

- | | |
|--|---|
| <p>TERTIARY</p> <p>Bostonite and bostonite porphyry</p> <p>Granite pegmatite</p> <p>Granite gneiss
<i>Includes lenticular layers of biotite-quartz, plagioclase gneiss, quartz-biotite schist, and amphibolite.</i></p> <p>Cordierite-anthophyllite-garnet gneiss</p> <p>CONTACT</p> <p>Inferred contact</p> <p>Fault, dashed where approximately located</p> <p>Plunge of small fold axes</p> <p>Plunge of chevron folds</p> <p>Generalized strike of warped foliation, showing plunge of warps</p> <p>Strike and dip of foliation</p> <p>Strike and dip of primary flow layers</p> | <p>PRE-CAMBRIAN</p> <p>Vertical shaft</p> <p>Inclined shaft</p> <p>Trench</p> <p>Pit or caved workings at surface</p> <p>Rock dump</p> <p>Prospect pit</p> <p>Metalliferous vein, showing dip
Dashed where inferred</p> <p>TERTIARY</p> |
|--|---|

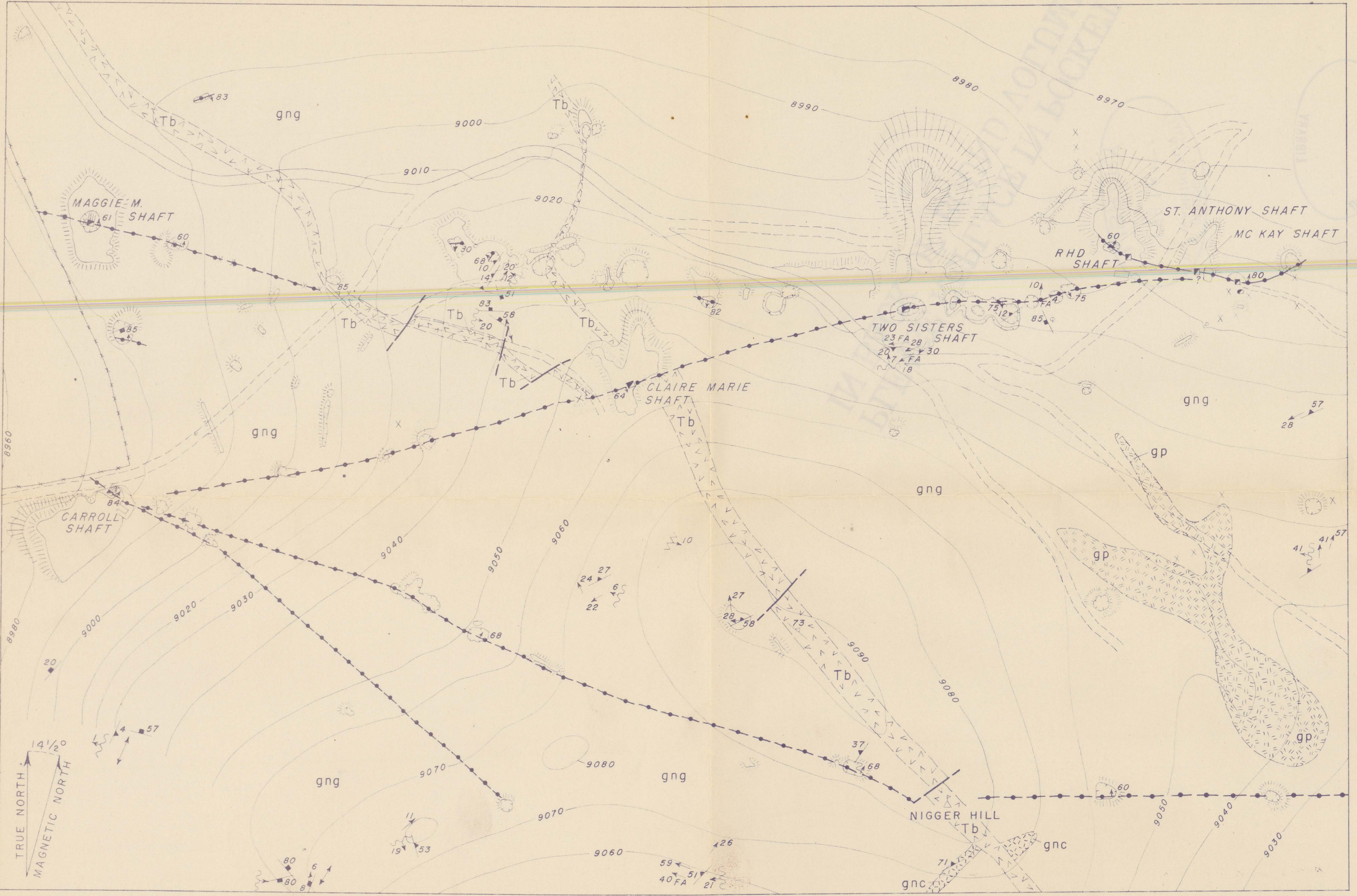

Topography by A.E. Dearth and R.H. Campbell

Geology by F.W. Osterwald, 1953

FIGURE 3. - GEOLOGIC MAP OF THE NORTH SLOPE OF NIGGER HILL, CENTRAL CITY DISTRICT, GILPIN COUNTY, COLORADO

100 0 100 Feet
Contour interval 10 feet
Datum is approximate mean sea level.

U. S. Geological Survey
OPEN FILE REPORT
This map or illustration is preliminary and has not been edited or reviewed for conformity with Geological Survey standards or nomenclature.