

PROFILES NOT ADJUSTED TO COMMON DATUM

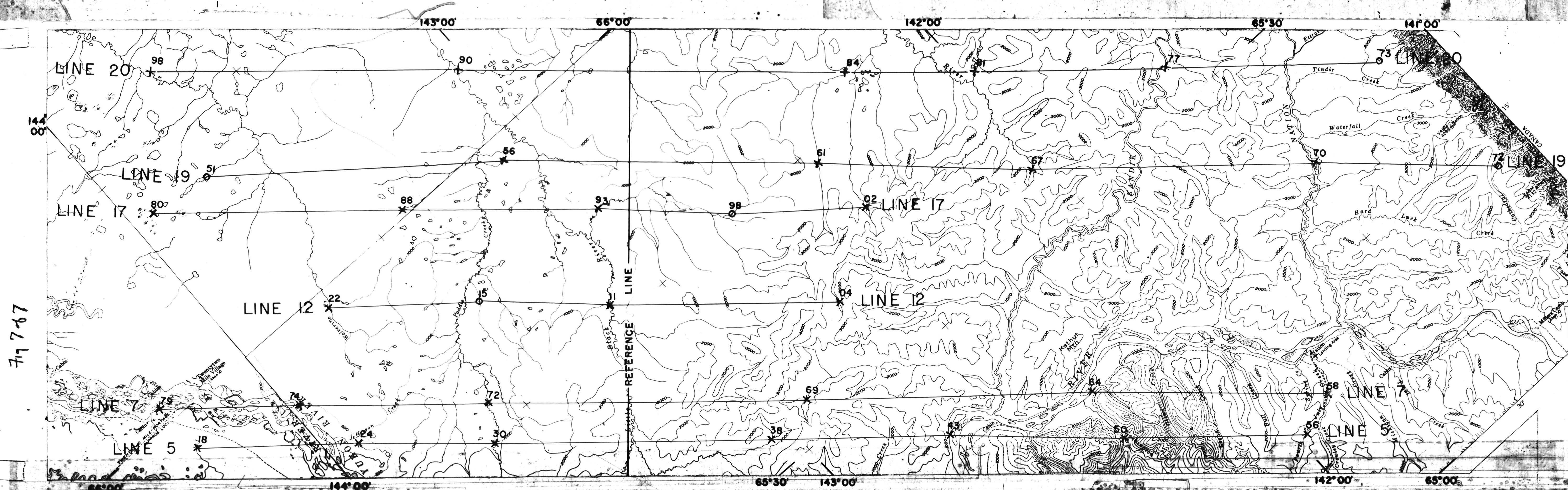

SURVEY BY G. E. ANDREASEN, LINES 5, 7, 12, AND 17 FLOWN AT A BAROMETRIC ELEVATION OF 4500 FEET, 1955. LINES 19 AND 20 FLOWN AT A BAROMETRIC ELEVATION OF 4000 FEET, 1958

FLIGHTS 5, 7, 12, 17, 19, AND 20

SCALE 1:250 000



1960

202

This map is preliminary and has not been edited or reviewed for conformity to Geological Survey standards and nomenclature.

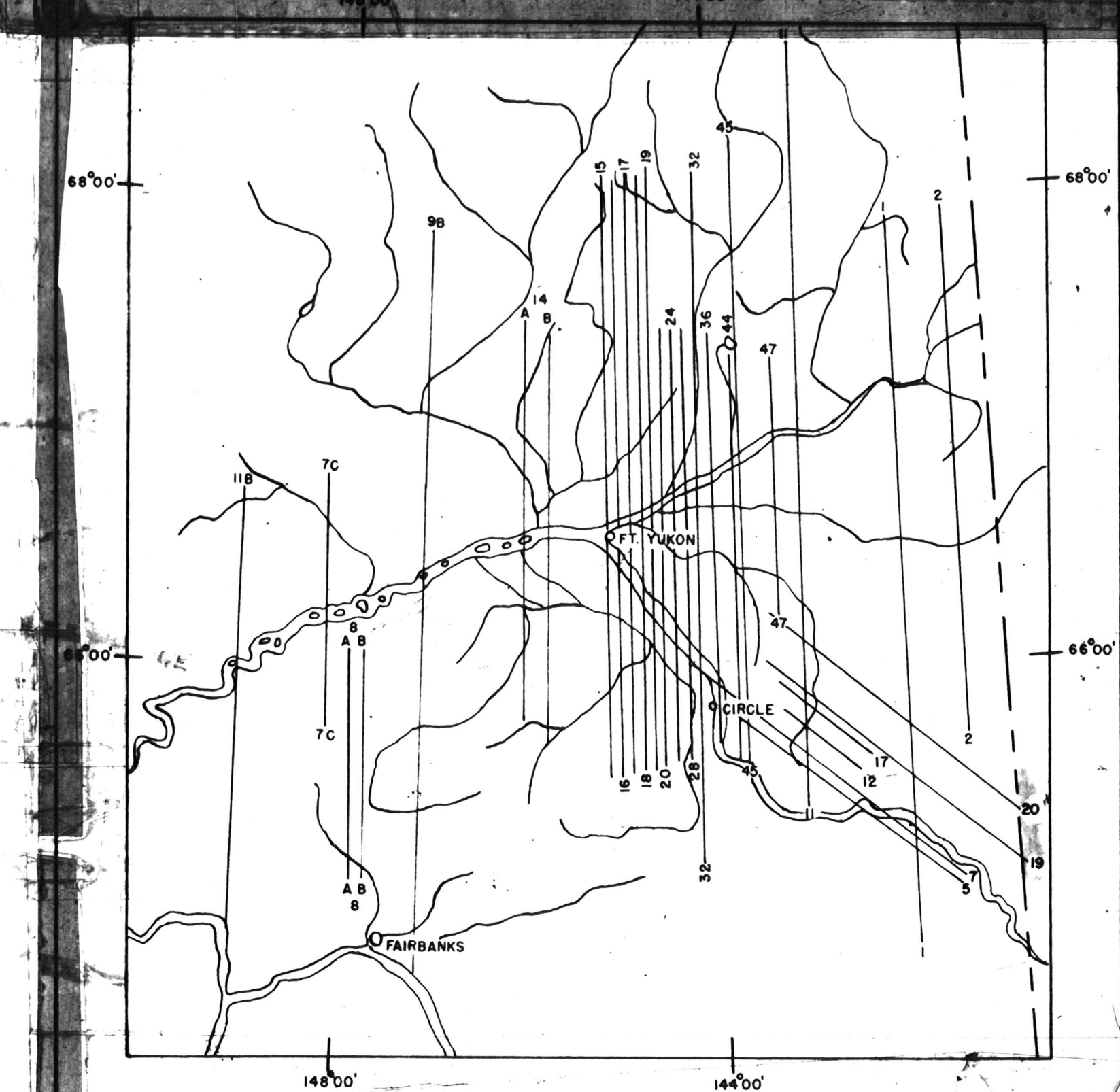

INDEX MAP SHOWING FLIGHT TRAVERSES