

CLAIM INDEX
EXPLANATION

Mining claim, millsite, or agricultural land, patented or surveyed for patent, plotted from surveyed plats.

Mining claim or millsite, unpatented, plotted from fairly reliable information, but subject to correction.

Mining claim, unpatented, plotted from information of doubtful reliability and subject to correction.

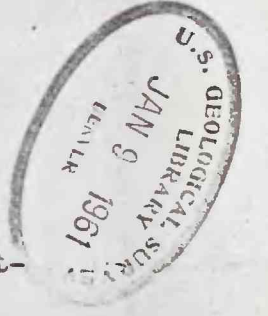

LIST OF CLAIMS

- | | | |
|-----------------------|--------------------------|---------------------|
| 1 Raymond | 101 Hidden Basin No.3 | 201 Saturn |
| 2 Ranch View | 102 Hidden Basin No.4 | 202 Vega |
| 3 Antelope | 103 Hot Box No.1 | 203 Sirius |
| 4 Salt Lake Extension | 104 Hot Box No.2 | 204 Lucky Boy |
| 5 Raven | 105 Hot Box No.3 | 205 Twenty Grand |
| 6 Rainy Day | 106 Hot Box No.4 | 206 Avalon |
| 7 Little Johnnie | 107 Hot Box No.5 | 207 Camel |
| 8 B & M | 108 W. H. P. | 208 Ball Point |
| 9 Commodore | 109 Flagstaff | 209 Ball Point No.1 |
| 10 Yellow Jacket | 110 T. N. T. No.1 | 210 Ball Point No.2 |
| 11 Kaiser | 111 T. N. T. No.2 | 211 Ball Point No.3 |
| 12 J. M. | 112 T. N. T. No.3 | 212 Ball Point No.4 |
| 13 Rambler | 113 T. N. T. No.4 | 213 Ball Point No.5 |
| 14 Beta | 114 T. N. T. No.5 | 214 Ball Point No.6 |
| 15 Beta Fonder | 115 T. N. T. No.6 | 215 Ball Point No.7 |
| 16 R. A. H. | 116 T. N. T. No.7 | 216 Ball Point No.8 |
| 17 Joe Junior | 117 T. N. T. No.8 | 217 Ball Point No.9 |
| 18 Mill 1 | 118 T. N. T. No.9 | 218 Sage No.19 |
| 19 Elk | 119 T. N. T. No.10 | 219 Sage No.20 |
| 20 Beaver | 120 King of Lodes | 220 Sage No.21 |
| 21 Mill No.5 | 121 Elva S. | 221 Sage No.23 |
| 22 Mill No.2 | 122 Nuisance | 222 Sage No.25 |
| 23 Surprise No.1 | 123 Tripod | 223 Steer No.1 |
| 24 Surprise | 124 Great Western | 224 Steer No.2 |
| 25 Mill No.4 | 125 Helen C. | 225 Steer No.3 |
| 26 Mill No.3 | 126 Phonograph | 226 Steer No.4 |
| 27 Telluride | 127 Moonbeam | 227 Steer No.5 |
| 28 Chemist No.2 | 128 Bernard | 228 Steer No.6 |
| 29 Chemist | 129 Valentine | 229 Steer No.7 |
| 30 Bird Shot | 130 Sun Flower | 230 Steer No.8 |
| 31 Buck Shot | 131 Florence-Hellie | 231 Steer No.9 |
| 32 Half Shot | 132 Honeymoon | 232 Steer No.10 |
| 33 Sure Shot | 133 Baggar | 233 Steer No.11 |
| 34 Big Shot | 134 Valley View | 234 Steer No.12 |
| 35 Tramp No.4 | 135 North Star | 235 Steer No.13 |
| 36 Tramp No.1 | 136 Paradox Bell | 236 Steer No.14 |
| 37 Cliff No.1 | 137 Sitting Bull | 237 Steer No.15 |
| 38 Cliff No.2 | 138 Tuxedo | 238 Steer No.16 |
| 39 Tramp No.2 | 139 Doc Willes | 239 Steer No.17 |
| 40 Cliff No.1 M. S. | 140 Bliss | 240 Steer No.18 |
| 41 Cliff No.2 M. S. | 141 Cloud Burst | 241 Steer No.19 |
| 42 Tramp No.3 | 142 Sphinx | |
| 43 Old Taylor | 143 St. Patrick | |
| 44 Old Hickory | 144 Dusty | |
| 45 U. S. Grant | 145 Republican | |
| 46 Wm. McKinley | 146 Colorado | |
| 47 John Adams | 147 Henry Clay | |
| 48 Jack Rabbit | 148 Uranite | |
| 49 Lucky Trail | 149 Nucla | |
| 50 Lucky Elunder No.1 | 150 Bismark | |
| 51 Lucky Elunder | 151 Maggie C. Mill Site | |
| 52 Two Shoel | 152 Gray Bar | |
| 53 Alma | 153 Swindler | |
| 54 Marion | 154 Wamader | |
| 55 Black Bass | 155 Mucker | |
| 56 Lucky Strike | 156 Production | |
| 57 Gray Horse | 157 Happy | |
| 58 Black Bass No.2 | 158 Coloradium | |
| 59 Zebra | 159 Maggie C. | |
| 60 Monitor | 160 Correct | |
| 61 Ho O He | 161 Cripple Creek | |
| 62 May Bell No.1 | 162 Cripple Creek No.2 | |
| 63 May Bell No.2 | 163 Fay | |
| 64 Native American | 164 Pay Off | |
| 65 Wheel of Fortune | 165 Donald C. | |
| 66 Williams | 166 Arrowhead | |
| 67 Little Daisy | 167 A. S. W. | |
| 68 Chrysanthemum | 168 First National Bank | |
| 69 Carpathia | 169 Second National Bank | |
| 70 Petunia | 170 Third National Bank | |
| 71 Mary Gold | 171 Fourth National Bank | |
| 72 Tuesday No.9 | 172 Fifth National Bank | |
| 73 Peg Leg No.2 | 173 Elack Diamond | |
| 74 Valentine | 174 Saturday | |
| 75 Badger No.3 | 175 Friday | |
| 76 Badger No.2 | 176 Velvet | |
| 77 Badger No.1 | 177 Jerome | |
| 78 La Porte | 178 Long Park No.2 | |
| 79 Bob Cat | 179 Long Park No.4 | |
| 80 Carnotite | 180 Long Park No.3 | |
| 81 Inspiration | 181 Long Park No.7 | |
| 82 Rosebud | 182 Long Park No.8 | |
| 83 Recreation | 183 Sunny Jim | |
| 84 Timon's Feast | 184 View of the Valley | |
| 85 Gnome | 185 Banner | |
| 86 Dorothy | 186 Bull Moose | |
| 87 Farker | 187 Bat | |
| 88 C. F. C. | 188 Little Dot | |
| 89 Ground Hog | 189 Tango | |
| 90 Fire Bird | 190 Golden Touch | |
| 91 Blue Clay No.1 | 191 Buddha | |
| 92 Blue Clay No.2 | 192 Congress | |
| 93 Blue Clay No.3 | 193 Pall Mall | |
| 94 Blue Clay No.4 | 194 Ouster | |
| 95 Blue Clay No.5 | 195 Bull Durham | |
| 96 Blue Clay No.6 | 196 Phillip Morris | |
| 97 Dew Drop | 197 Trojan | |
| 98 Corporation | 198 Jupiter | |
| 99 Hidden Basin No.1 | 199 Mercury | |
| 100 Hidden Basin No.2 | 200 Pluto | |

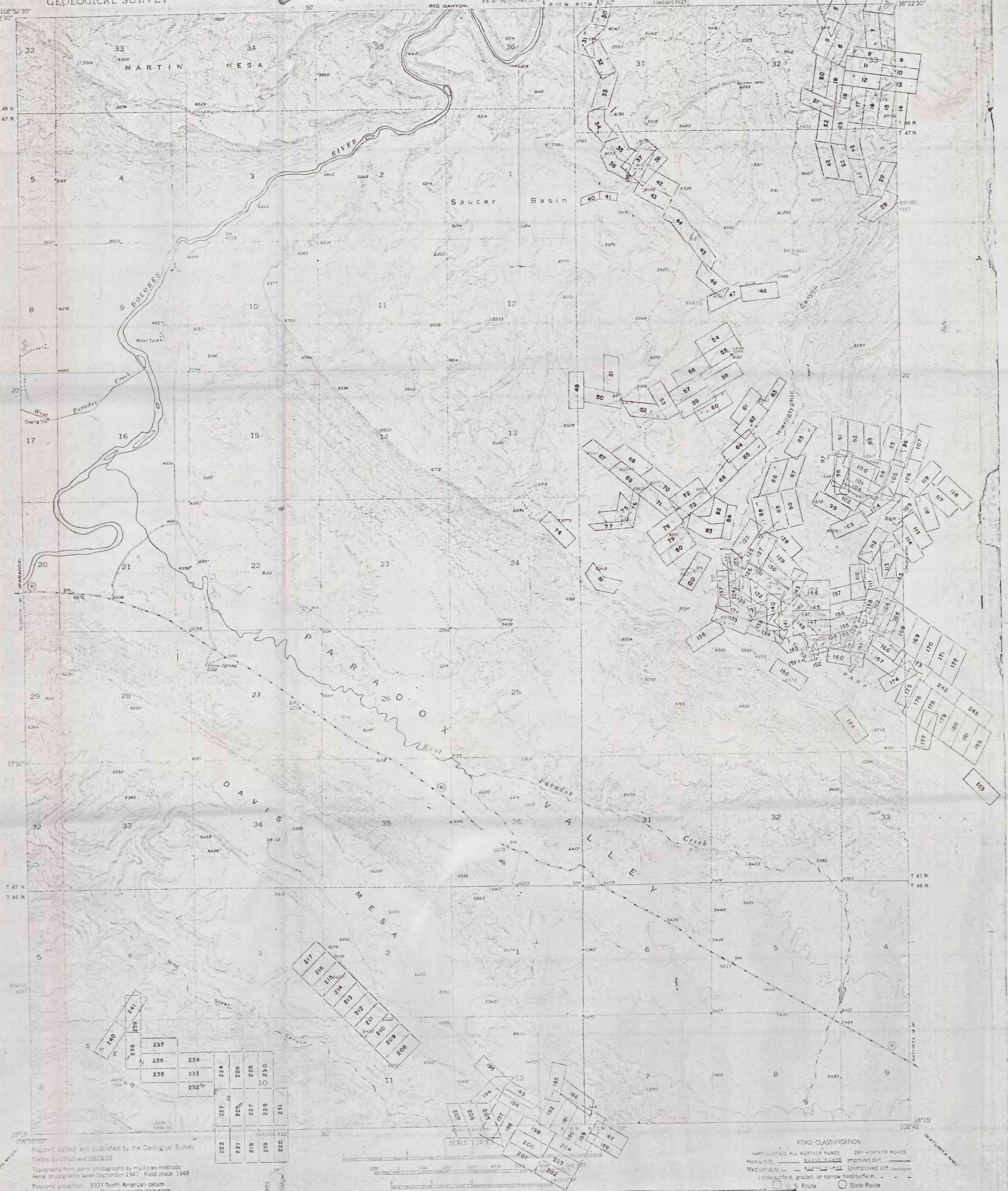

Map: edited and published by the Geological Survey
Control by USGS and USCGS
Topography from aerial photographs by mosaic methods
Aerial photographs taken September 1947. Field check 1948
Polyconic projection. 1927 North American datum
10,000-foot grid based on Colorado coordinate system,
60627 zone
Dashed line shows approximate location
of land area shown as part of T. 47 N., R. 17 W.
because of insufficient data
APPROXIMATE MEAN
DECLINATION, 1948

TOPOGRAPHIC BASE COMPLIES WITH NATIONAL MAP ACCURACY STANDARDS
CLAIM INFORMATION COMPILED BY R.D. SAMPLE AND H.F. ALBEE
JULY 1951

ROAD CLASSIFICATION
HEAVY SURFACE ALL WEATHER ROADS
MEDIUM SURFACE ALL WEATHER ROADS
LIGHT SURFACE ALL WEATHER ROADS
IMPROVED DIRT
UNIMPROVED DIRT
LONE SURFACE, GRADE, OR NARROW HANDSURFACE
U. S. ROUTE
STATE ROUTE

DAVIS MESA, COLO.
N3815-W10645/75
EDITION OF 1948

THE GEOLOGICAL SURVEY MAKES NO WARRANTY AS TO THE
ACCURACY OR COMPLETENESS OF THE INFORMATION ABOUT
CLAIMS SHOWN ON THIS MAP AND ASSUMES NO LIABILITY
WITH RESPECT TO THE USE OF THIS INFORMATION.

This map is preliminary and has not
been edited for conformity with Geological
Survey format and nomenclature