

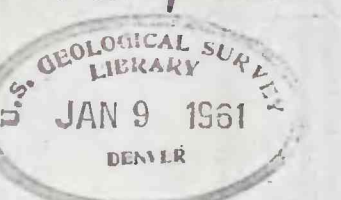

(200)
T67ms
no. 462

61-139

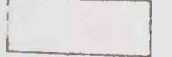
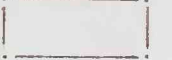

CLAIM INDEX

EXPLANATION

-  Mining claim, millsite, or agricultural land, patented or surveyed for patent, plotted from surveyed plats. *1/*
-  Mining claim or millsite, unpatented, plotted from fairly reliable information, but subject to correction.
-  Mining claim, unpatented, plotted from information of doubtful reliability and subject to correction.

LIST OF CLAIMS

- 1 Larry No. 15
- 2 Larry No. 14
- 3 Larry No. 11
- 4 Larry No. 10
- 5 Larry No. 18
- 6 Larry No. 17
- 7 Cave No. 2
- 8 Cave
- 9 Pale Face
- 10 Sandy Dunn
- 11 Dirty Devil
- 12 Pay Day
- 13 Lucky Day
- 14 White Swan
- 15 Snow Drift
- 16 Rosebud
- 17 Liberty Bell No. 1
- 18 Liberty Bell No. 2
- 19 Chico
- 20 Lincoln
- 21 Hamoth
- 22 Salida
- 23 Homestead
- 24 Fountain of Youth
- 25 Little Johnnie
- 26 Roulette No. 1
- 27 Roulette No. 2
- 28 Roulette No. 3
- 29 Roulette No. 4
- 30 Roulette No. 5
- 31 Pay Rock No. 14
- 32 Pay Rock No. 16
- 33 Pay Rock No. 4
- 34 Pay Rock No. 11
- 35 Pay Rock No. 3
- 36 Pay Rock No. 10
- 37 Pay Rock No. 5
- 38 Pay Rock No. 1
- 39 Pay Rock No. 15
- 40 Pay Rock No. 7
- 41 Pay Rock No. 17
- 42 Pay Rock No. 12
- 43 Pay Rock No. 6
- 44 Pay Rock No. 13
- 45 Pay Rock No. 2
- 46 Pay Rock No. 9
- 47 Pay Rock No. 8
- 48 Vansking No. 1
- 49 Vansking No. 2
- 50 Nipper Baby
- 51 Black Mamma
- 52 Harvey No. 2
- 53 Harvey No. 1
- 54 Nellie
- 55 Lucky Day
- 56 Becky
- 57 Nancy
- 58 Cactus Kate
- 59 Yellow Bird
- 60 White Heather
- 61 Maverick No. 25
- 62 Maverick No. 24
- 63 Opportunity
- 64 Fiery Opal
- 65 Nina
- 66 Lark
- 67 Maverick No. 23
- 68 Hanford
- 69 Maverick No. 17
- 70 Maverick No. 18
- 71 Maverick No. 19
- 72 Maverick No. 20
- 73 Maverick No. 21
- 74 Maverick No. 22
- 75 Maverick No. 26
- 76 Maverick No. 27
- 77 Maverick No. 28
- 78 Sunflower
- 79 Maverick No. 29

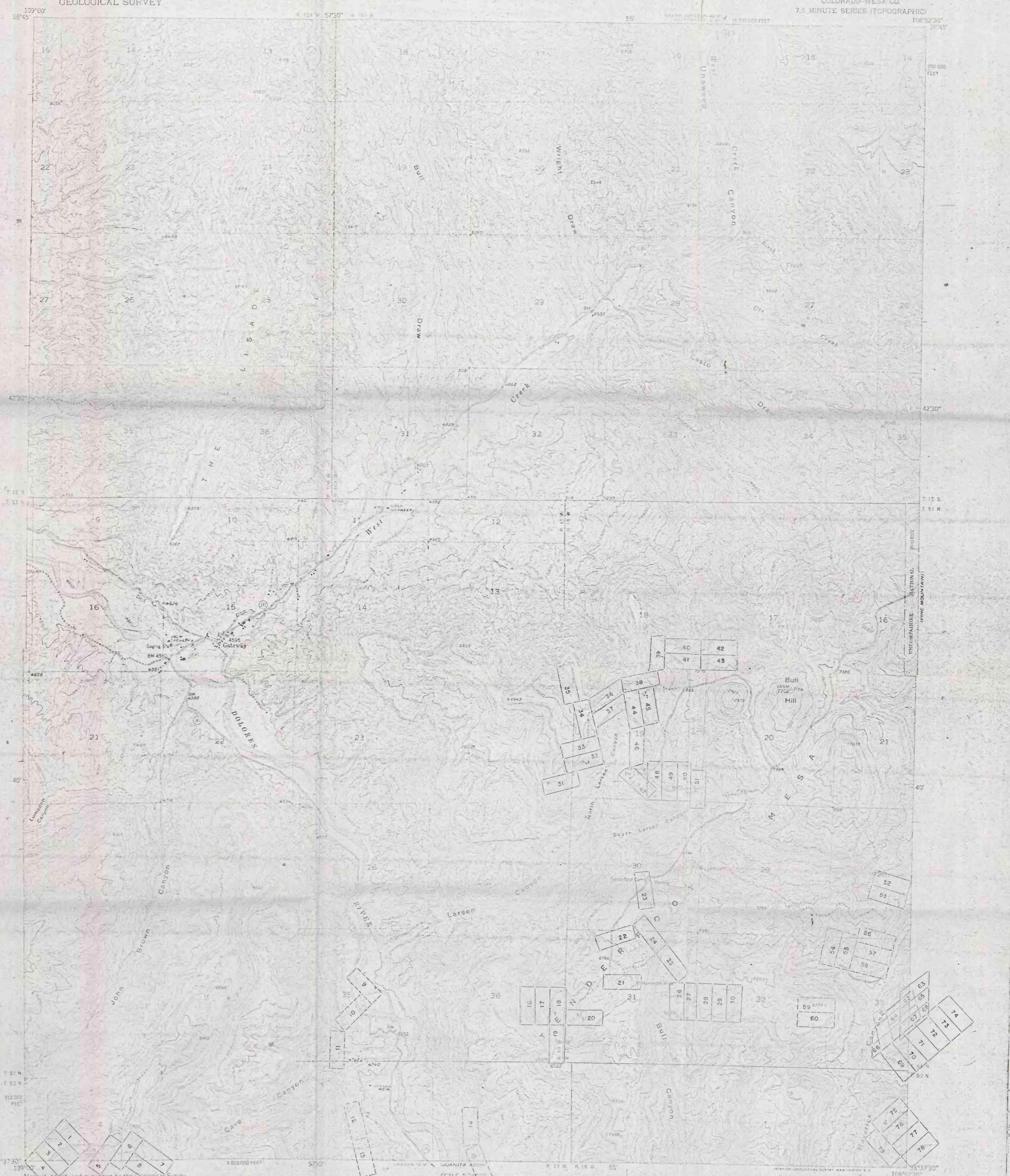

Map made, edited, and published by the Geological Survey
Control by USGS and USCGS
Topography from aerial photographs by multiple method
Aerial photographs taken September 1957. Field check 1958
Boundary projection - 1927 North American datum
1:600-foot grid based on Cassini's chordate system
central zone
Contour lines indicate approximate location
Land lines surveyed in part of T. 50 N. R. 18 W.
T. 50 N. R. 19 W. T. 51 N. R. 18 W. and T. 51 N. R. 19 W.
T. 16 S. original of the Cassini's chordate system
T. 51 N. original of the New Mexico datum

SCALE 1:250,000
CONTOUR INTERVAL 20 FEET
TOPOGRAPHIC BASE COMPLIES WITH NATIONAL MAP ACCURACY STANDARDS
CLAIM INFORMATION COMPILED BY R. D. SAMPLE AND H. F. ALBEE

ROAD CLASSIFICATION
Heavy Duty
Medium Duty
Light Duty
Unimproved and
U.S. Route
State Route
GATEWAY, COLO.
N 837.5-W 10652.5/77.5
SECTION OF 1463

1/ Land patented as agricultural land or placer claim, and which is some distance from known carbonate deposits, is not shown.

THE GEOLOGICAL SURVEY MAKES NO WARRANTY AS TO THE ACCURACY OR COMPLETENESS OF THE INFORMATION ABOUT CLAIMS SHOWN ON THIS MAP AND ASSUMES NO LIABILITY WITH RESPECT TO THE USE OF THIS INFORMATION.

This map is preliminary and has not been edited or reviewed for conformity with U. S. Geological Survey standards and nomenclature.