

(200)
T67/Am
no. 457

U.S. GEOLOGICAL SURVEY
LIBRARY
JAN 9 1962
DENVER
RECEIVED
MAR 18 1953
TEPCO

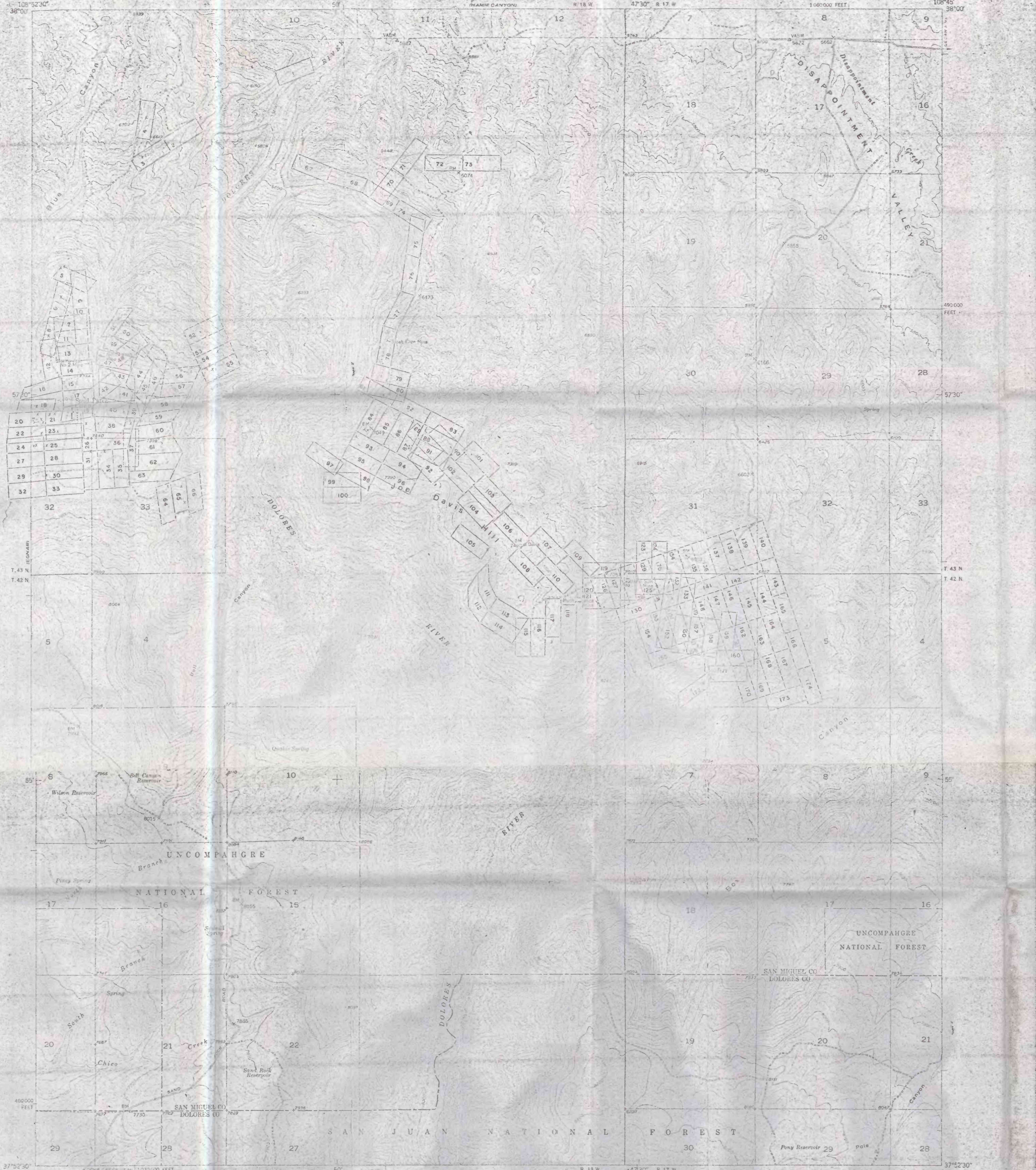

CLAIM INDEX 1/

EXPLANATION

Mining claim or millsite, unpatented, plotted from fairly reliable information, but subject to correction.

Mining claim, unpatented, plotted from information of doubtful reliability and subject to correction.

LIST OF CLAIMS

- | | | | |
|-----|---------------------|-----|-------------------|
| 1 | Rosa L. | 101 | Dolores No. 9 |
| 2 | Spur | 102 | Dolores No. 8 |
| 3 | Wonder | 103 | Dolores No. 7 |
| 4 | Full Moon No. 7 | 104 | Dolores No. 6 |
| 5 | Spalding | 105 | Bumming Bird |
| 6 | Mountain View No. 4 | 106 | Dolores No. 5 |
| 7 | Shalbina | 107 | Dolores No. 3 |
| 8 | Mountain View No. 3 | 108 | Dolores No. 2 |
| 9 | Key | 109 | Dolores No. 4 |
| 10 | Ruby May | 110 | Dolores No. 1 |
| 11 | Midnight | 111 | J. Broyles No. 2 |
| 12 | Norma | 112 | F. Broyles |
| 13 | Thunderbolt | 113 | Rim No. 2 |
| 14 | Norma Jean | 114 | Rim |
| 15 | Big Chief | 115 | Lone Star No. 1 |
| 16 | Basin | 116 | Lone Star No. 2 |
| 17 | Clipper | 117 | Canary Bird |
| 18 | Hobbs | 118 | Canary Bird No. 2 |
| 19 | Brigham | 119 | Flip No. 2 |
| 20 | Meadley | 120 | Flip |
| 21 | Mott | 121 | Mucho Grande |
| 22 | Carlsbad | 122 | Mohawk |
| 23 | Champion | 123 | Red Top |
| 24 | Sarvis No. 2 | 124 | Bull Frog |
| 25 | Sarvis | 125 | Uncle Sam |
| 26 | Marne No. 4 | 126 | M. & E. No. 1 |
| 27 | Sarvis No. 3 | 127 | M. & E. No. 2 |
| 28 | Sarvis No. 4 | 128 | M. & E. No. 3 |
| 29 | Sarvis No. 6 | 129 | M. & E. No. 4 |
| 30 | Sarvis No. 5 | 130 | M. & E. No. 13 |
| 31 | Marne | 131 | M. & E. No. 14 |
| 32 | Sarvis No. 7 | 132 | Horse Shoe No. 1 |
| 33 | Sarvis No. 8 | 133 | Horse Shoe No. 2 |
| 34 | Marne No. 2 | 134 | M. & E. No. 6 |
| 35 | Marne No. 3 | 135 | M. & E. No. 7 |
| 36 | Betty Ruth | 136 | M. & E. No. 8 |
| 37 | Snowfall | 137 | M. & E. No. 9 |
| 38 | Ring Cone | 138 | M. & E. No. 10 |
| 39 | Riverview No. 3 | 139 | M. & E. No. 11 |
| 40 | Hillside | 140 | M. & E. No. 12 |
| 41 | Moqui | 141 | M. & E. No. 15 |
| 42 | Tail Holt | 142 | M. & E. No. 16 |
| 43 | Little Max | 143 | M. & E. No. 17 |
| 44 | Egnar No. 2 | 144 | M. & E. No. 18 |
| 45 | Egnar No. 1 | 145 | M. & E. No. 19 |
| 46 | Egnar No. 4 | 146 | M. & E. No. 20 |
| 47 | Norma Jean | 147 | M. & E. No. 21 |
| 48 | Sundown | 148 | M. & E. No. 22 |
| 49 | Skyline | 149 | M. & E. No. 23 |
| 50 | Egnar No. 3 | 150 | Horse Shoe No. 4 |
| 51 | Water Trail | 151 | M. & E. No. 24 |
| 52 | Little Roy | 152 | Horse Shoe No. 5 |
| 53 | Elouise | 153 | M. & E. No. 25 |
| 54 | Curtis | 154 | M. & E. No. 26 |
| 55 | Gertrude | 155 | M. & E. No. 27 |
| 56 | Yellow Jacket | 156 | M. & E. No. 28 |
| 57 | Midget | 157 | Horse Shoe No. 5 |
| 58 | Jumbo | 158 | Horse Shoe No. 8 |
| 59 | Riverview | 159 | Horse Shoe No. 9 |
| 60 | Bullhoser | 160 | Horse Shoe No. 6 |
| 61 | Wassal | 161 | M. & E. No. 29 |
| 62 | Ferdinand | 162 | M. & E. No. 30 |
| 63 | Dolores | 163 | M. & E. No. 31 |
| 64 | Windsor | 164 | M. & E. No. 32 |
| 65 | Belmont | 165 | M. & E. No. 33 |
| 66 | Clifton | 166 | M. & E. No. 34 |
| 67 | Mule Shoe No. 1 | 167 | M. & E. No. 35 |
| 68 | Mule Shoe No. 6 | 168 | M. & E. No. 36 |
| 69 | Mule Shoe No. 5 | 169 | M. & E. No. 37 |
| 70 | Clover Patch | 170 | M. & E. No. 38 |
| 71 | Clover Patch No. 2 | 171 | Horse Shoe No. 7 |
| 72 | Little Faun | 172 | Clear View No. 1 |
| 73 | Little Faun No. 1 | 173 | M. & E. No. 40 |
| 74 | Mule Shoe No. 4 | 174 | M. & E. No. 59 |
| 75 | Mule Shoe No. 2 | 175 | M. & E. No. 5 |
| 76 | Mule Shoe No. 3 | | |
| 77 | Sarah Ellen No. 2 | | |
| 78 | Sarah Ellen | | |
| 79 | Lystery | | |
| 80 | Sarah M. | | |
| 81 | Parrot No. 9 | | |
| 82 | Parrot No. 10 | | |
| 83 | Parrot No. 11 | | |
| 84 | Parrot No. 2 | | |
| 85 | Parrot No. 3 | | |
| 86 | Parrot No. 7 | | |
| 87 | Parrot No. 8 | | |
| 88 | Dolores No. 10 | | |
| 89 | Parrot No. 12 | | |
| 90 | Dolores No. 12 | | |
| 91 | Parrot No. 13 | | |
| 92 | Dolores No. 11 | | |
| 93 | Parrot No. 1 | | |
| 94 | Parrot No. 4 | | |
| 95 | Parrot No. 5 | | |
| 96 | Red Rock No. 3 | | |
| 97 | Buckhorn | | |
| 98 | Parrot No. 14 | | |
| 99 | Roy Lee | | |
| 100 | Parrot No. 6 | | |

1/ Land patented as agricultural land or placer claim, and which is some distance from known carnotite deposits, is not shown.

THE GEOLOGICAL SURVEY MAKES NO WARRANTY AS TO THE ACCURACY OR COMPLETENESS OF THE INFORMATION ABOUT CLAIMS SHOWN ON THIS MAP AND ASSUMES NO LIABILITY WITH RESPECT TO THE USE OF THIS INFORMATION.

This map is preliminary and has not been edited or reviewed for conformity with U. S. Geological Survey standards and nomenclature.

Maped, edited, and published by the Geological Survey
Control by USGS and USC&GS
Topography from aerial photographs by multiple methods
Aerial photographs taken September 1947. Field check 1949
Polyconic projection. 1927 North American datum
10,000-foot grid based on Colorado coordinate system,
south zone
Dashed land lines indicate approximate location
Land has been surveyed in part of T. 43 N., R. 18 W.
and T. 42 N., R. 18 W.
Unchecked elevations are shown in brown
APPROXIMATE MEAN
OF LINATION, 1949

SCALE 1:24,000
CONTOUR INTERVAL 20 FEET
EALUM IS MEAN SEA LEVEL
TOPOGRAPHIC BASE COMPLIES WITH NATIONAL MAP ACCURACY STANDARDS
CLAIM INFORMATION COMPILED BY R. D. SAMPLE AND H. F. ALBEE

ROAD CLASSIFICATION
HEAVY SURFACE ALL WEATHER ROADS DRY WEATHER ROADS
Heavy duty Improved dirt
Medium duty Unimproved dirt
Loose surface, graded, or narrow hard-surface
U. S. Route State Route
JOE DAVIS HILL, COLO.
N3752.5-W10645.7
EDITION OF 1950