

(200)
T67/cm
no. 457

61-143
RECEIVED
JAN 9 1961
MAR 1 8 1953
TAPCO

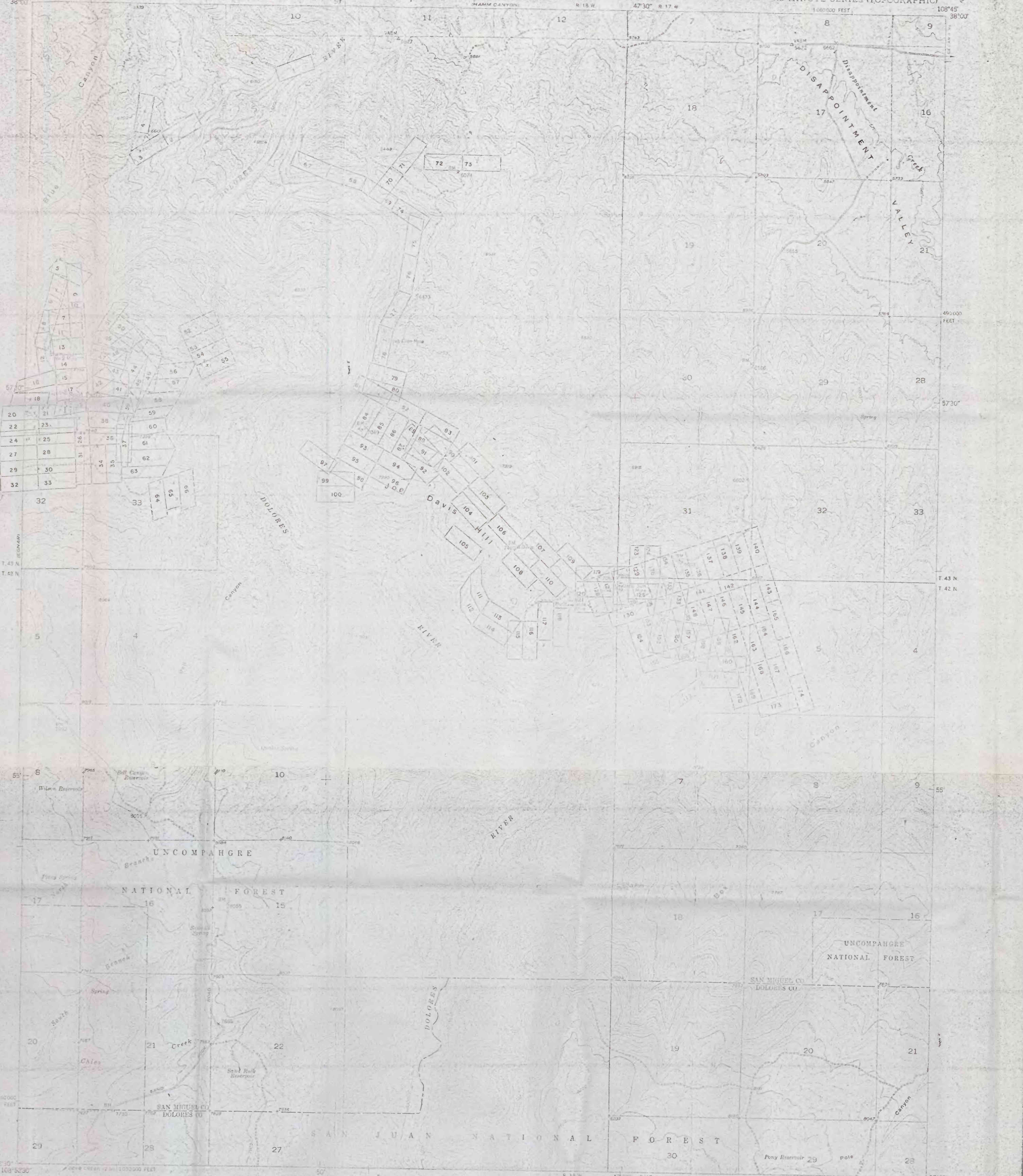

CLAIM INDEX 1/

EXPLANATION

Mining claim or millsite, unpatented, plotted from fairly reliable information, but subject to correction.

Mining claim, unpatented, plotted from information of doubtful reliability and subject to correction.

LIST OF CLAIMS

- | | |
|-----------------------|-----------------------|
| 1 Rosa L. | 101 Dolores No. 9 |
| 2 Spur | 102 Dolores No. 8 |
| 3 Wonder | 103 Dolores No. 7 |
| 4 Full Moon No. 7 | 104 Dolores No. 6 |
| 5 Spelling | 105 Humming Bird |
| 6 Mountain View No. 4 | 106 Dolores No. 5 |
| 7 Shalbina | 107 Dolores No. 3 |
| 8 Mountain View No. 3 | 108 Dolores No. 2 |
| 9 Key | 109 Dolores No. 4 |
| 10 Ruby May | 110 Dolores No. 1 |
| 11 Midnight | 111 J. Broyles No. 2 |
| 12 Norma | 112 F. Broyles |
| 13 Thunderbolt | 113 Rim No. 2 |
| 14 Norma Jean | 114 Rim |
| 15 Big Chief | 115 Lone Star No. 1 |
| 16 Basin | 116 Lone Star No. 2 |
| 17 Clipper | 117 Canary Bird |
| 18 Hobbs | 118 Canary Bird No. 2 |
| 19 Brigham | 119 Flip No. 2 |
| 20 Mayday | 120 Flip |
| 21 Mott | 121 Mucho Grande |
| 22 Carlsbad | 122 Mohawk |
| 23 Champion | 123 Red Top |
| 24 Sarvis No. 2 | 124 Bull Frog |
| 25 Sarvis | 125 Uncle Sam |
| 26 Harne No. 4 | 126 M. & E. No. 1 |
| 27 Sarvis No. 3 | 127 M. & E. No. 2 |
| 28 Sarvis No. 4 | 128 M. & E. No. 3 |
| 29 Sarvis No. 6 | 129 M. & E. No. 4 |
| 30 Sarvis No. 5 | 130 M. & E. No. 15 |
| 31 Harne | 131 M. & E. No. 14 |
| 32 Sarvis No. 7 | 132 Horse Shoe No. 1 |
| 33 Sarvis No. 8 | 133 Horse Shoe No. 2 |
| 34 Harne No. 2 | 134 M. & E. No. 6 |
| 35 Harne No. 3 | 135 M. & E. No. 7 |
| 36 Betty Ruth | 136 M. & E. No. 8 |
| 37 Snowfall | 137 M. & E. No. 9 |
| 38 Ring Cone | 138 M. & E. No. 10 |
| 39 Riverview No. 5 | 139 M. & E. No. 11 |
| 40 Hillside | 140 M. & E. No. 12 |
| 41 Moqui | 141 M. & E. No. 15 |
| 42 Tail Holt | 142 M. & E. No. 16 |
| 43 Little Max | 143 M. & E. No. 17 |
| 44 Eggar No. 2 | 144 M. & E. No. 18 |
| 45 Eggar No. 4 | 145 M. & E. No. 19 |
| 47 Norma Jean | 146 M. & E. No. 20 |
| 48 Sundown | 147 M. & E. No. 21 |
| 49 Skyline | 148 M. & E. No. 22 |
| 50 Eggar No. 3 | 149 M. & E. No. 23 |
| 51 Water Trail | 150 Horse Shoe No. 4 |
| 52 Little Roy | 151 M. & E. No. 24 |
| 53 Blouise | 152 Horse Shoe No. 3 |
| 54 Curtis | 153 M. & E. No. 25 |
| 55 Cortrude | 154 M. & E. No. 26 |
| 56 Yellow Jacket | 155 M. & E. No. 27 |
| 57 Midget | 156 M. & E. No. 28 |
| 58 Jumbo | 157 Horse Shoe No. 5 |
| 59 Riverview | 158 Horse Shoe No. 8 |
| 60 Bulldozer | 159 Horse Shoe No. 9 |
| 61 Wenzel | 160 Horse Shoe No. 6 |
| 62 Ferdinand | 161 M. & E. No. 29 |
| 63 Dolores | 162 M. & E. No. 30 |
| 64 Windsor | 163 M. & E. No. 31 |
| 65 Belmont | 164 M. & E. No. 32 |
| 66 Clifton | 165 M. & E. No. 33 |
| 67 Mule Shoe No. 1 | 166 M. & E. No. 34 |
| 68 Mule Shoe No. 6 | 167 M. & E. No. 35 |
| 69 Mule Shoe No. 5 | 168 M. & E. No. 36 |
| 70 Clover Patch | 169 M. & E. No. 37 |
| 71 Clover Patch No. 2 | 170 M. & E. No. 38 |
| 72 Little Faun | 171 Horse Shoe No. 7 |
| 73 Little Faun No. 1 | 172 Clear View No. 1 |
| 74 Mule Shoe No. 4 | 173 M. & E. No. 40 |
| 75 Mule Shoe No. 2 | 174 M. & E. No. 39 |
| 76 Mule Shoe No. 3 | 175 M. & E. No. 5 |
| 77 Sarah Ellen No. 2 | |
| 78 Sarah Ellen | |
| 79 Mystery | |
| 80 Sarah M. | |
| 81 Parrot No. 9 | |
| 82 Parrot No. 10 | |
| 83 Parrot No. 11 | |
| 84 Parrot No. 2 | |
| 85 Parrot No. 3 | |
| 86 Parrot No. 7 | |
| 87 Parrot No. 8 | |
| 88 Dolores No. 10 | |
| 89 Parrot No. 12 | |
| 90 Dolores No. 12 | |
| 91 Parrot No. 13 | |
| 92 Dolores No. 11 | |
| 93 Parrot No. 1 | |
| 94 Parrot No. 4 | |
| 95 Parrot No. 5 | |
| 96 Red Rook No. 3 | |
| 97 Buokhorn | |
| 98 Parrot No. 14 | |
| 99 Roy Lee | |
| 100 Parrot No. 6 | |

1/ Land patented as agricultural land or placer claim, and which is some distance from known carbonate deposits, is not shown.

THE GEOLOGICAL SURVEY MAKES NO WARRANTY AS TO THE ACCURACY OR COMPLETENESS OF THE INFORMATION ABOUT CLAIMS SHOWN ON THIS MAP AND ASSUMES NO LIABILITY WITH RESPECT TO THE USE OF THIS INFORMATION.

This map is a liability and has not been edited or re-issued for conformity with U. S. Geological Survey standards and nomenclature.

Mapped, edited, and published by the Geological Survey
Control by USGS and USC&GS
Topography from aerial photographs by multiple exposures
Aerial photographs taken September 1947. Field check 1949
Photogram projection, 1927 North American datum
10,000-foot grid based on Colorado's readjusted system,
south zone
Dashed lines indicate approximate location
Land area unchanged in 1947 of T. 43 N., R. 17 W.
24 T. 42 N., R. 17 W.
Unpatented claims are shown in brown

SCALE 1:24,000
CONTOUR INTERVAL 20 FEET
DATUM IS MEAN SEA LEVEL
TOPOGRAPHIC BASE COMPLEIES WITH NATIONAL MAP ACCURACY STANDARDS
CLAIM INFORMATION COMPILED BY R. D. SAMPLE AND H. E. ALBEE

ROAD CLASSIFICATION
HEAVY SURFACE ALL WEATHER ROADS DRY WEATHER ROADS
Heavy duty Improved dirt
Medium duty Unimproved dirt
Loose surface graded or narrow hard surface
U. S. Roads State Roads

JOE DAVIS HILL COLO.
N3752.5-W10845.7.5
EDITION OF 1950