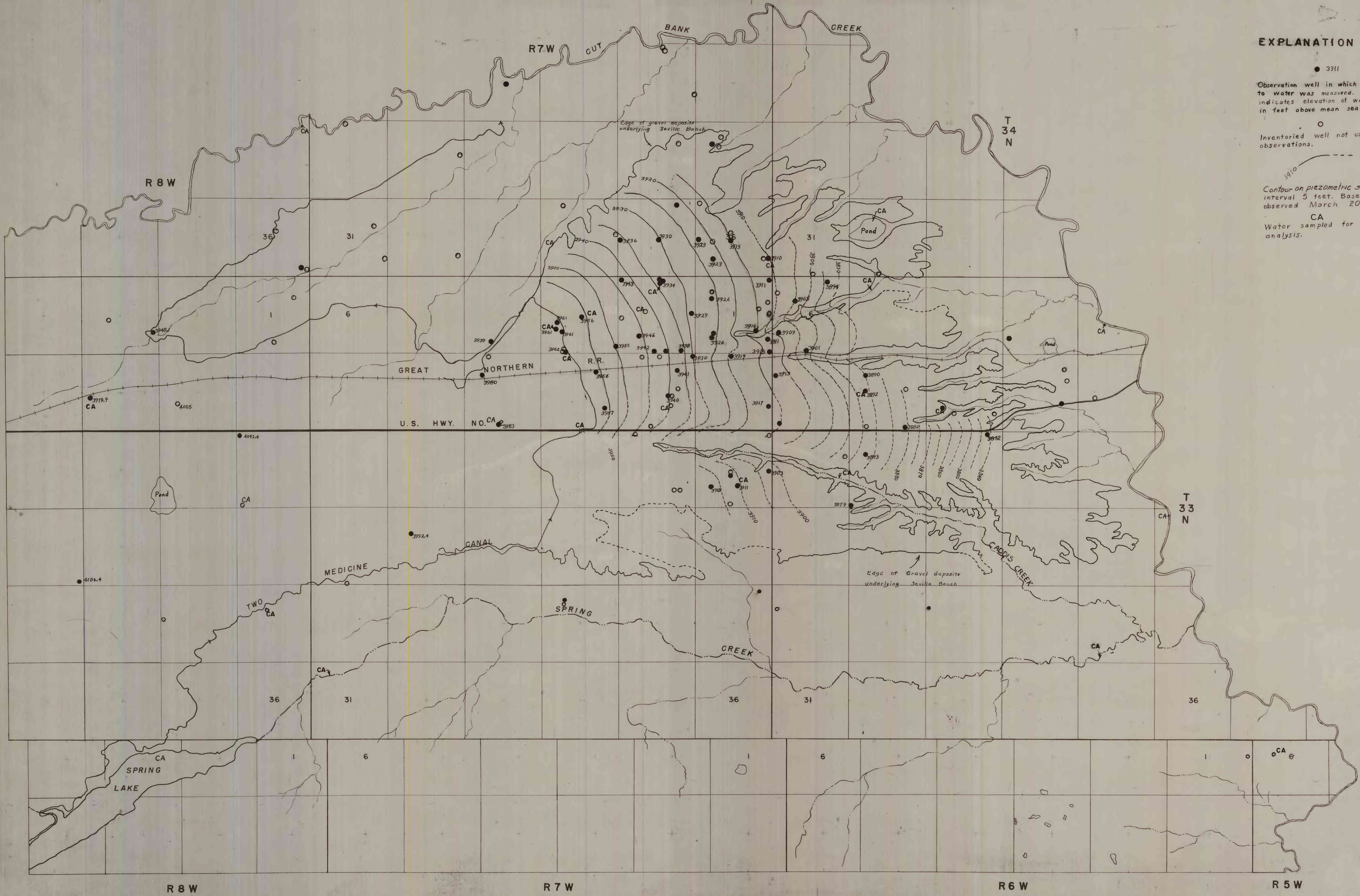

FIGURE 9.-- MAP OF TWO MEDICINE IRRIGATION UNIT AND ADJACENT AREAS SHOWING  
LOCATION OF WELLS, WATER-SAMPLING POINTS, AND CONTOURS ON THE  
PIEZOMETRIC SURFACE



EXPLANATION

- 3911  
Observation well in which depth to water was measured. Number indicates elevation of water table in feet above mean sea level.
- Inventoried well not used for observations.
- Contour on piezometric surface. Contour interval 5 feet. Based on data observed March 20-21, 1937.
- CA  
Water sampled for chemical analysis.