

MAPPED, EDITED, AND PUBLISHED BY THE GEOLOGICAL SURVEY
CONTROL BY USGS, USCGS, AND INTERNATIONAL BOUNDARY COMMISSION
COMPILED IN 1963 FROM U.S. GEOLOGICAL SURVEY 1:63,360 SCALE MAPS
SURVEYED 1956 AND 1957. MAP NOT FIELD CHECKED.
UNIVERSAL TRANSVERSE MERCATOR PROJECTION. 1927 NORTH AMERICAN DATUM.
100,000 FOOT GRID BASED ON ALASKA COORDINATE SYSTEM, ZONE 2.
63,000 METER UNIVERSAL TRANSVERSE MERCATOR GRID TICS.
ZONE 7 SHOWN IN BLUE.
LAND LINES REPRESENT UNSURVEYED AND UNMARKED LOCATIONS
PREDETERMINED BY THE BUREAU OF LAND MANAGEMENT
POLY-P-R FAIRBANKS MERIDIAN AND FOUR CR-1 COPPER RIVER MERIDIAN
SWAMPS, AS PORTRAYED, INDICATE ONLY THE WETTER AREAS
USUALLY OF LOW RELIEF, AS INTERPRETED FROM AERIAL PHOTOGRAPHS.

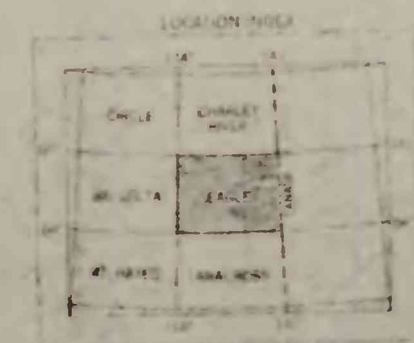
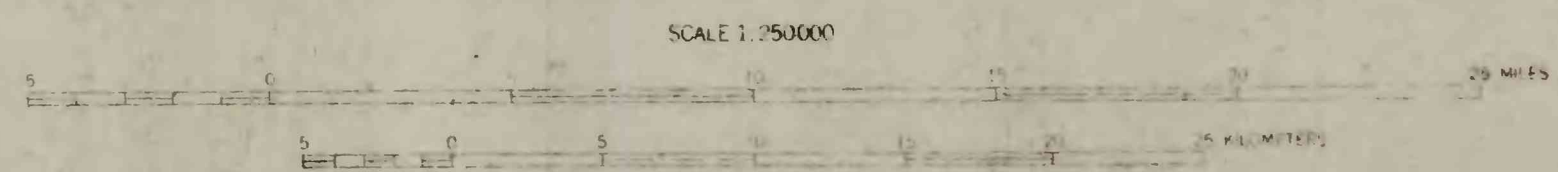
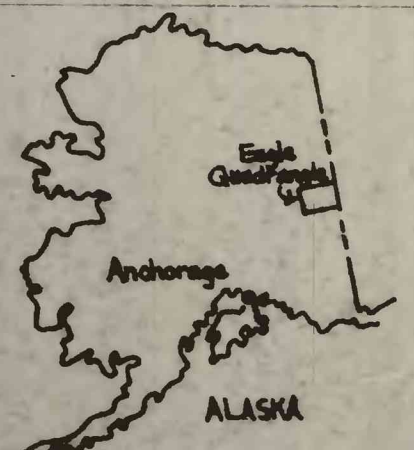

By Helen I. Foster and
Sandra H. G. Clark, 1968.

U.S. Geological Survey
OPEN-FILE MAP
This map is preliminary and has
not been edited or reviewed
for conformity with Geological
Survey standards and nomenclature.
EAGLE, ALASKA
1957

THIS MAP IS AVAILABLE IN BOTH SHADED RELIEF AND UNIFORM TONING
FOR SALE BY U.S. GEOLOGICAL SURVEY
FAIRBANKS, ALASKA 99701, DENVER, COLORADO 80225, OR WASHINGTON, D.C. 20242
A FOLDER DESCRIBING TOPOGRAPHIC MAPS AND SYMBOLS IS AVAILABLE ON REQUEST

Figure 1. Map of Eagle Quadrangle, Alaska, showing locations of analyzed stream-sediment samples.