

HORIZONTAL SCALE ..... 1:63,360  
VERTICAL SCALE ON RECONNAISSANCE PROFILES AS SHOWN  
CONTOUR INTERVAL ..... 20 GAMMA  
20 GAMMA CONTOUR .....  
100 GAMMA CONTOUR .....  
MAGNETIC LOW .....  
MAGNETIC MAXIMUM/MINIMUM ..... x 947  
SURVEY ALTITUDE ..... 2,500' ASL  
FLIGHT LINE ..... RECONNAISSANCE SURVEY  
MAGNETICS BASED ON ARBITRARY DATUM  
REGIONAL MAGNETIC GRADIENT NOT REMOVED  
ESTIMATED TOTAL INTENSITY OF FIELD: 55,000 GAMMAS  
MEAN INCLINATION: +75°

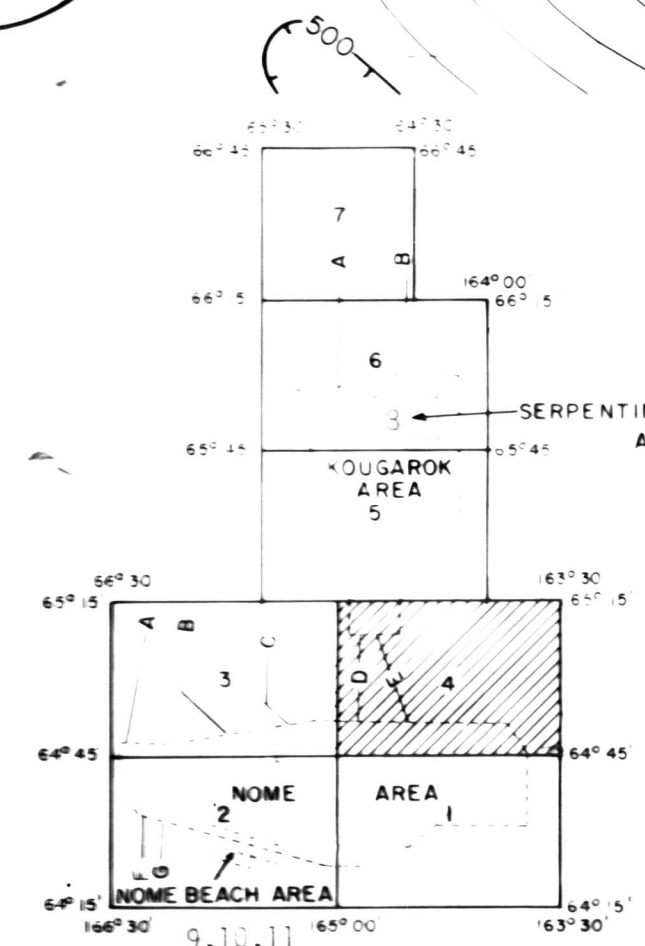

INDEX MAP SHOWING DETAILED LOCATION OF AIRBORNE GEOPHYSICAL SURVEYS IN SEWARD PENINSULA, 1966. COVERAGE CONFINED TO AREAS OUTLINED BY DASHED LINES PLUS LETTERED PROFILES.

# AIRBORNE GEOPHYSICAL SURVEYS IN SEWARD

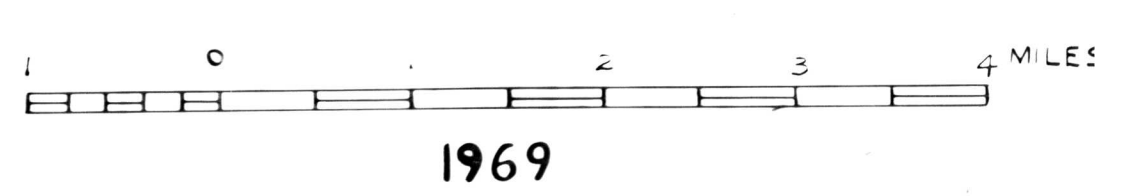

1969