

MAPPED, EDITED, AND PUBLISHED BY THE GEOLOGICAL SURVEY
CONTROL BY USGS, USC&GS AND INTERNATIONAL BOUNDARY COMMISSION

GRAVITY DATUM FROM BARNES (OPEN FILE, 1968, 1972)

REDUCTION DENSITY = 2.67 G/cc

GRAVITY SURVEYS PARTIALLY SUPPORTED
BY U.S. ARMY TOPOCOM, PROJECT 3-68

HJ55 STATION IDENTIFICATION
○ STATION LOCATION
○ -96 SIMPLE BOUGUER ANOMALY

-30-

This map is preliminary and has not
been reviewed for conformity with
U.S. Geological Survey standards
and nomenclature.

SCALE 1:250000

USGS ALASKAN GRAVITY DATA

BY DAVID F. BARNES

1972

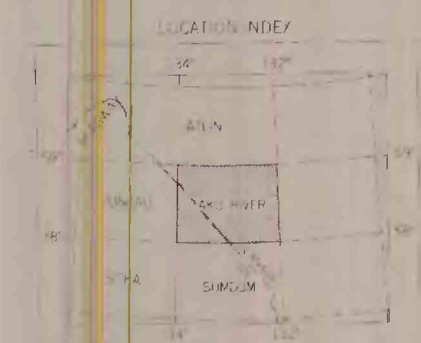

GRAVITY MEASUREMENTS 1968 & 1969

ROAD CLASSIFICATION
NM-5(2) 5(1)

USGS GRAVITY DATA
TAKU RIVER, ALASKA - CANADA
1968-1969

1960