

MAPS, FIGURES, AND PUBLICATIONS BY THE GEOLOGICAL SURVEY
 UNITED STATES GOVERNMENT PRINTING OFFICE: 1969
 267

STATION IDENTIFICATION
 STATION LOCATION
 SIMPLE BOUGUER ANOMALY
 -22.7
 KX42
 GENERALIZED BOUGUER ANOMALY CONTOURS
 This map is preliminary and has not been reviewed for conformity with U.S. Geological Survey standards and nomenclature.

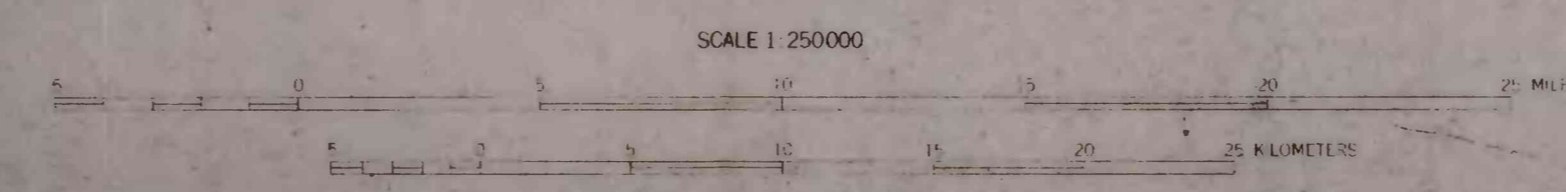

USGS ALASKAN GRAVITY DATA
 BY DAVID F. BARNES
 1973

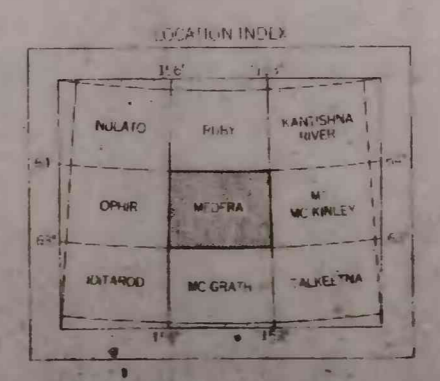

GRAVITY MEASUREMENTS 1968 & 1969
 ROAD CLASSIFICATION
 UNIMPROVED DIST
 USGS GRAVITY DATA
 MEDFRA, ALASKA
 1999