

R. 73 W. R. 72 W.

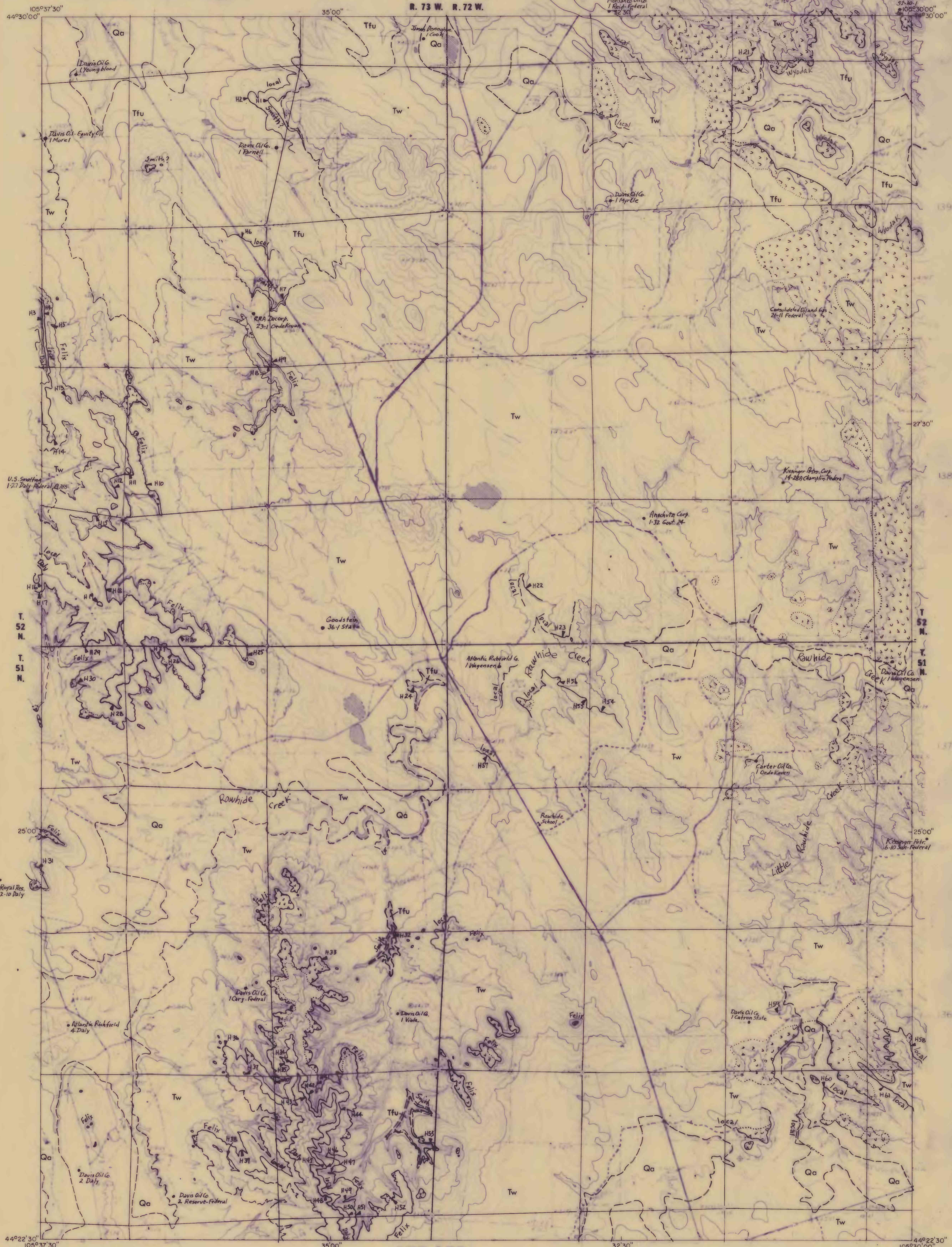

Base from U.S. Geological Survey  
uneditied advance print

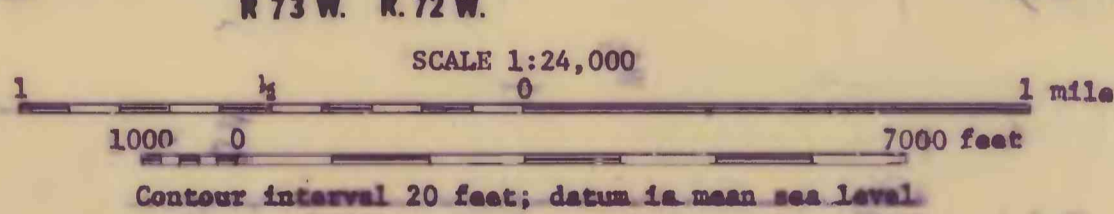

U.S. Geological Survey  
OPEN FILE REPORT  
Geology mapped in 1972  
This map is preliminary and has not  
been edited or reviewed for conformity  
with Geological Survey standards or  
nomenclature.

**PRELIMINARY GEOLOGIC MAP OF THE RAWHIDE SCHOOL QUADRANGLE, CAMPBELL COUNTY, WYOMING**

By  
**W. J. Mapel**

EXPLANATION	
<p><b>Qa</b> ALLUVIUM (HOLOCENE)—Unconsolidated silt and sand on the flood plains of the largest streams. Includes slope wash locally</p>	<p>QUATERNARY</p>
<p><b>Tw</b> WASATCH FORMATION (EOCENE)—Yellowish- and light-gray friable generally fine- to very fine-grained sandstone, medium-gray mudstone and claystone, brown carbonaceous shale, and coal. Contact with the underlying Fort Union Formation drawn approximately at the base of a sequence several tens of feet thick of crossbedded fine- to locally medium-grained sandstone</p>	
<p>UNCONFORMITY</p> <p><b>Tfu</b> FORT UNION FORMATION (PALEOCENE)—Light-gray and light-yellowish-gray slabby very fine-grained sandstone and siltstone, medium-gray mudstone and claystone, brown carbonaceous shale, and coal</p>	<p>TERTIARY</p>
<p>----- Contact—Approximately located. Dotted where concealed. Not shown in areas where rock is extensively altered by the burning of coal</p>	<p>----- Outcrop of coal bed—Drawn on base of the coal. Dashed where approximately located; dotted where concealed. Number identifies locality of measured coal section shown on sheet 2. Bed name queried where correlation is uncertain</p>
<p>----- Outcrop of burned coal bed—Dashed where approximately located. Dotted line shows limit of rock altered by burning of the coal</p>	<p>••••• Drill hole—Holes for which thickness and depth of coal were determined as listed in table 1 (sheet 2)</p>