

73-211

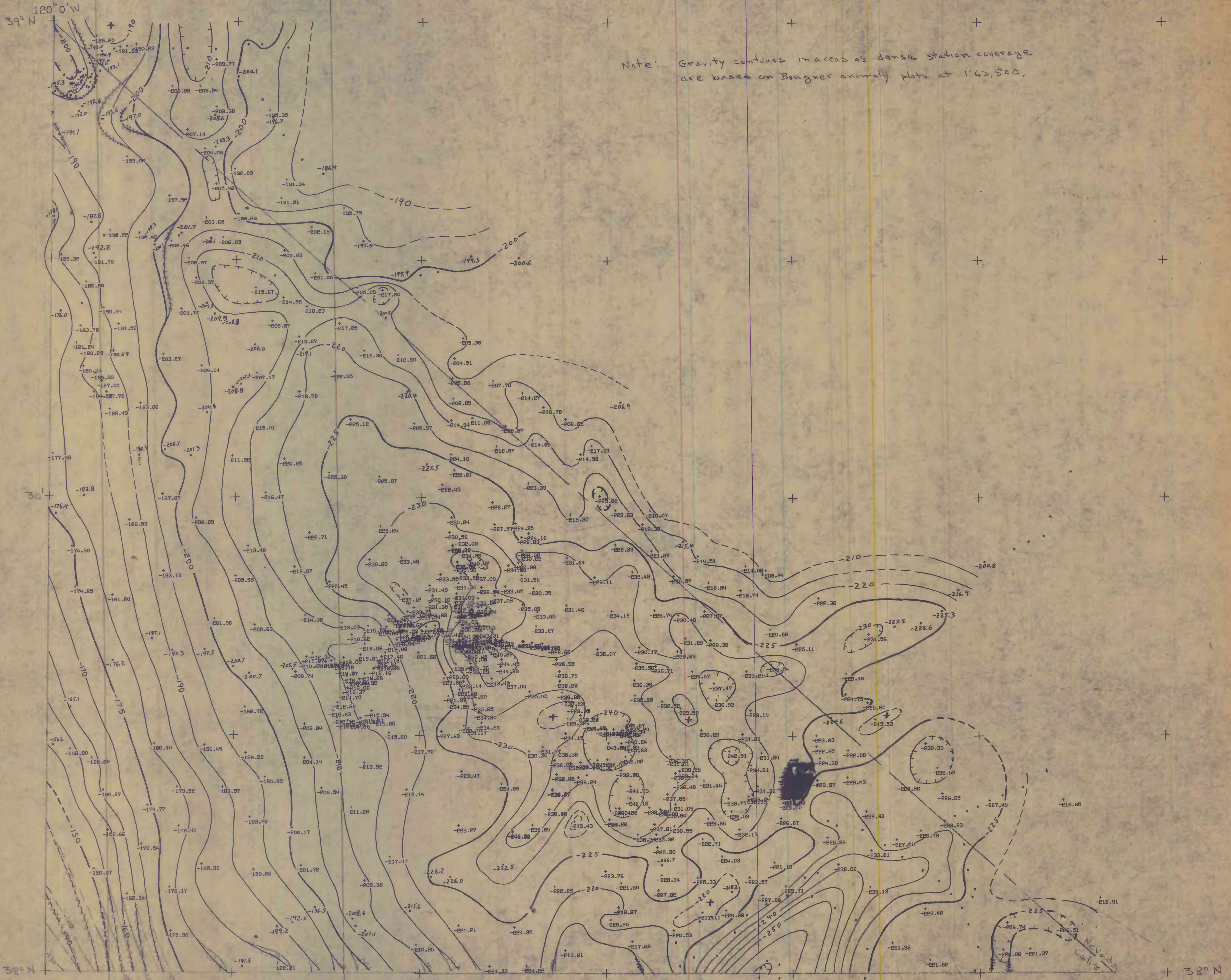

Note: Gravity contours in areas of dense station coverage are based on Bouguer anomaly plots at 1:62,500.

Bouguer reduction
density = 2.67 g/cm³
Includes terrain corrections
to distances 1600 ft.
Contour interval
is 5 mgals.

Complete Bouguer gravity map of part of the Walker Lake 1° x 2° quadrangle,
California and Nevada.

Compiled by A.W. Oliver, S.L. Robbins, and W.L. Rambo. Includes data obtained by R.H. Chapman, D.R. Mabey,
A.A. Oliver III and other students at Stanford Univ., A.A. Leunis, and J.L. Burnette.

This map is preliminary and has not
been reviewed for conformity with
U.S. Geological Survey standards
and nomenclature.