

VES 7

LVI

VES 8

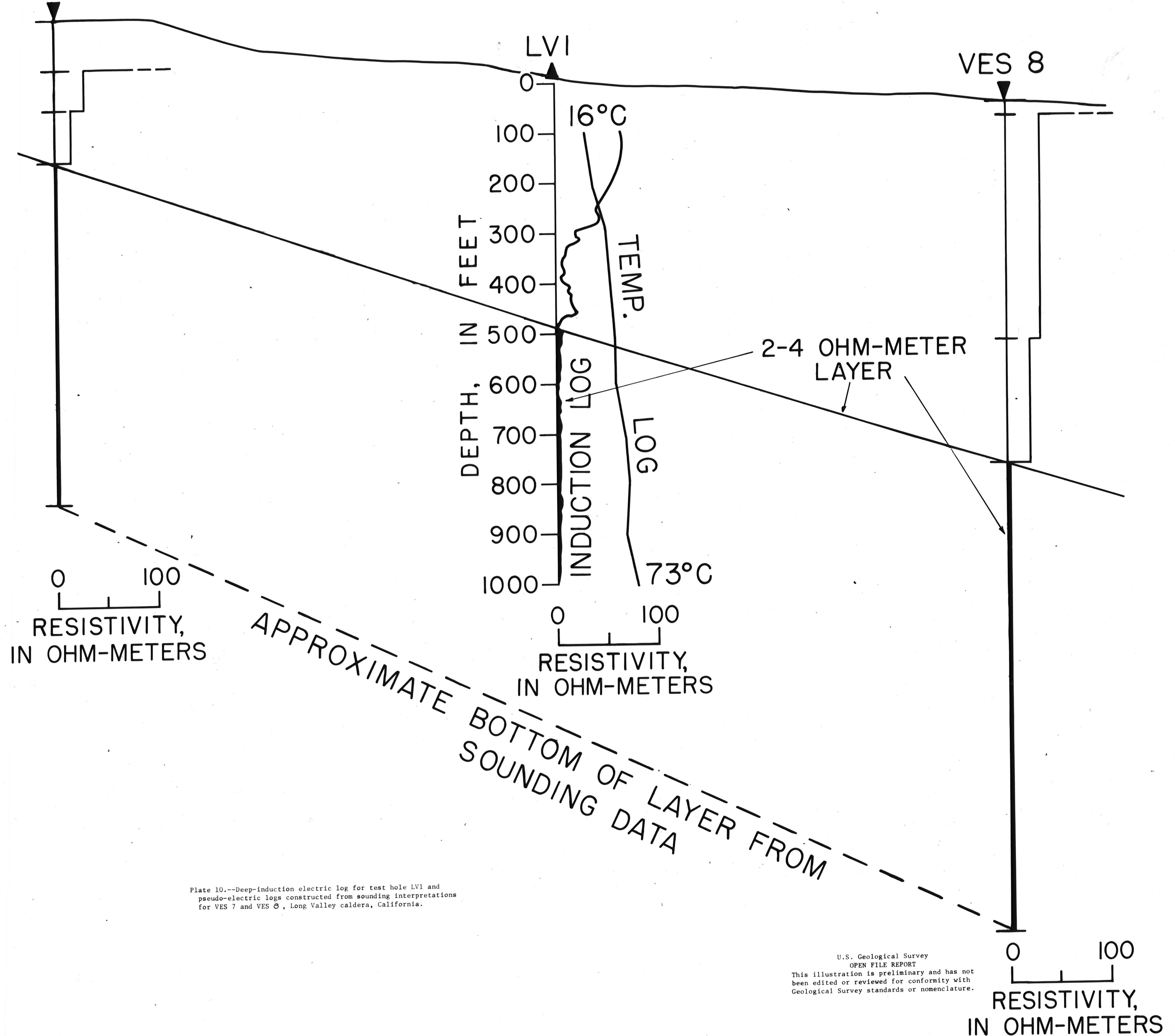

Plate 10.--Deep-induction electric log for test hole LVI and pseudo-electric logs constructed from sounding interpretations for VES 7 and VES 8, Long Valley caldera, California.

U.S. Geological Survey
OPEN FILE REPORT
This illustration is preliminary and has not been edited or reviewed for conformity with Geological Survey standards or nomenclature.

RESISTIVITY,
IN OHM-METERS