

OPEN-FILE REPORT
This report has not been edited for conformity with U.S. Geological Survey editorial standards or stratigraphic nomenclature.
OPEN FILE REPORT 78-034
PLATE 8 OF 18

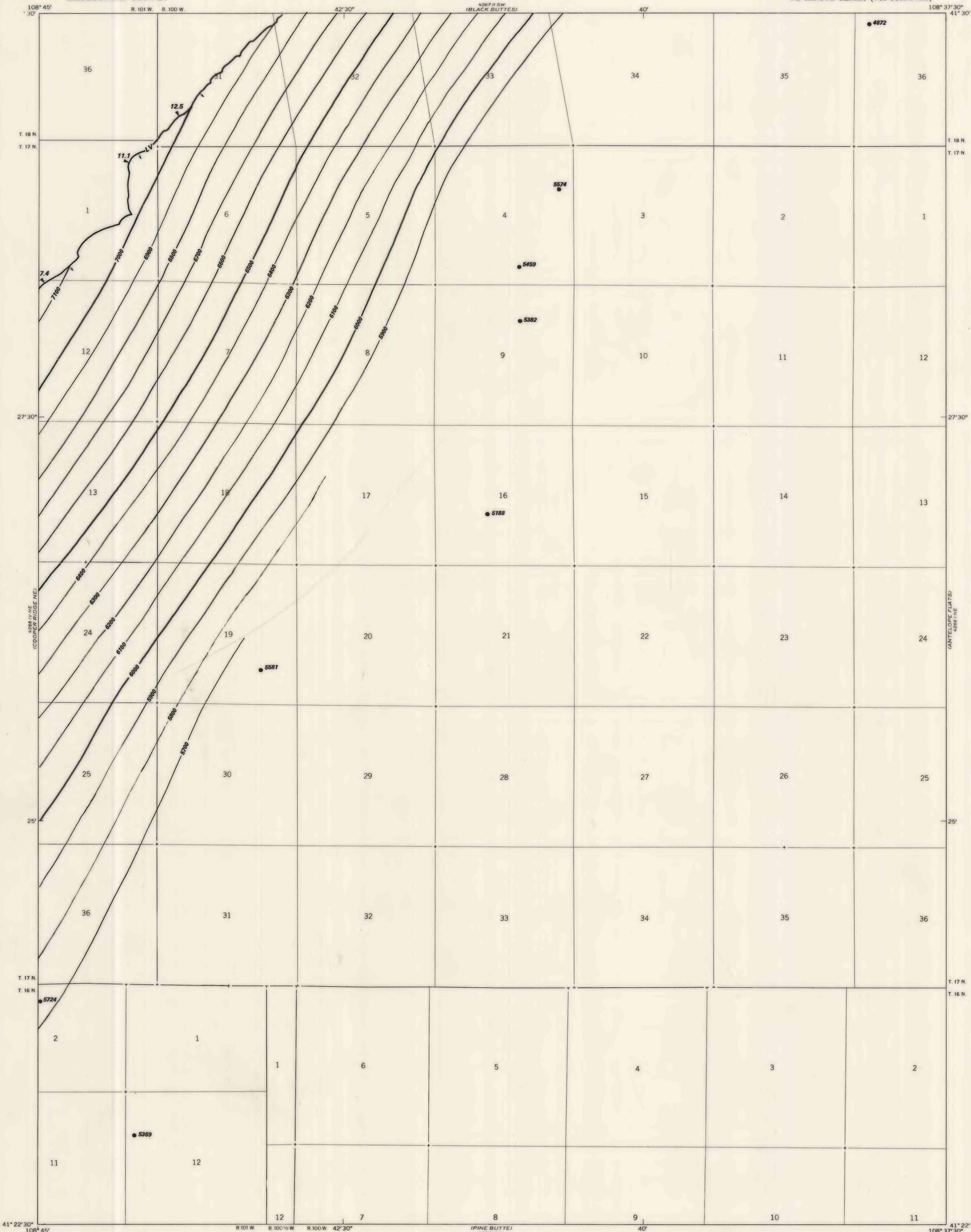

EXPLANATION

— LV —
TRACE OF OUTCROP OF THE LITTLE VALLEY COAL BED—Arrow points toward coal-bearing area.

— 7000 —
— 6900 —
STRUCTURE CONTOURS—Drawn on the top of the Little Valley (LV) coal bed. Contour interval 100 feet (30.5 m). Datum is mean sea level.

● 5724
DRILL HOLE—Showing altitude of the top of the Little Valley (LV) coal bed.

To convert feet to meters, multiply feet by 0.3048.

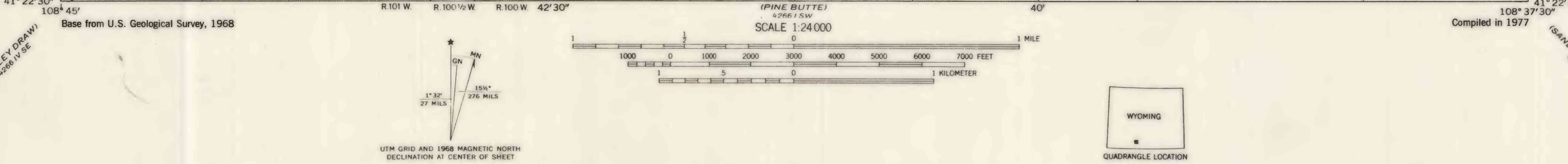

COAL RESOURCE OCCURRENCE AND COAL DEVELOPMENT POTENTIAL MAPS OF THE SAND BUTTE RIM NW QUADRANGLE, SWEETWATER COUNTY, WYOMING
By
WALTER DANILCHIK
1978