

OPEN FILE REPORT
This report has not been edited for conformity with U.S. Geological Survey editorial standards or stratigraphic nomenclature.

OPEN FILE REPORT 78-036
PLATE 11 OF 12

EXPLANATION

 NON-FEDERAL COAL LAND—Land for which the Federal Government does not own the coal rights.

 AREA OF PREFERENCE RIGHTLEASE APPLICATION—Coal resources not calculated.

RB	R(.50)	Measured
—	—	Indicated
1.1	.55	Inferred

IDENTIFIED RESOURCES OF THE PINTAIL (PT) COAL BED—Showing totals for Reserve Base (RB) and Reserves (R), in millions of short tons, for each section or part(s) of section of Federal coal land. Dash indicates no resources in that category. Reserve Base (RB) x Recovery Factor (0.50)=Reserves (R).

To convert short tons to metric tons, multiply short tons by 0.9072.

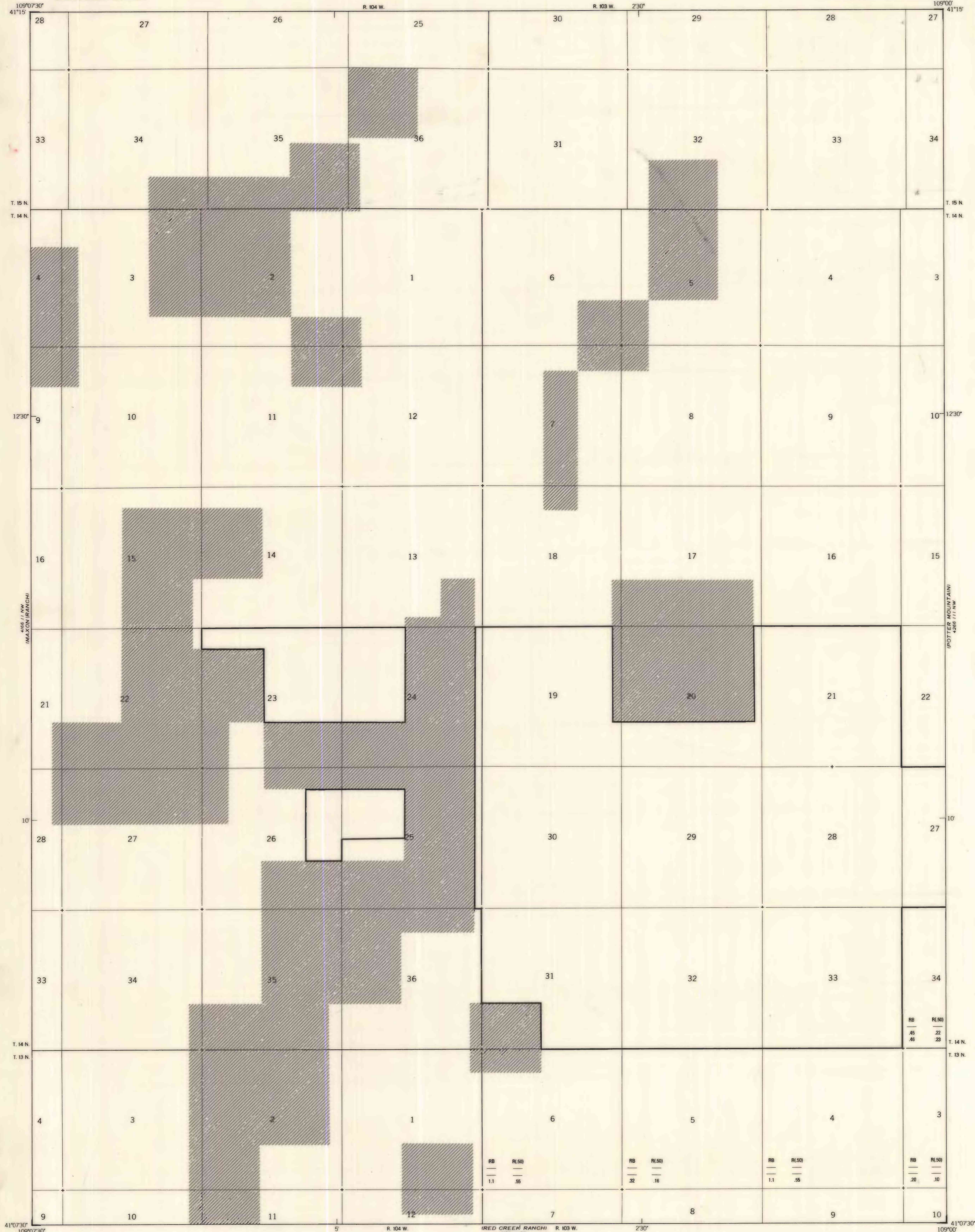

Base from U.S. Geological Survey, 1963

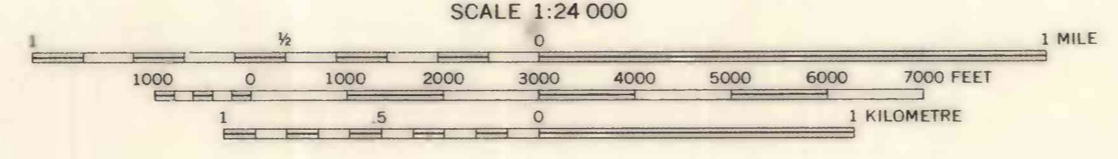
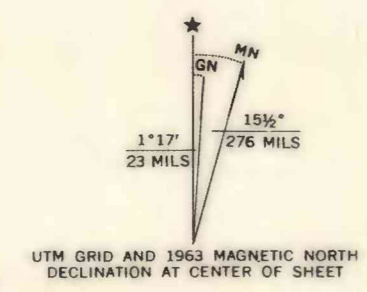

Compiled in 1977

COAL RESOURCE OCCURRENCE AND COAL DEVELOPMENT POTENTIAL MAPS OF THE TITSWORTH GAP QUADRANGLE,
SWEETWATER COUNTY, WYOMING

BY
H. W. ROEHLER
1978

PLATE 11
IDENTIFIED RESOURCES OF THE
PINTAIL COAL BED