

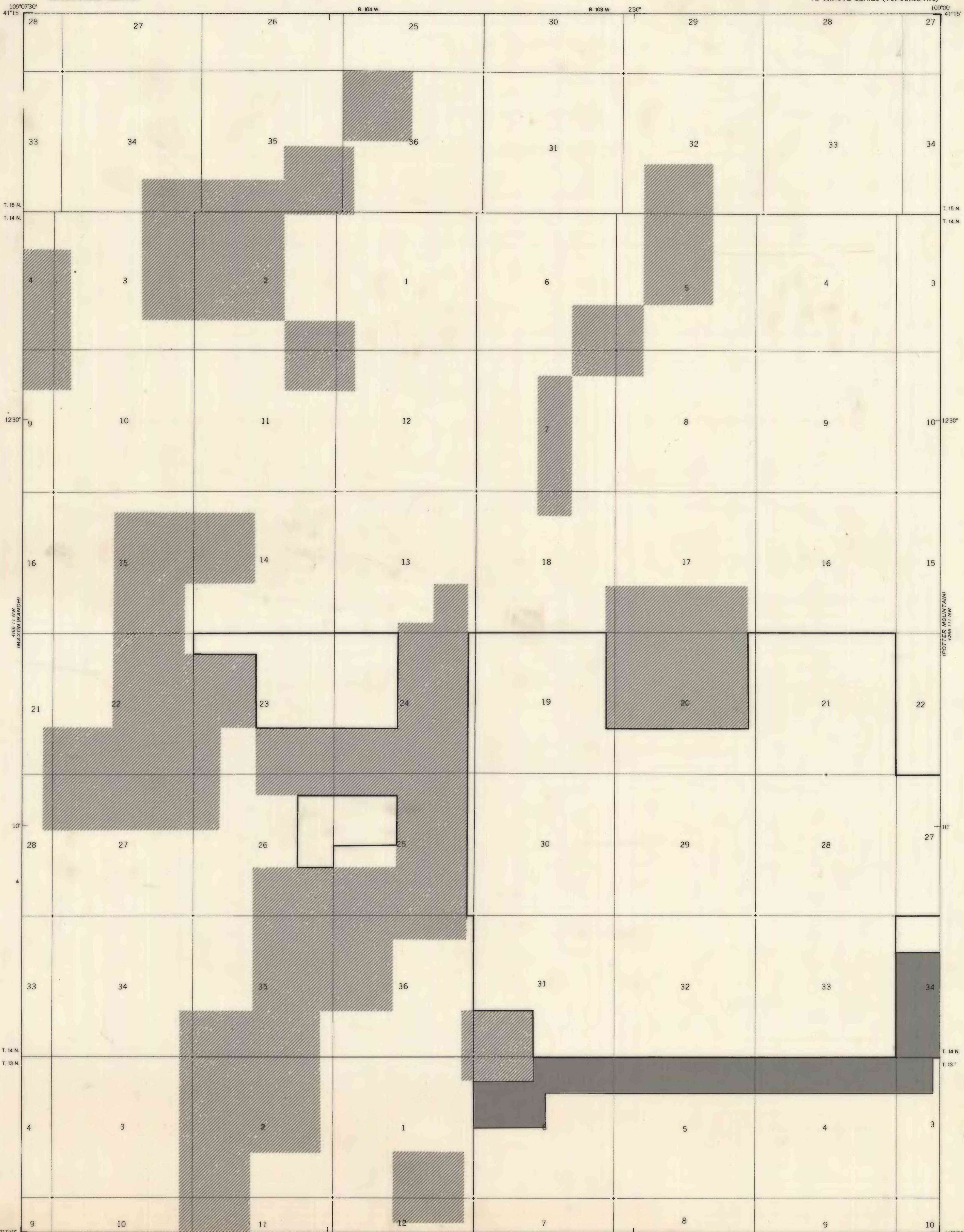

**OPEN FILE REPORT**  
This report has not been edited for conformity with U.S. Geological Survey editorial standards or stratigraphic nomenclature.

**OPEN FILE REPORT 78-036**  
**PLATE 12 OF 12**



**EXPLANATION**

 **NON-FEDERAL COAL LAND**—Land for which the Federal Government does not own the coal rights and for which the coal development potential is not rated.

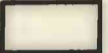
 **AREA OF PREFERENCE RIGHT LEASE APPLICATION**—Coal-development potential not rated.

 **AREA OF HIGH COAL-DEVELOPMENT POTENTIAL FOR SUBSURFACE-MINING METHODS FOR THE PIN-TAIL COAL BED.**

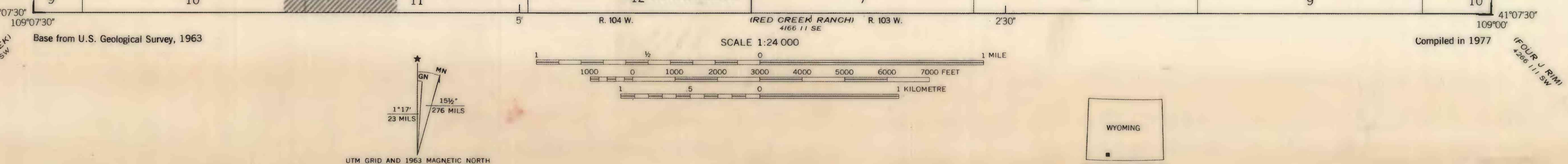

**COAL RESOURCE OCCURRENCE AND COAL DEVELOPMENT POTENTIAL MAPS OF THE TITSWORTH GAP QUADRANGLE, SWEETWATER COUNTY, WYOMING**

BY  
**H. W. ROEHLER**  
1978

**PLATE 12**  
**COAL DEVELOPMENT POTENTIAL FOR SUBSURFACE MINING METHODS**