

UNITED STATES
 DEPARTMENT OF THE INTERIOR
 GEOLOGICAL SURVEY

COMO WEST QUADRANGLE
 WYOMING-CARBON CO.
 7.5 MINUTE SERIES (TOPOGRAPHIC)
 NW 1/4 SADDLEBACK HILLS 15' QUADRANGLE

4768 III SW
 (DIFFICULTY)

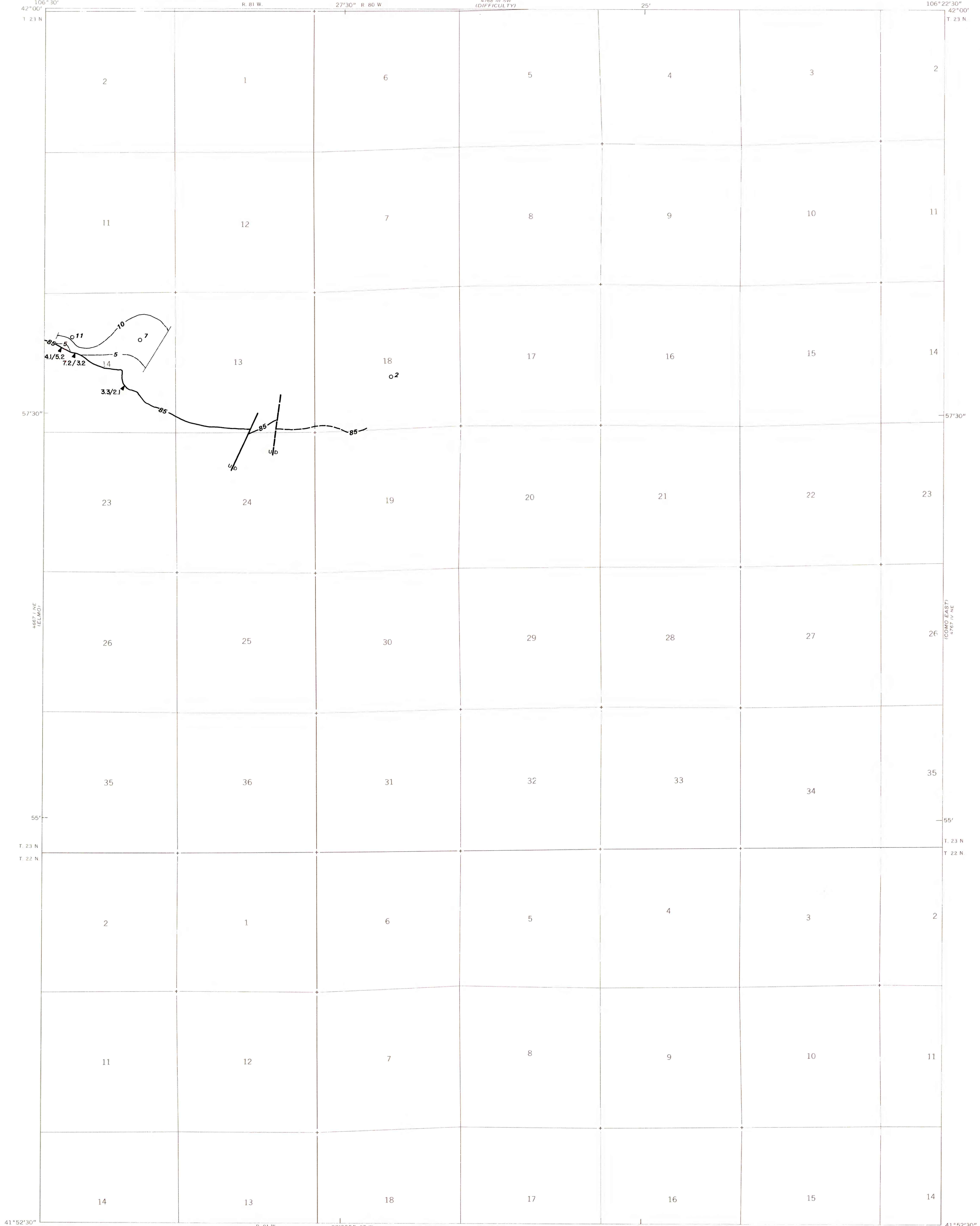

EXPLANATION

- ISOPACHS—Showing thickness of coal bed, in feet. Dashed where inferred. Isopach interval 5 feet.
 - DRILL HOLE—Showing thickness of coal bed, in feet. Drill holes which do not intersect the coal bed or from which a coal bed thickness could not be determined are not shown.
 - TRACE OF COAL BED OUTCROP—Showing the name of the coal bed. Showing ratio of coal thickness to interburden, in feet, measured at triangle. Dashed where inferred.
 - FAULT—Dashed where approximately located. U, upthrown side; D, downthrown side.
 - INSUFFICIENT DATA BOUNDARY—Showing area beyond which no coal bed thickness data is available.
- To convert feet to meters, multiply feet by 0.3048.

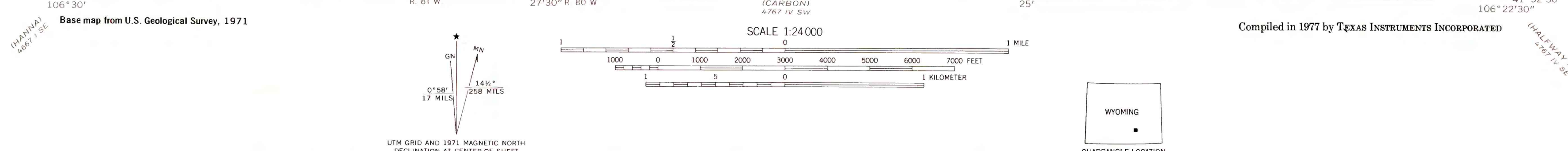

COAL RESOURCE OCCURRENCE MAP OF THE COMO WEST QUADRANGLE,
 CARBON COUNTY, WYOMING
 BY
 TEXAS INSTRUMENTS INCORPORATED
 1978