

UNITED STATES
 DEPARTMENT OF THE INTERIOR
 GEOLOGICAL SURVEY

COMO WEST QUADRANGLE
 WYOMING—CARBON CO.
 7.5 MINUTE SERIES (TOPOGRAPHIC)
 NW 1/4 SADDLEBACK HILLS 15' QUADRANGLE

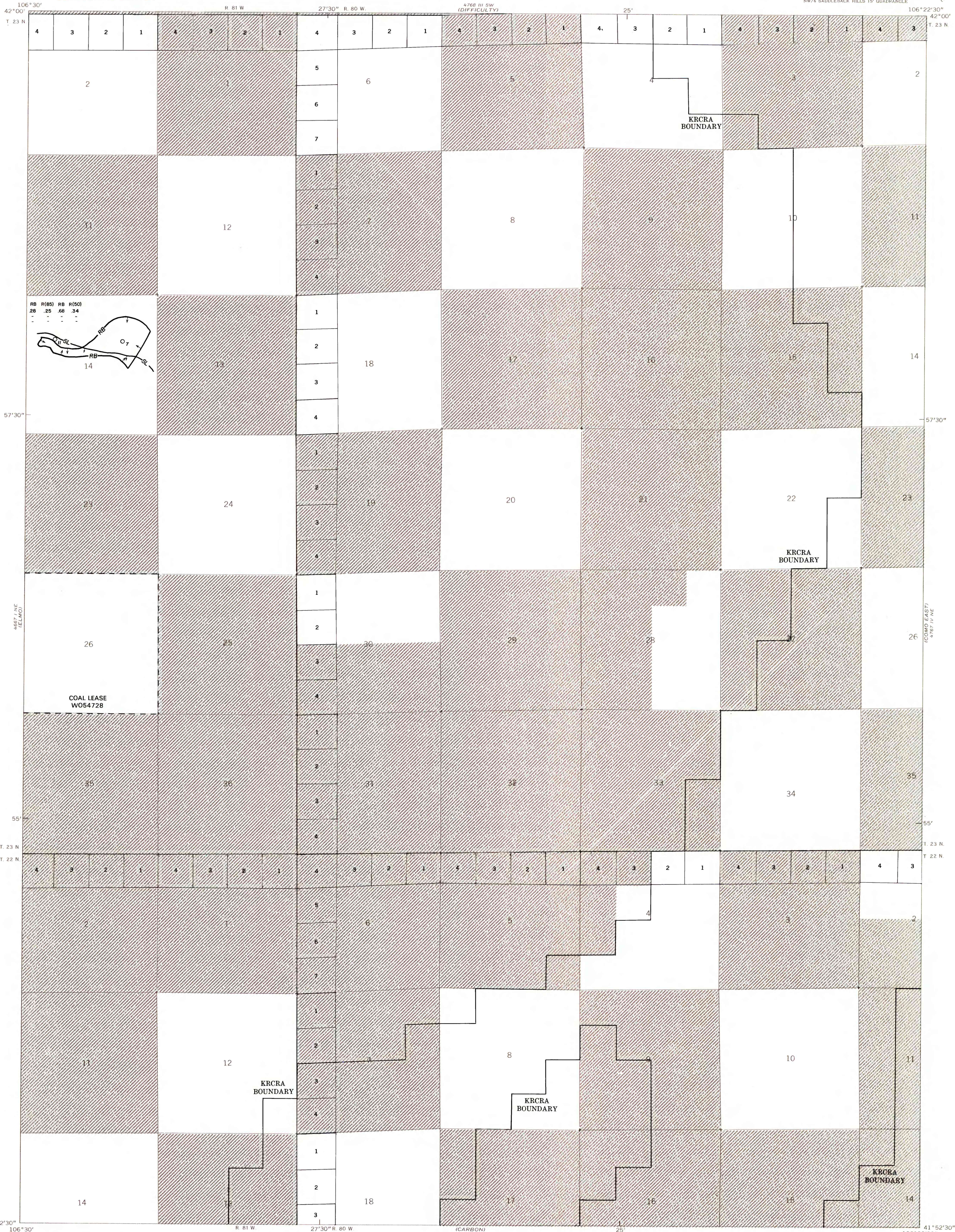

EXPLANATION

KRCRA BOUNDARY
 KNOWN RECOVERABLE COAL RESOURCE AREA—Area in which the Federal coal land is classified, (1) as subject to the coal leasing provisions of the Mineral Leasing Act of 1920, as amended and, (2) by virtue of the available data being sufficient to permit evaluation as to extent, location, and potential for developing commercial quantities of coal.

NON-FEDERAL COAL LAND—Land for which the Federal Government does not own the coal rights.

COAL LEASE—An area of Federal coal lands in which the Federal Government has entered into a contractual agreement for development of the coal deposits.

STRIPPING LIMIT LINE—Boundary for surface mining of the coal bed. Limit is 200 feet of overburden. Arrows point toward the area suitable for strip mining. Recovery factor of 85 percent within that area in this quadrangle.

BOUNDARY OF RESERVE BASE COAL—Segments comprising the boundary line include: (1) the outcrop of coal bed or contact between burned and unburned coal where the coal is 5 feet (1.5 m) or more thick, (2) the 5-foot (1.5 m) coal isopach, (3) an arc 3 miles from the nearest coal measurement point, (4) insufficient data lines, (5) the coal isopach farthest down-dip from the outcrop trace, (6) boundaries of leased Federal coal and non-Federal coal land, and (7) KRCRA boundaries. Arrows point toward areas of Reserve Base coal.

LOCATION OF SUBSURFACE COAL MEASUREMENT
 thickness of coal, in feet

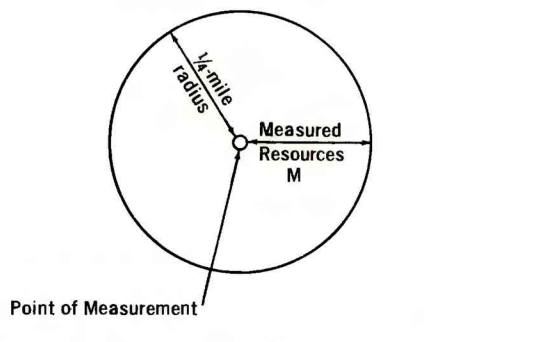

BOUNDARY LINES—Enclosing areas of measured, indicated, and inferred coal resources of the coal bed.

RB	R(85%)	(Meas. resources)
28	25	(Ind. resources)
-	-	(Inf. resources)

IDENTIFIED COAL RESOURCES OF THE 85 COAL BED—Showing totals for Reserve Base (RB) and Reserves (R), in millions of short tons, for each section or part(s) of section of Federal coal land within the stripping-limit line. Dash indicates no resources in that category. Reserve Base (RB) X the Recovery Factor (85 percent) = Reserves (R).

RB	R(50%)	(Meas. resources)
68	34	(Ind. resources)
-	-	(Inf. resources)

IDENTIFIED COAL RESOURCES OF THE 85 COAL BED—Showing totals for Reserve Base (RB) and Reserves (R), in millions of short tons, for each section or part(s) of section of Federal coal land outside the stripping-limit line. Dash indicates no resources in that category. Reserve Base (RB) X the Recovery Factor (50 percent) = Reserves (R).

To convert short tons to metric tonnes multiply short tons by 0.9072.

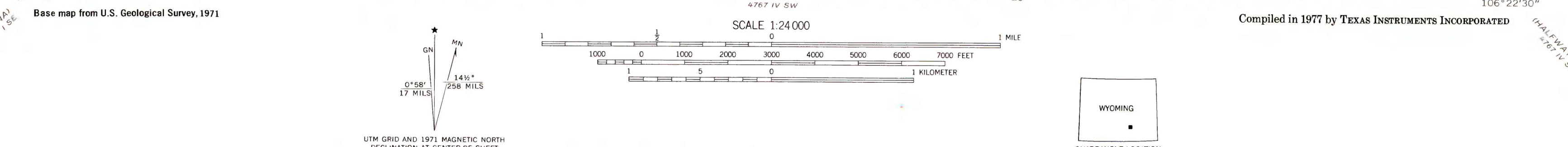

**COAL RESOURCE OCCURRENCE MAP OF THE COMO WEST QUADRANGLE,
 CARBON COUNTY, WYOMING
 BY
 TEXAS INSTRUMENTS INCORPORATED
 1978**