

UNITED STATES
 DEPARTMENT OF THE INTERIOR
 GEOLOGICAL SURVEY

COMO WEST QUADRANGLE
 WYOMING-CARBON CO.
 7.5 MINUTE SERIES (TOPOGRAPHIC)
 NW 4 SADDLEBACK HILLS 15' QUADRANGLE

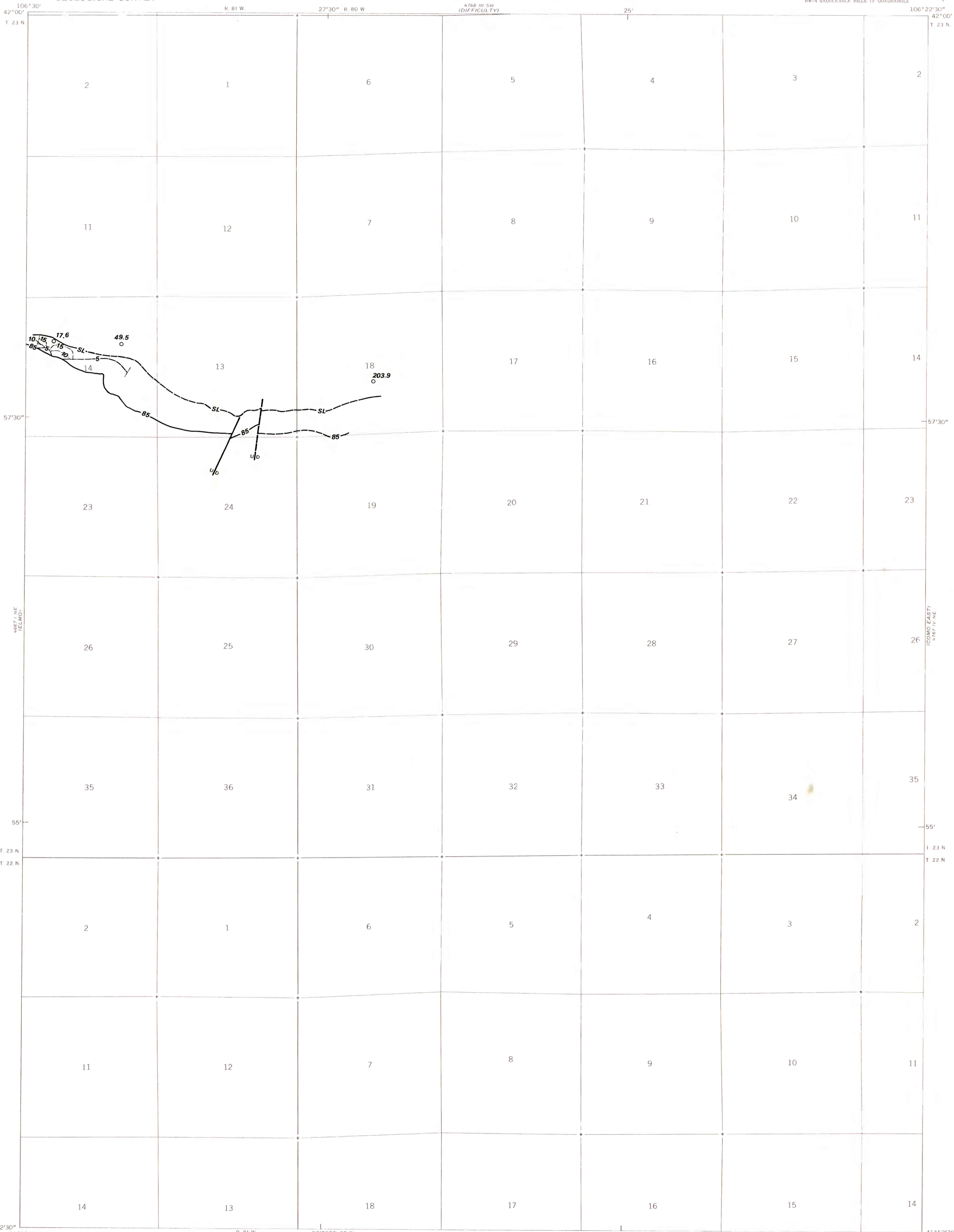

EXPLANATION

- 15-----
 MINING RATIO CONTOUR—Number indicates cubic yards of overburden per ton of coal recoverable by surface-mining methods. Contours shown only for leaseable Federal coal lands suitable for surface mining methods above the stripping limit.
- SL-----
 STRIPPING LIMIT LINE—Boundary for surface mining of coal bed. Limit is 200 feet of overburden. Dashed where inferred.
- 5-----
 RESERVE BASE COAL THICKNESS LIMIT—Five feet isopach. Dashed where inferred.
- 49.5
 DRILL HOLE—Showing mining ratio value only for leaseable Federal coal lands. Drill holes which do not intersect top of coal bed or from which mining ratios could not be determined are not shown.
- 85-----
 TRACE OF COAL BED OUTCROP—Showing name of coal bed. Dashed where inferred.
- U
 D
 FAULT—Dashed where approximately located. U, upthrown side; D, downthrown side.
- INSUFFICIENT DATA BOUNDARY—Showing area beyond which no coal bed thickness data is available.

To convert feet to meters,
 multiply feet by 0.3048.

Base map from U.S. Geological Survey, 1971

Compiled in 1977 by TEXAS INSTRUMENTS INCORPORATED

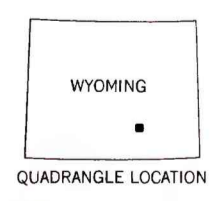
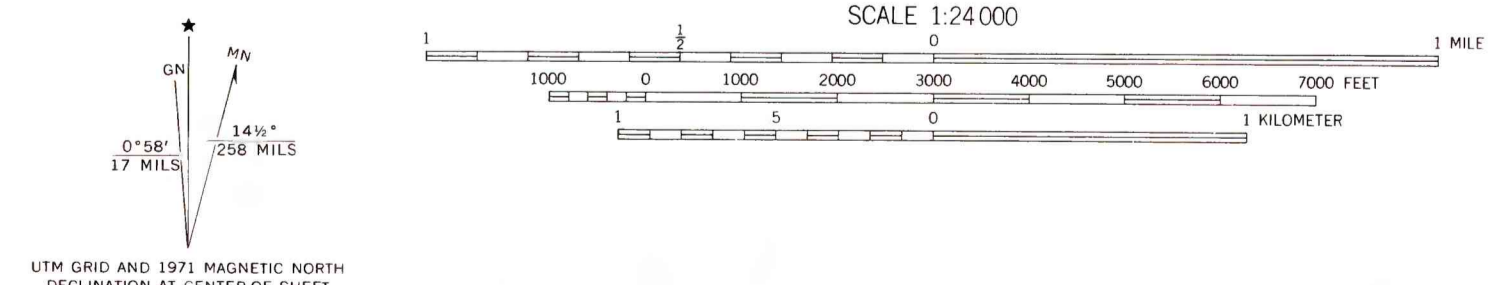

COAL RESOURCE OCCURRENCE MAP OF THE COMO WEST QUADRANGLE,
 CARBON COUNTY, WYOMING
 BY
 TEXAS INSTRUMENTS INCORPORATED
 1978