

KRCRA BOUNDARY

KNOWN RECOVERABLE COAL RESOURCE AREA—Area in which the Federal coal land is classified, (1) as subject to the coal leasing provisions of the Mineral Leasing Act of 1920, as amended and, (2) by virtue of the available data being sufficient to permit evaluation as to extent, location, and potential for developing commercial quantities of coal.

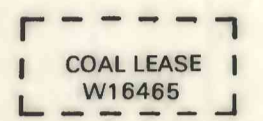

NON-FEDERAL COAL LAND—Land for which the Federal Government does not own the coal rights.



COAL LEASE—An area of Federal coal lands in which the Federal Government has entered into a contractual agreement for development of the coal deposits.

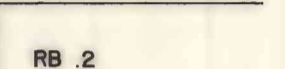

TOTAL RESERVE BASE (RB) OF FEDERAL COAL PER SECTION—In millions of short tons, calculated for each section of Federal land following guidelines given in U.S. Geol. Survey Bulletin 1450-B. To convert short tons to metric tons, multiply short tons by 0.9072.

4	3	2	1
5			
6			
7			

SECTION OF LAND  
 Showing lots and lot numbers

REFERENCE

U.S. Bureau of Mines and U.S. Geological Survey, 1976, Coal resource classification system of the U.S. Bureau of Mines and U.S. Geological Survey; U.S. Geol. Survey Bull. 1450-B, 7 p. Information derived from U.S. Bureau of Land Management Master Title plats and Coal plats issued April 22, 1977, and from oral communication, BLM State Office, Cheyenne, Wyoming.

UNITED STATES  
 DEPARTMENT OF THE INTERIOR  
 GEOLOGICAL SURVEY

DANA QUADRANGLE  
 WYOMING—CARBON CO.  
 7.5 MINUTE SERIES (TOPOGRAPHIC)

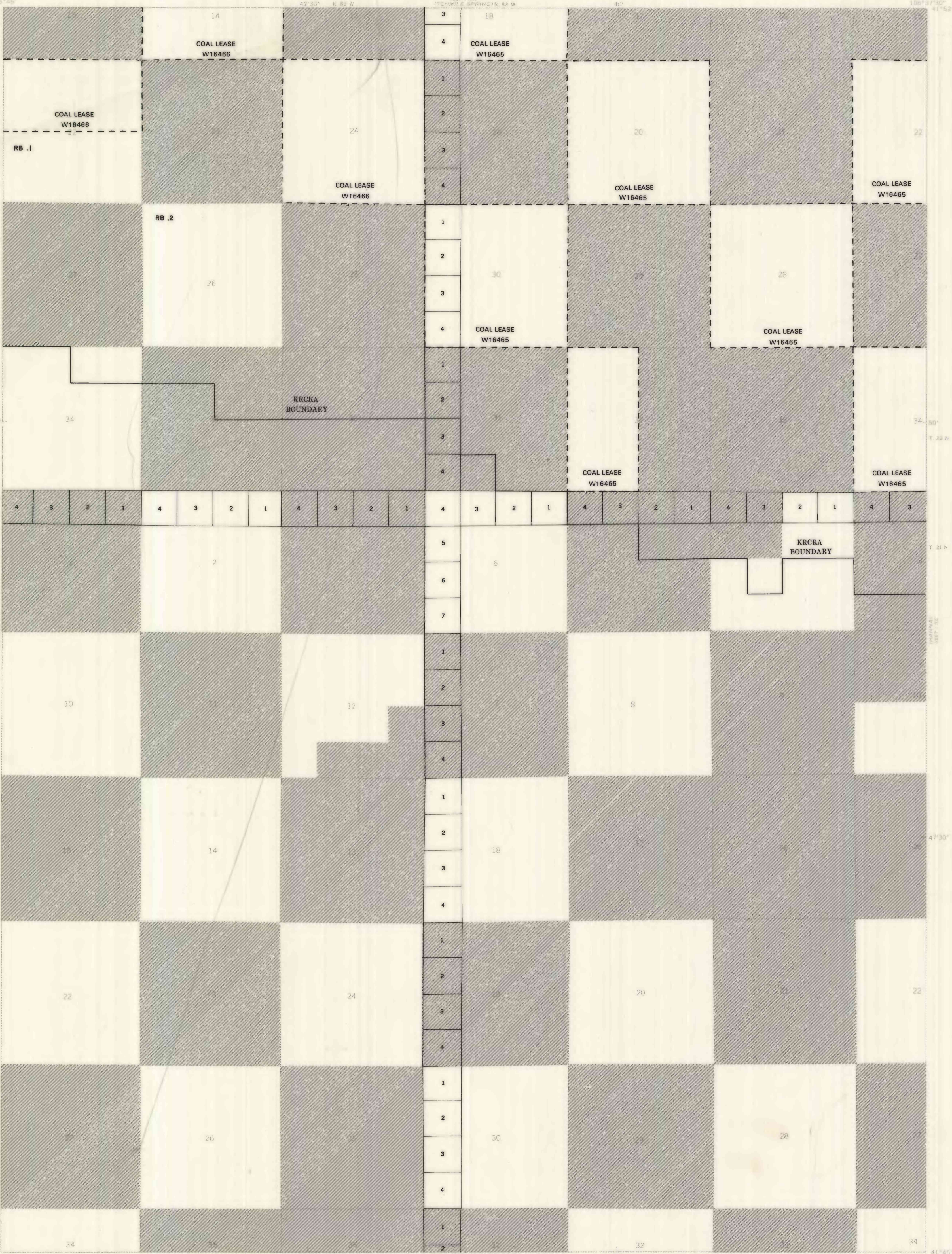

Base map from U.S. Geological Survey, 1971

Compiled in 1977 by TEXAS INSTRUMENTS INCORPORATED

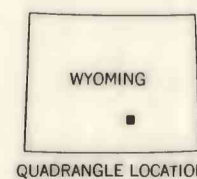
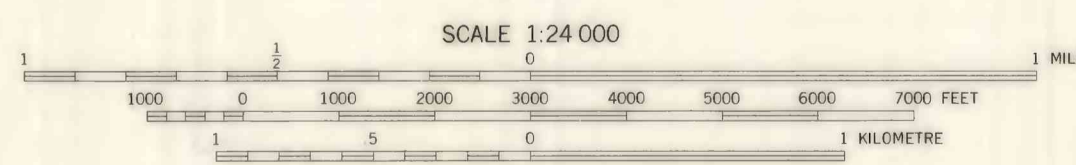
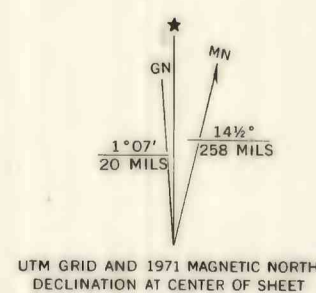

COAL RESOURCE OCCURRENCE MAP OF THE DANA QUADRANGLE,  
 CARBON COUNTY, WYOMING

BY  
 TEXAS INSTRUMENTS INCORPORATED  
 1978