

UNITED STATES  
DEPARTMENT OF THE INTERIOR  
GEOLOGICAL SURVEY

HANNA QUADRANGLE  
WYOMING-CARBON CO.  
7.5 MINUTE SERIES (TOPOGRAPHIC)  
SE/4 HANNA 18' QUADRANGLE

EXPLANATION

**KRCRA BOUNDARY**  
**KNOWN RECOVERABLE COAL RESOURCE AREA**-Area in which the Federal coal land is classified, (1) as subject to the coal leasing provisions of the Mineral Leasing Act of 1920, as amended and, (2) by virtue of the available data being sufficient to permit evaluation as to extent, location, and potential for developing commercial quantities of coal.

**NON-FEDERAL COAL LAND**-Land for which the Federal Government does not own the coal rights.

**COAL LEASE W25406**

**COAL LEASE**-An area of Federal coal lands in which the Federal Government has entered into a contractual agreement for development of the coal deposits.

**BOUNDARY OF RESERVE BASE COAL**-Segments comprising the boundary line include: (1) the outcrop of coal bed or contact between burned and unburned coal where the coal is 5 feet (1.5 m) or more thick, (2) the 5-foot (1.5 m) coal isopach, (3) an arc 3 miles from the nearest coal measurement point, (4) insufficient data lines, (5) the coal isopach farthest down-dip from the outcrop trace, (6) boundaries of leased Federal coal and non-Federal coal land, and (7) KRCRA boundaries. Arrows point toward areas of Reserve Base coal.

**LOCATION OF SUBSURFACE COAL MEASUREMENT**  
thickness of coal, in feet

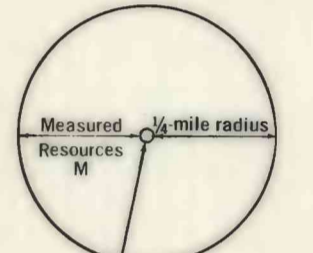

**BOUNDARY LINES**-Enclosing areas of measured, indicated, and inferred coal resources of the coal bed.

RB	R(85%)	(Meas. resources)	(Ind. resources)	(Inf. resources)
18	15	-	-	-

**IDENTIFIED COAL RESOURCES OF THE HANNA 1 BED**-Showing totals for Reserve Base (RB) and Reserves (R), in millions of short tons, for each section or part(s) of section of Federal coal land within the stripping-limit line. Dash indicates no resources in that category. Reserve Base (RB) X the Recovery Factor (85 percent) = Reserves (R).

To convert short tons to metric tonnes multiply short tons by 0.9072.

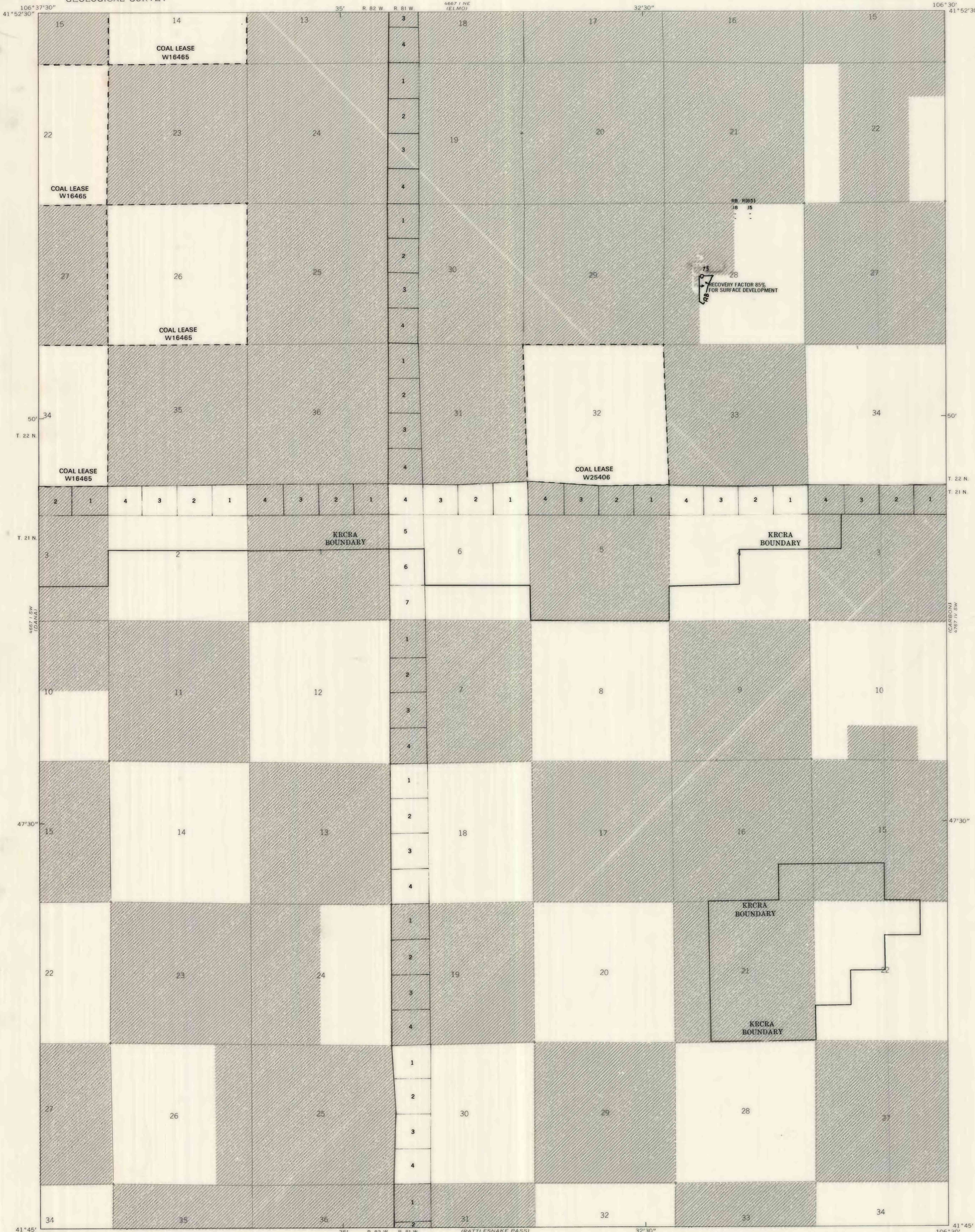

Base map from U.S. Geological Survey, 1971

Compiled in 1977 by TEXAS INSTRUMENTS INCORPORATED

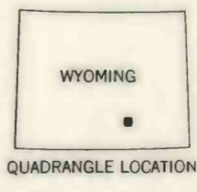
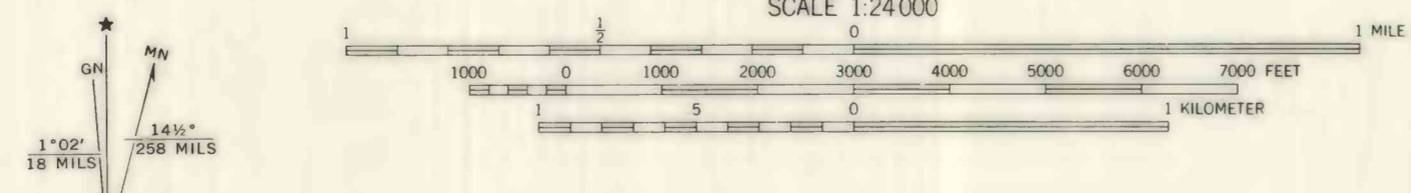

**COAL RESOURCE OCCURRENCE MAP OF THE HANNA QUADRANGLE, CARBON COUNTY, WYOMING BY TEXAS INSTRUMENTS INCORPORATED 1978**

**PLATE 10 AREAL DISTRIBUTION AND IDENTIFIED RESOURCES OF THE HANNA 1 COAL BED**