

UNITED STATES
DEPARTMENT OF THE INTERIOR
GEOLOGICAL SURVEY

HANNA QUADRANGLE
WYOMING-CARBON CO.
7.5 MINUTE SERIES (TOPOGRAPHIC)
SE/4 HANNA 15' QUADRANGLE

EXPLANATION

KRCRA BOUNDARY
KNOWN RECOVERABLE COAL RESOURCE AREA—Area in which the Federal coal land is classified, (1) as subject to the coal leasing provisions of the Mineral Leasing Act of 1920, as amended and, (2) by virtue of the available data being sufficient to permit evaluation as to extent, location, and potential for developing commercial quantities of coal.

NON-FEDERAL COAL LAND—Land for which the Federal Government does not own the coal rights.

COAL LEASE W25406

COAL LEASE—An area of Federal coal lands in which the Federal Government has entered into a contractual agreement for development of the coal deposits.

AREA OF HIGH COAL-DEVELOPMENT POTENTIAL—Mining-ratio values range from 0-10.

AREA OF UNKNOWN COAL-DEVELOPMENT POTENTIAL—Federal coal lands probably underlain by coal, but where no data is available to determine a coal-development potential.

AREA OF NO COAL-DEVELOPMENT POTENTIAL—Federal coal lands not known to be underlain by coal within 8000 feet of the surface.

Coal resource development potentials are given only for leaseable federal coal land within KRCRA boundaries.

OPEN FILE REPORT
This report has not been edited for conformity with U.S. Geological Survey editorial standards or stratigraphic nomenclature.

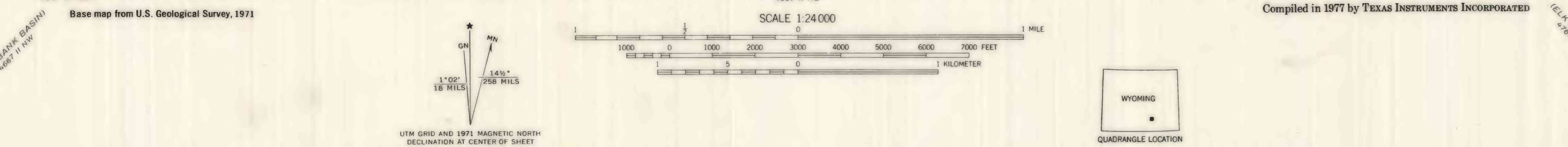
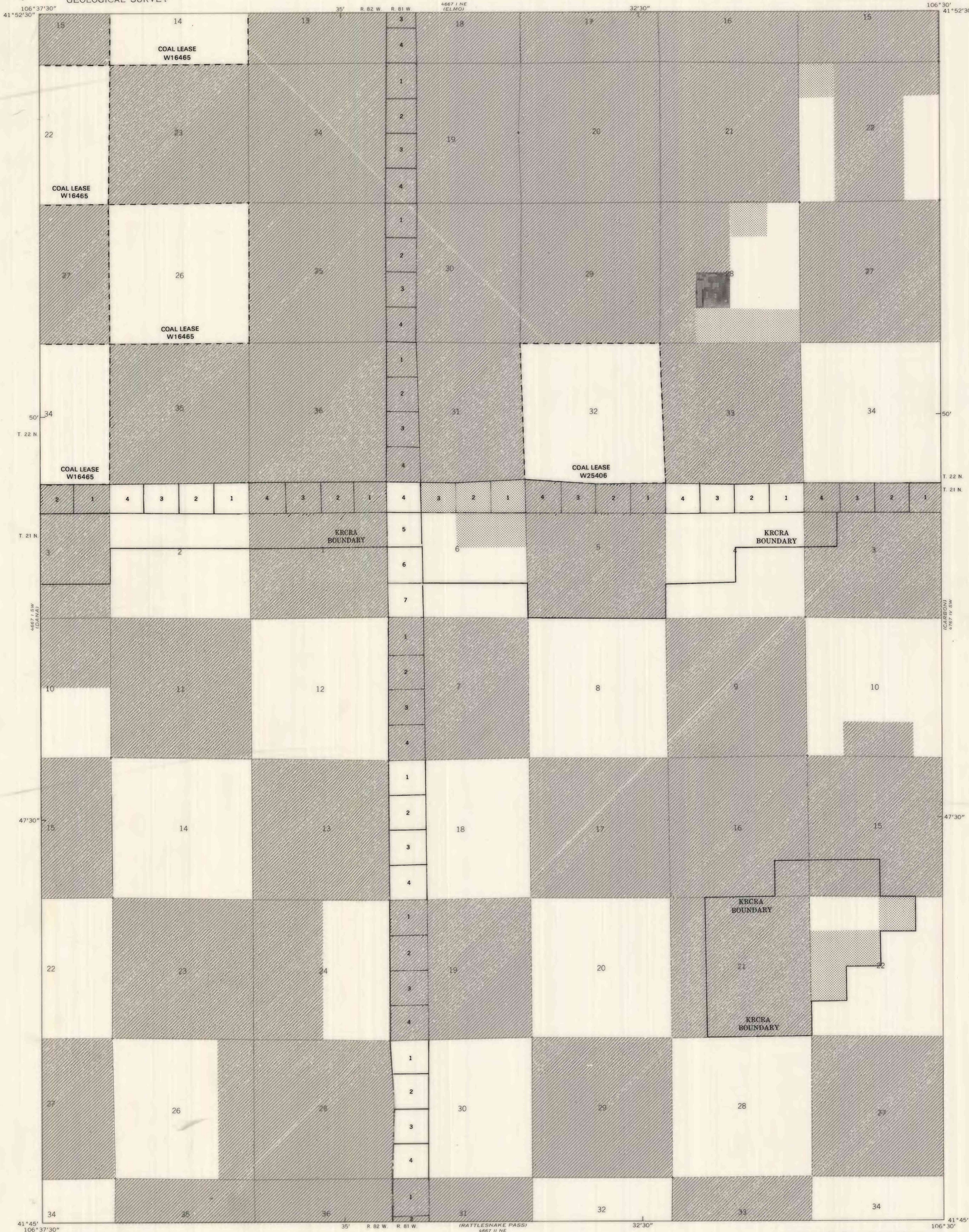

**COAL DEVELOPMENT POTENTIAL MAP OF THE HANNA QUADRANGLE,
CARBON COUNTY, WYOMING
BY
TEXAS INSTRUMENTS INCORPORATED
1978**