

UNITED STATES  
DEPARTMENT OF THE INTERIOR  
GEOLOGICAL SURVEY

TE RANCH QUADRANGLE  
WYOMING-ARBON CO.  
7.5 MINUTE SERIES (TOPOGRAPHIC)

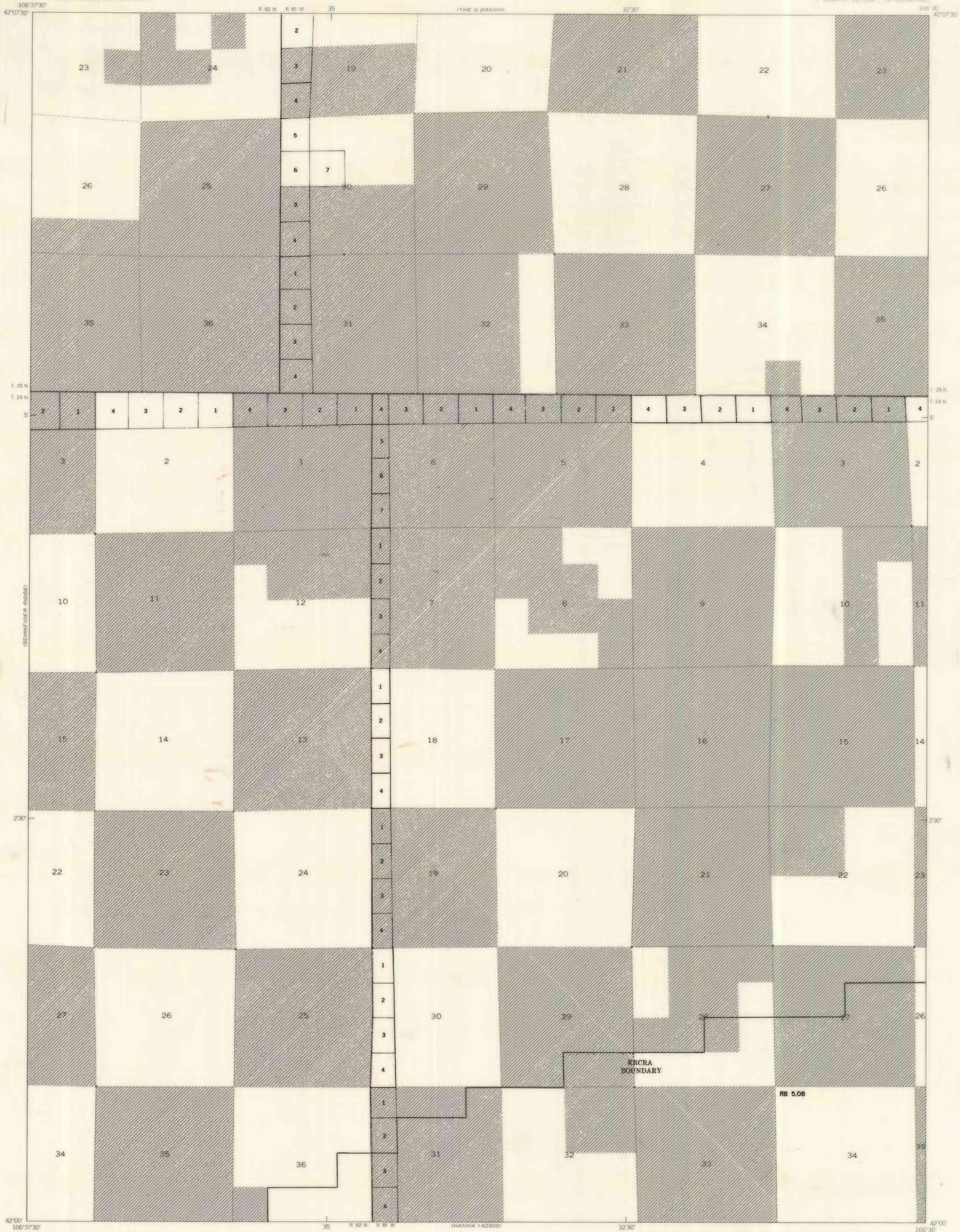

EXPLANATION

**KRCRA BOUNDARY**

KNOWN RECOVERABLE COAL RESOURCE AREA—Area in which the Federal coal land is classified, (1) as subject to the coal leasing provisions of the Mineral Leasing Act of 1920, as amended and, (2) by virtue of the available data being sufficient to permit evaluation as to extent, location, and potential for developing commercial quantities of coal.

**NON-FEDERAL COAL LAND**—Land for which the Federal Government does not own the coal rights.

RB 5.08

**TOTAL RESERVE BASE (RB) OF FEDERAL COAL PER SECTION**—In millions of short tons, calculated for each section of Federal land following guidelines given in U.S. Geol. Survey Bulletin 1450-B. To convert short tons to metric tons, multiply short tons by 0.9072.

4	3	2	1
5			
6			
7			

SECTION OF LAND  
Showing lots and lot numbers

REFERENCE

U.S. Bureau of Mines and U.S. Geological Survey, 1976, Coal resource classification system of the U.S. Bureau of Mines and U.S. Geological Survey: U.S. Geol. Survey Bull. 1450-B, 7 p. Information derived from U.S. Bureau of Land Management Master Title plats and Coal plats issued April 22, 1977, and from oral communication, BLM State Office, Cheyenne, Wyoming.

OPEN FILE REPORT

This report has not been edited for conformity with U.S. Geological Survey editorial standards or stratigraphic nomenclature.

Base map from U.S. Geological Survey, 1953

Compiled in 1977 by TEXAS INSTRUMENTS INCORPORATED

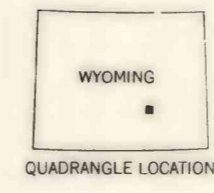
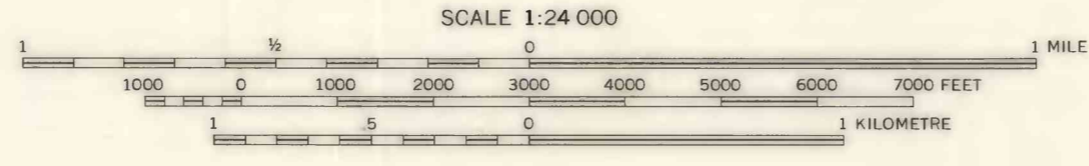
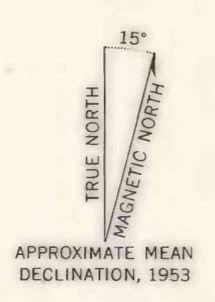

**COAL RESOURCE OCCURRENCE MAP OF THE TE RANCH QUADRANGLE,  
CARBON COUNTY, WYOMING**

**BY  
TEXAS INSTRUMENTS INCORPORATED  
1978**