

UNITED STATES
DEPARTMENT OF THE INTERIOR
GEOLOGICAL SURVEY

T E RANCH QUADRANGLE

1:24,000 SCALE

1:24,000 SCALE

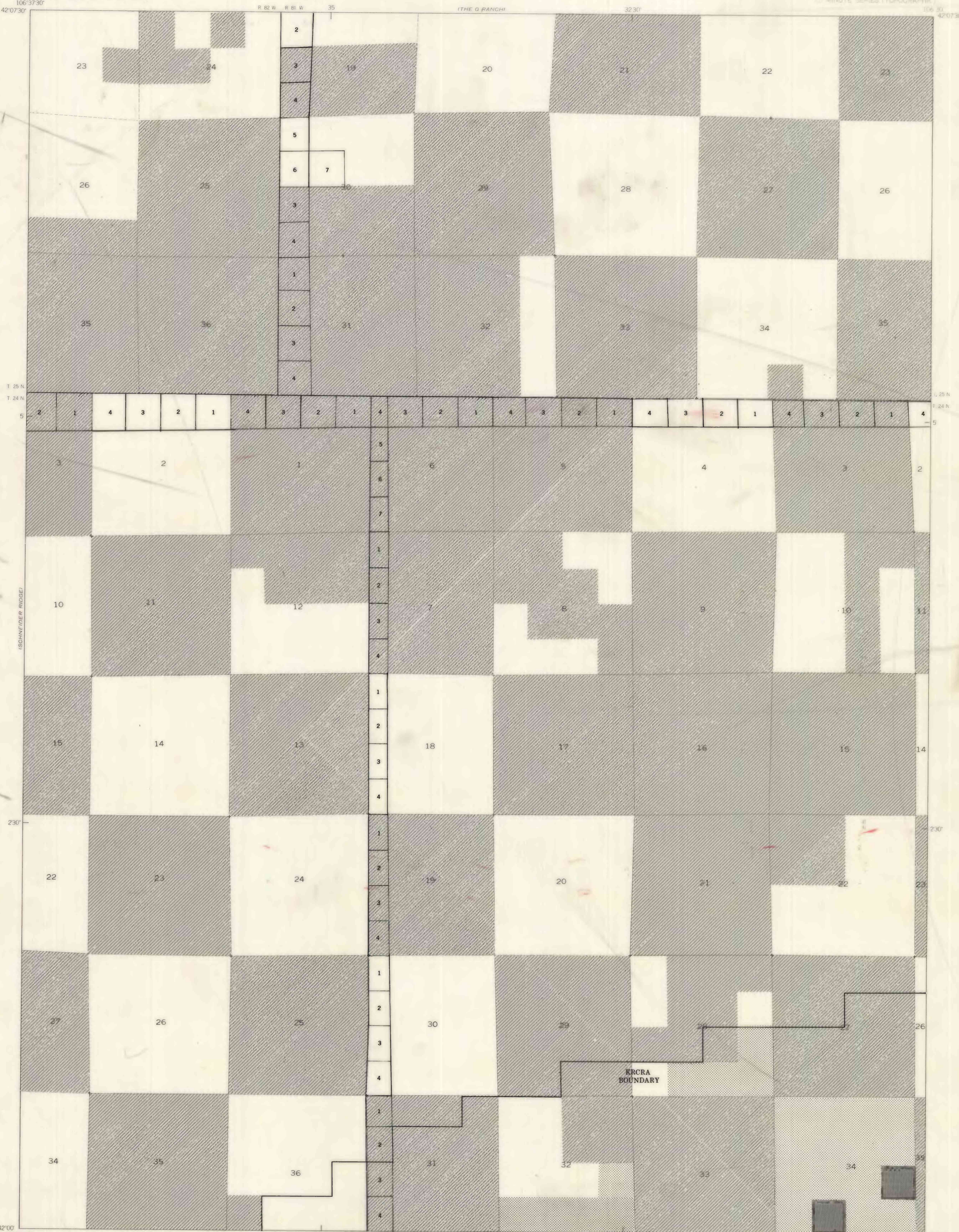

EXPLANATION

KRCRA BOUNDARY

KNOWN RECOVERABLE COAL RESOURCE AREA—Area in which the Federal coal land is classified, (1) as subject to the coal leasing provisions of the Mineral Leasing Act of 1920, as amended and, (2) by virtue of the available data being sufficient to permit evaluation as to extent, location, and potential for developing commercial quantities of coal.

NON-FEDERAL COAL LAND—Land for which the Federal Government does not own the coal rights.

AREA OF HIGH COAL-DEVELOPMENT POTENTIAL

AREA OF UNKNOWN COAL-DEVELOPMENT POTENTIAL—Federal coal lands probably underlain by coal, but where no data is available to determine a coal-development potential.

AREA OF NO COAL-DEVELOPMENT POTENTIAL—Federal coal lands not known to be underlain by coal within 3000 feet of the surface.

Coal resource development potentials are given only for leaseable federal coal land within KRCRA boundaries.

OPEN FILE REPORT

This report has not been edited for conformity with U.S. Geological Survey editorial standards or stratigraphic nomenclature.

Base map from U.S. Geological Survey, 1953

Compiled in 1977 by TEXAS INSTRUMENTS INCORPORATED

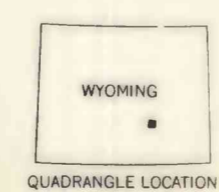
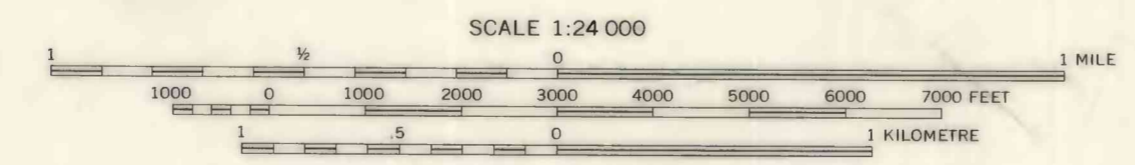
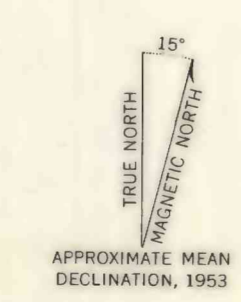

COAL DEVELOPMENT POTENTIAL MAP OF THE TE RANCH QUADRANGLE,
CARBON COUNTY, WYOMING

BY
TEXAS INSTRUMENTS INCORPORATED
1978

PLATE 10
COAL DEVELOPMENT POTENTIAL
FOR
SUBSURFACE MINING METHODS