

(200)
R295
W. 78-106A



UNITED STATES (DEPARTMENT OF THE INTERIOR)

GEOLOGICAL SURVEY. [Reports - Open file series]

Telluric traverse location map and profiles
for Double Hot Springs Known Geothermal
Resource Area, Nevada

TM
Em
Twards

By

Robert
Michael
Donald
1930-
Karen R.
R. M. Senterfit, D. B. Hoover, and K. Christopherson

Open-File Report 78-106A

1978

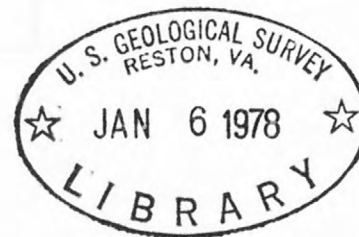

This report is preliminary and has not been
edited or reviewed for conformity with U.S.
Geological Survey standards and nomenclature.

283076

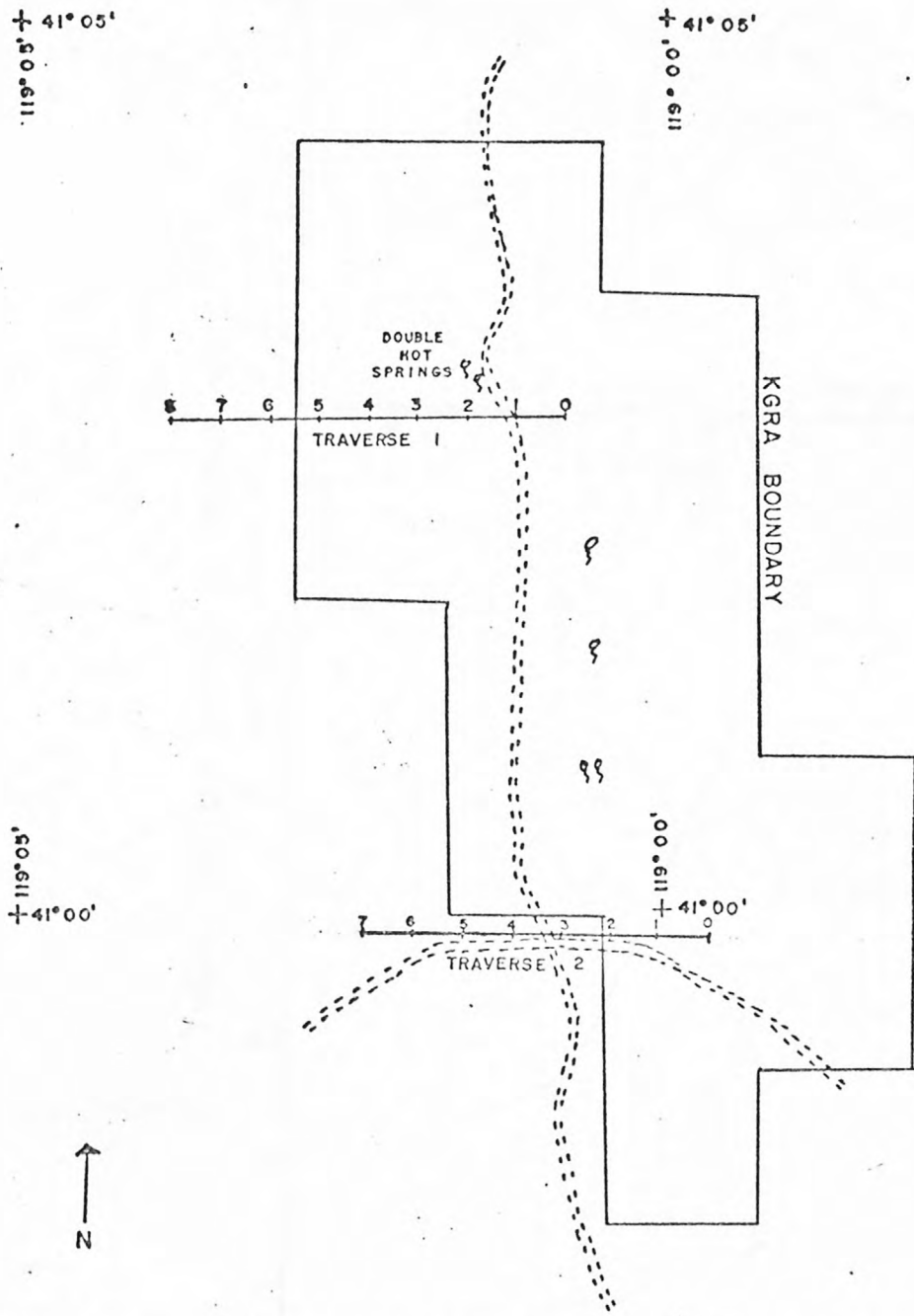
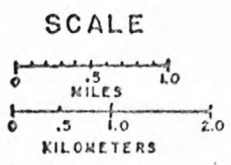

FIGURE 1. TELLURIC PROFILES STATION LOCATION MAP
 DOUBLE HOT SPRINGS KNOWN GEOTHERMAL RESEARCH AREA, NEVADA



1977
 BY
 R.M. SENTERFIT, D.B. HOOVER & K. CHRISTOPHERSON

LEGEND
 ⌘ SPRINGS
 —•— PROFILE STATIONS

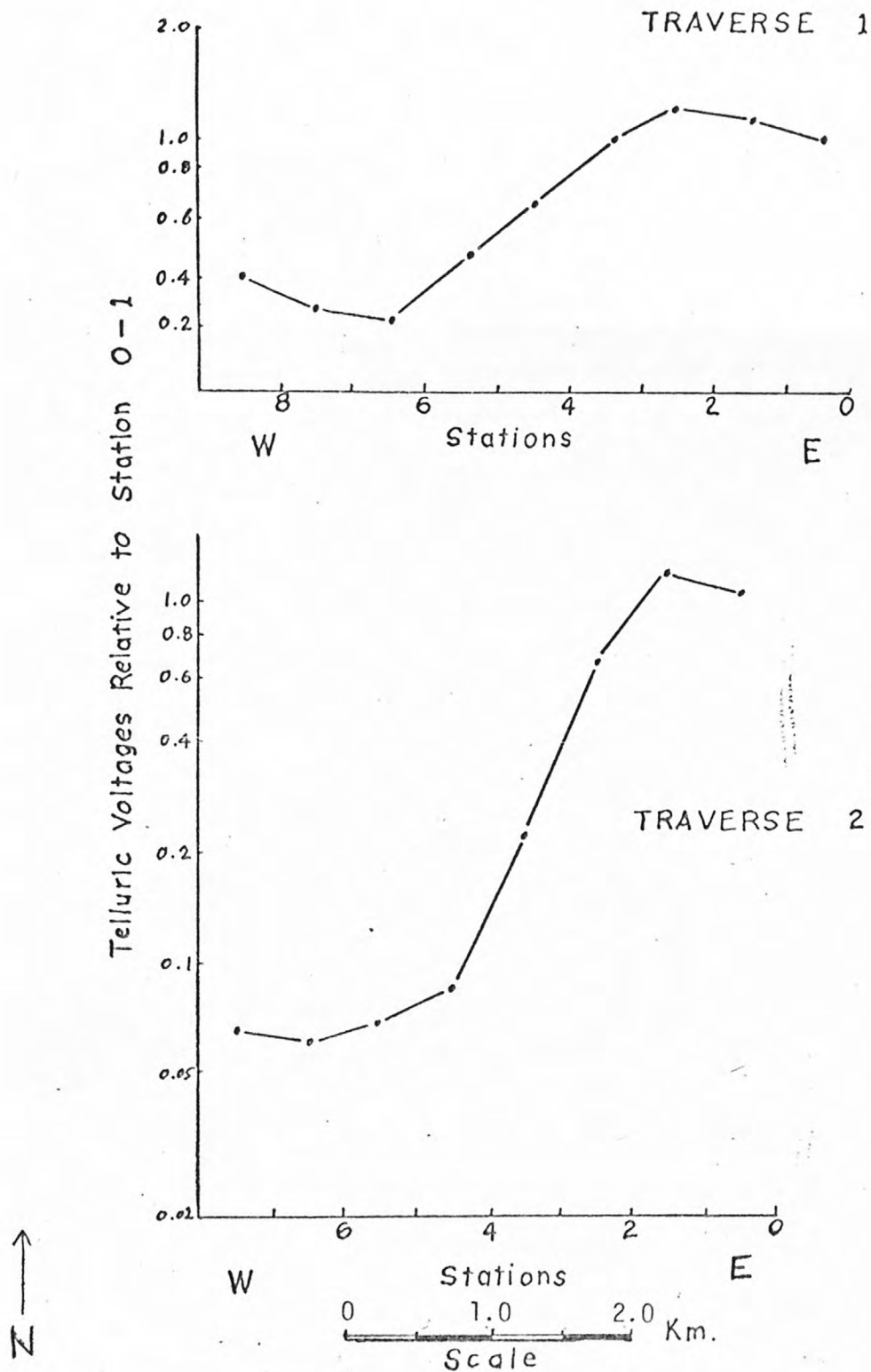

FIGURE 2. TELLURIC PROFILES

DOUBLE HOT SPRINGS KGRA - NEVADA



3 1818 00073180 0



FIGURE 1. TELLURIC PROFILES