

EXPLANATION

—200—
OVERBURDEN ISOPACHS - Showing thickness of overburden, in feet, from surface to top of coal bed. Dashed where vertical accuracy possibly not within 40 feet. Isopach interval 100 feet (30.48 m).

○ 115
DRILL HOLE - Showing thickness of overburden, in feet, from surface to top of coal bed.

—15—
MINING-RATIO CONTOUR - Number indicates cubic yards of overburden per ton of recoverable coal by surface mining methods. Contours shown only in areas underlain by coal of Reserve Base thickness within the stripping-limit (in this quadrangle, the 200-foot-overburden isopach).

FU[13] - Fort Union, undifferentiated
FU[12] - Fort Union, undifferentiated

COAL BED SYMBOLS AND NAMES - Coal beds identified by bracketed numbers are not formally named, but are numbered for identification purposes in this quadrangle only.

To convert feet to meters, multiply feet by 0.3048.

To convert mining ratio to cubic meters of overburden per metric ton of recoverable coal, multiply mining ratio by 0.8428.

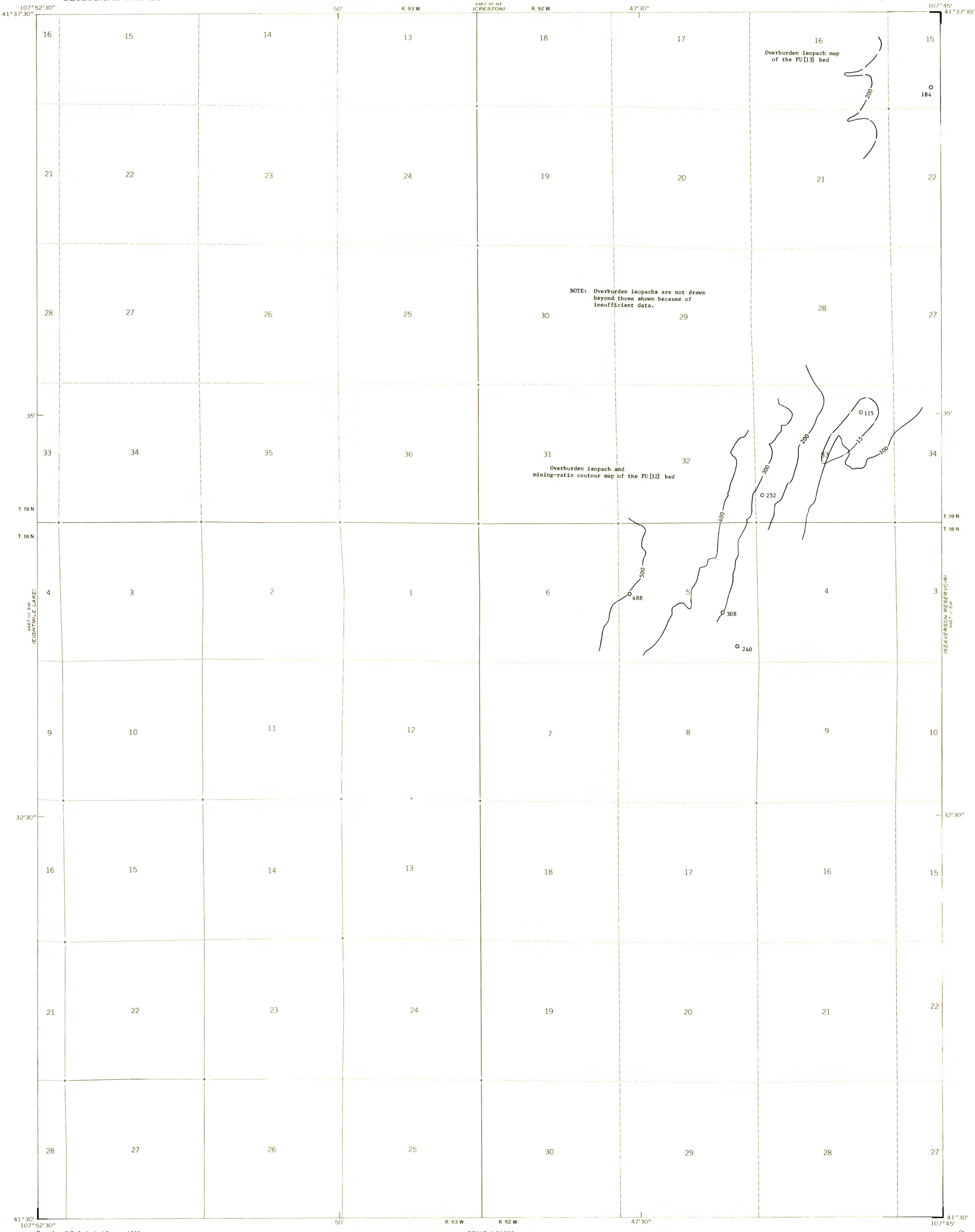

NOTE: Overburden isopachs are not drawn beyond those shown because of insufficient data.

Overburden isopach and mining-ratio contour map of the FU [12] bed

Overburden isopach map of the FU[13] bed

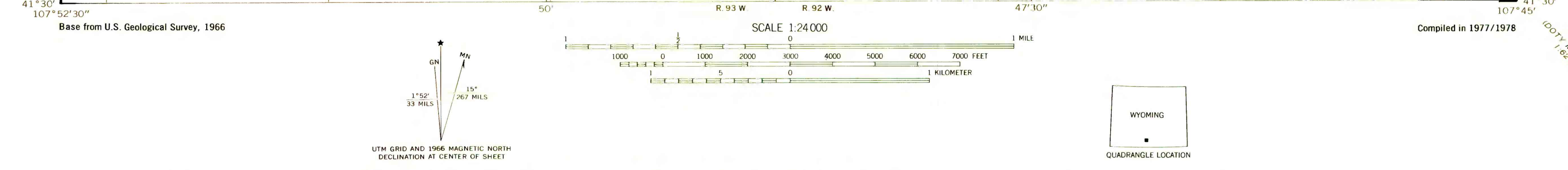

**COAL RESOURCE OCCURRENCE MAP OF THE HIGH POINT
QUADRANGLE, CARBON COUNTY, WYOMING
BY
DAMES & MOORE
1978**

This report has not been edited for conformity with U.S. Geological Survey editorial standards or stratigraphic nomenclature.