

EXPLANATION

— 6500 —
— 6600 —
STRUCTURE CONTOURS - Drawn on top of coal bed. Solid where vertical accuracy within 40 feet; long dashed where vertical accuracy possibly not within 40 feet; short dashed where projected above ground surface. Contour interval is 100 feet (30.5 m). Datum is mean sea level.

○ 7027
DRILL HOLE - Showing altitude of top of coal bed, in feet.

B - B (Fillmore Ranch) of Lower Fort Union Coal Zone

COAL BED SYMBOL AND NAME
B

TRACE OF COAL BED OUTCROP - Showing symbol of name of coal bed as listed above. Dashed where inferred; short dashed where inferred by present authors.

To convert feet to meters, multiply feet by 0.3048.

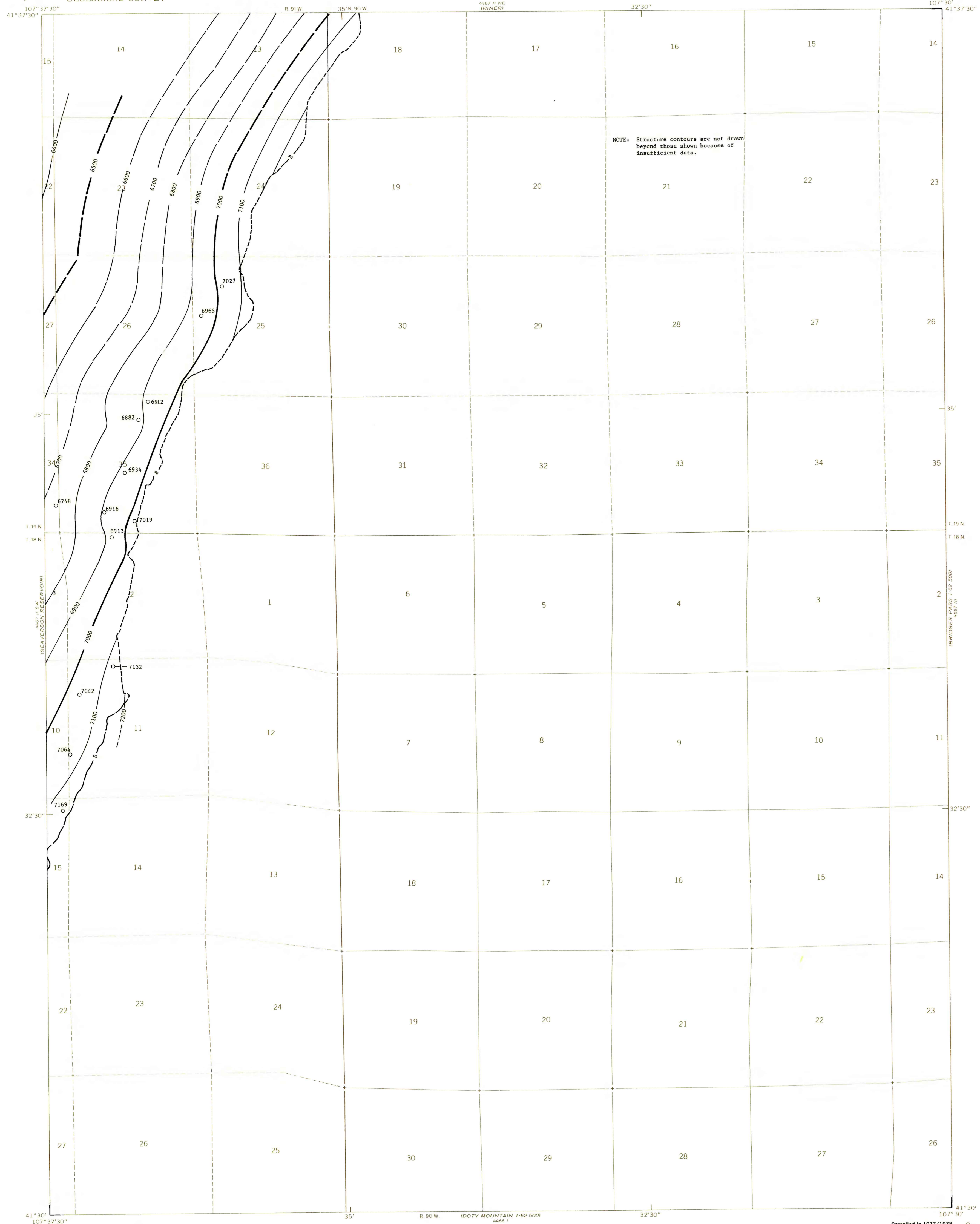

Base from U.S. Geological Survey, 1966

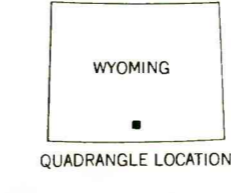
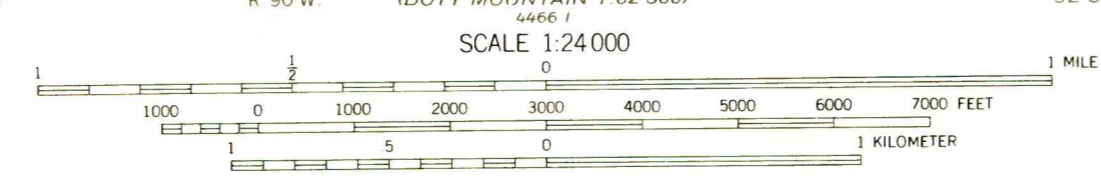
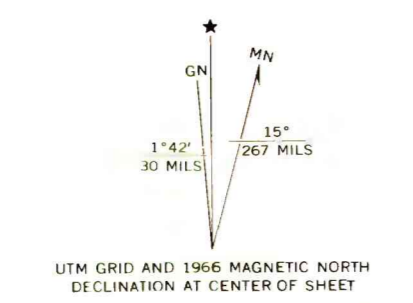

**COAL RESOURCE OCCURRENCE MAP OF THE FILLMORE RANCH
QUADRANGLE, CARBON COUNTY, WYOMING
BY
DAMES & MOORE
1978**

This report has not been edited for conformity with U.S. Geological Survey editorial standards or stratigraphic nomenclature.