

4556 I
1:62,500

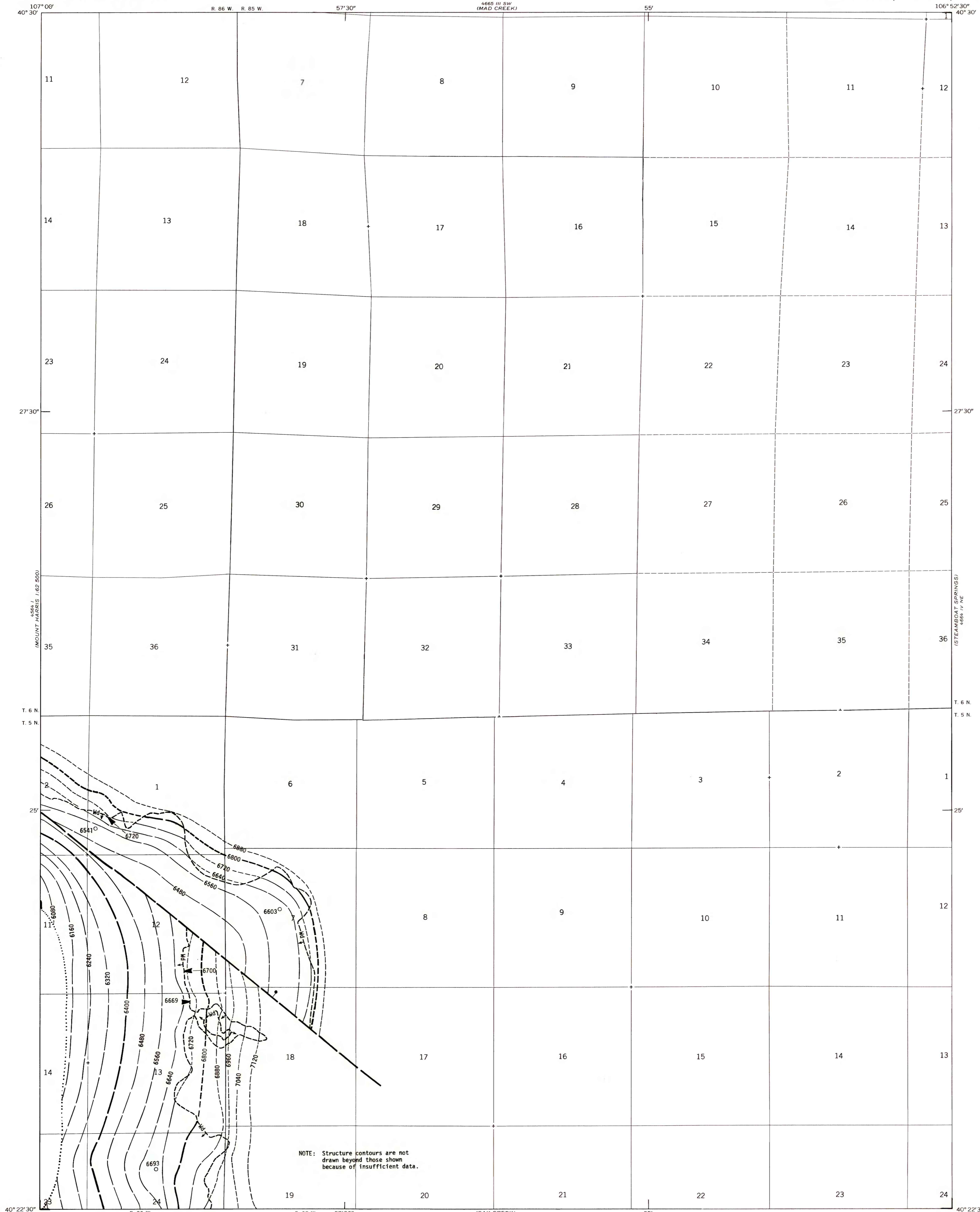

EXPLANATION

6400 ————
6480 ————

STRUCTURE CONTOURS - Drawn on top of coal bed or zone. Solid where vertical accuracy within 80 feet; long dashed where vertical accuracy possibly not within 80 feet; short dashed where projected above ground surface. Contour interval is 80 feet (24.4 m). Datum is mean sea level.

○ 6541
○ 6603

DRILL HOLE - Showing altitude of top of coal bed, in feet.

▲ 6700

POINT OF MEASUREMENT - Showing altitude of top of coal bed, in feet. Includes all points of measurement other than drill holes.

Wd - Wadge
COAL BED SYMBOL AND NAME

——— Wd ———

TRACE OF COAL BED OUTCROP - Showing symbol of name of coal bed as listed above. Arrow points toward coal-bearing area. Short dashed where inferred by present authors.

———

TRACE OF FAULT - Bar and ball on down-thrown side when direction of movement is known. Dashed where inferred or approximately located.

To convert feet to meters, multiply feet by 0.3048.

NOTE: Structure contours are not drawn beyond those shown because of insufficient data.

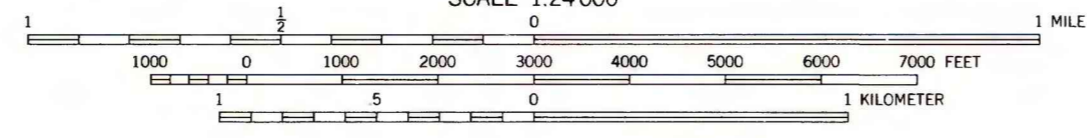
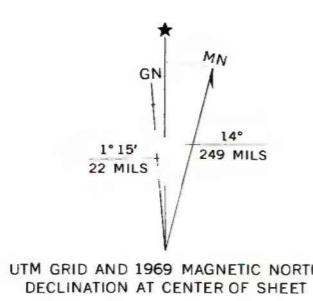

COAL RESOURCE OCCURRENCE MAP OF THE COW CREEK QUADRANGLE, ROUTT COUNTY, COLORADO

BY
DAMES & MOORE
1978

This report has not been edited for conformity with U.S. Geological Survey editorial standards or stratigraphic nomenclature.