

EXPLANATION

600  
OVERBURDEN ISOPACHS - Showing thickness of overburden, in feet, from the surface to the top of the coal bed. Dashed where vertical accuracy possibly not within 80 feet. Isopach interval is 100 feet (30.48 m) over strippable coal and 200 feet (60.96 m) beyond the stripping-limit line.

○ 267  
DRILL HOLE - Showing thickness of overburden, in feet, from the surface to the top of the coal bed.

10  
MINING-RATIO CONTOUR - Number indicates cubic yards of overburden per ton of recoverable coal by surface mining methods. Contours shown only in areas underlain by coal of Reserve Base thickness within the stripping-limit (in this quadrangle, the 200-foot-overburden isopach).

Wd - Wadge  
COAL BED SYMBOL AND NAME  
-----Wd-----  
TRACE OF COAL BED OUTCROP - Showing symbol of name of coal bed as listed above. Short dashed where inferred by present authors.

To convert feet to meters, multiply feet by 0.3048.

To convert mining ratio to cubic meters of overburden per metric ton of recoverable coal, multiply mining ratio by 0.8428.

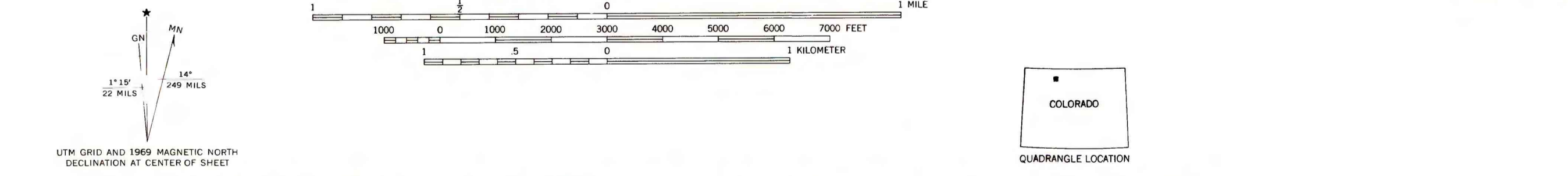
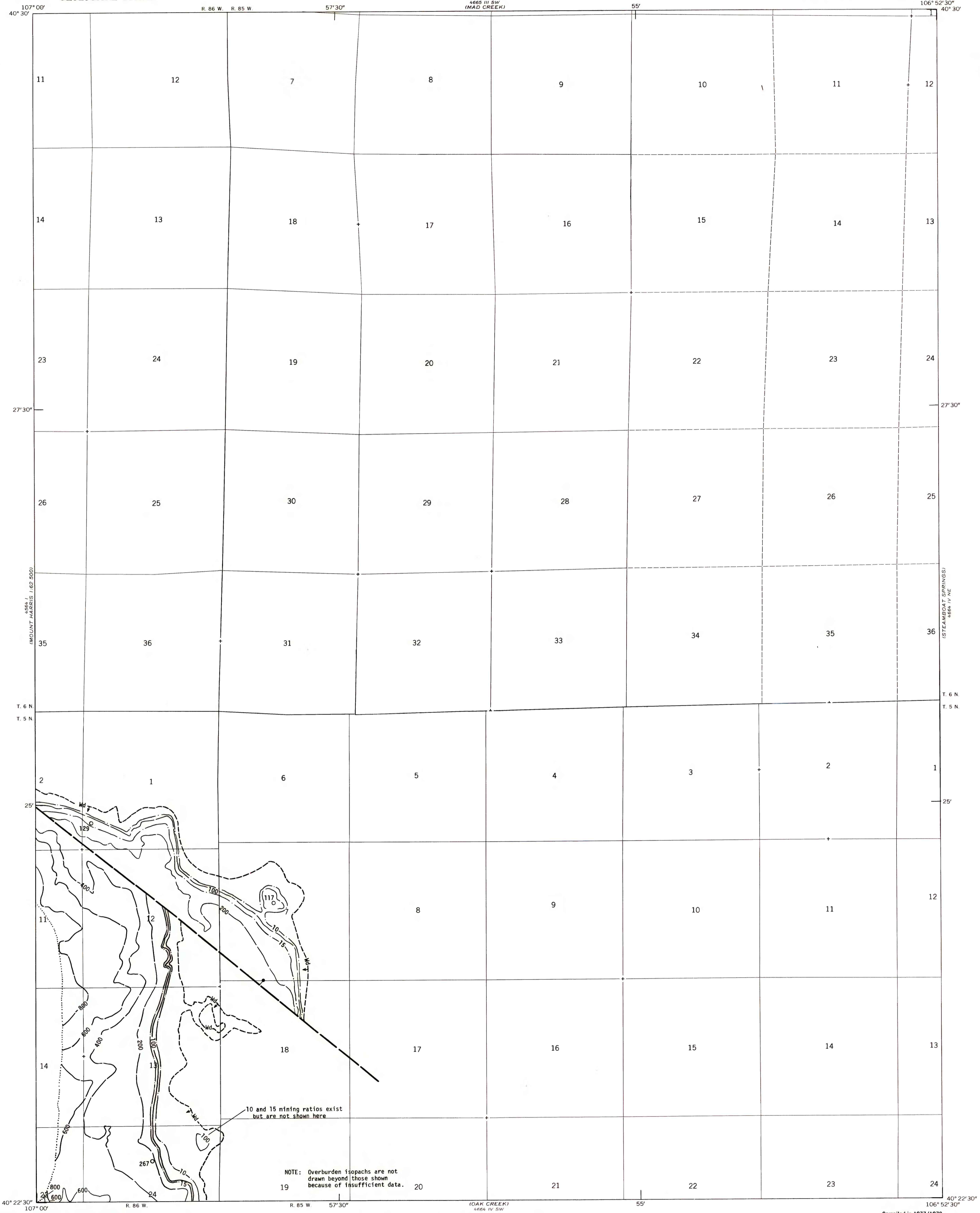

**COAL RESOURCE OCCURRENCE MAP OF THE COW CREEK  
QUADRANGLE, ROUTT COUNTY, COLORADO  
BY  
DAMES & MOORE  
1978**

This report has not been edited for conformity with U.S. Geological Survey editorial standards or stratigraphic nomenclature.