

107° 00' 00" W
40° 30' 00" N

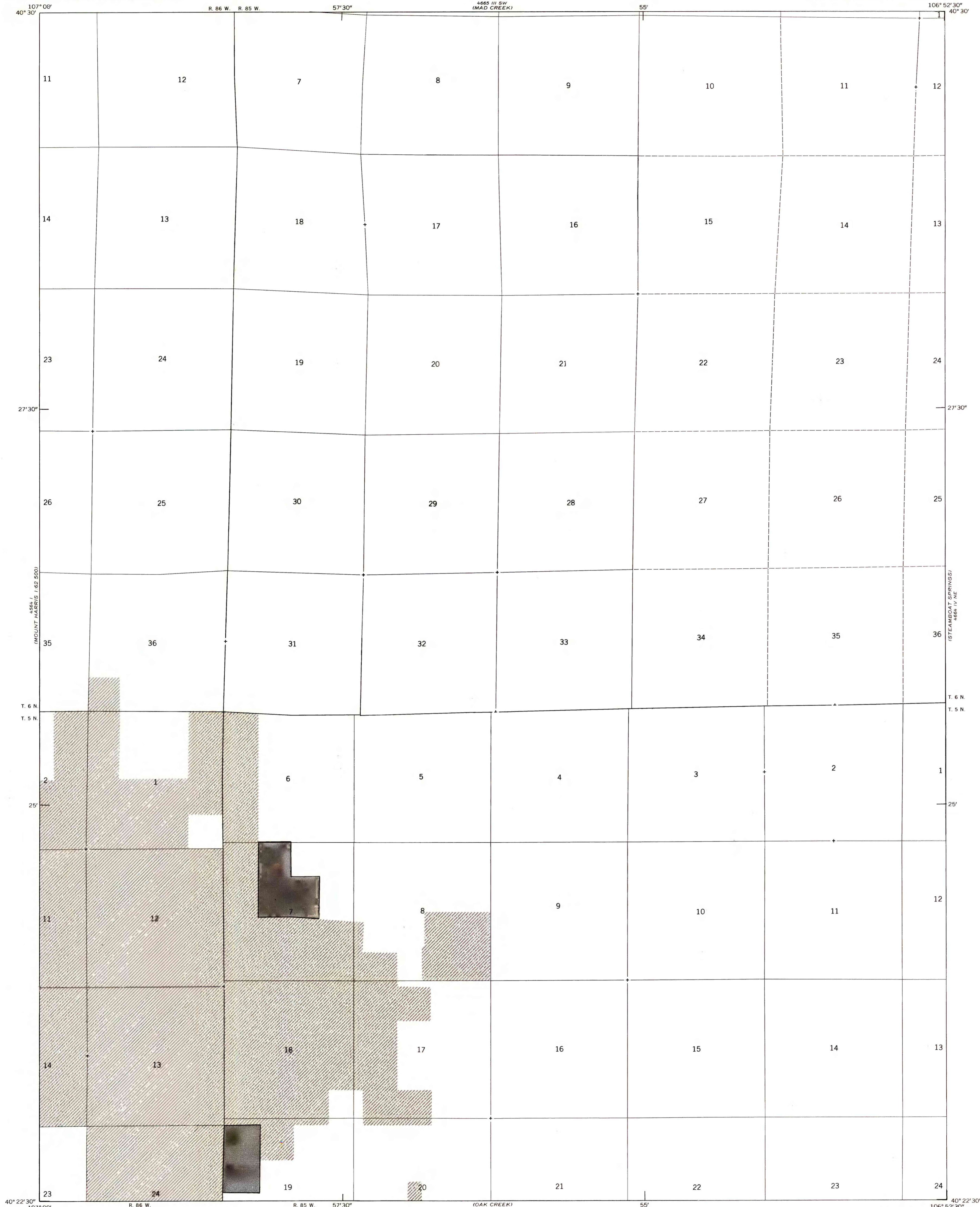

EXPLANATION



NON-FEDERAL COAL LAND - Land for which the Federal Government does not own the coal rights, and for which the coal-development potential is not rated.

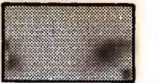

AREA OF HIGH COAL-DEVELOPMENT POTENTIAL - Area has mining-ratio values ranging from 0 to 10.



AREA OF UNKNOWN COAL-DEVELOPMENT POTENTIAL - Area contains no known coal in beds 5 feet (1.5 m) or more thick within 200 feet (61 m) of the surface, but coal-bearing units are present in the area.

Base from U.S. Geological Survey, 1969

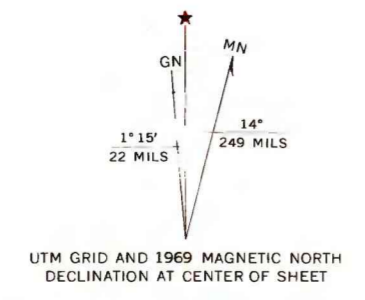
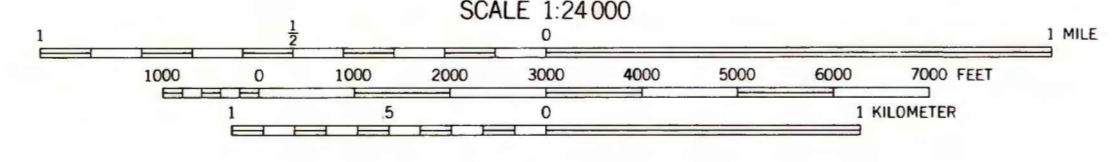

Compiled in 1977/1978

**COAL DEVELOPMENT POTENTIAL MAP OF THE COW CREEK
QUADRANGLE, ROUTT COUNTY, COLORADO**

**BY
DAMES & MOORE
1978**

This report has not been edited for conformity with U.S. Geological Survey editorial standards or stratigraphic nomenclature.