

This report has not been edited for conformity with U.S. Geological Survey editorial standards or stratigraphic nomenclature.

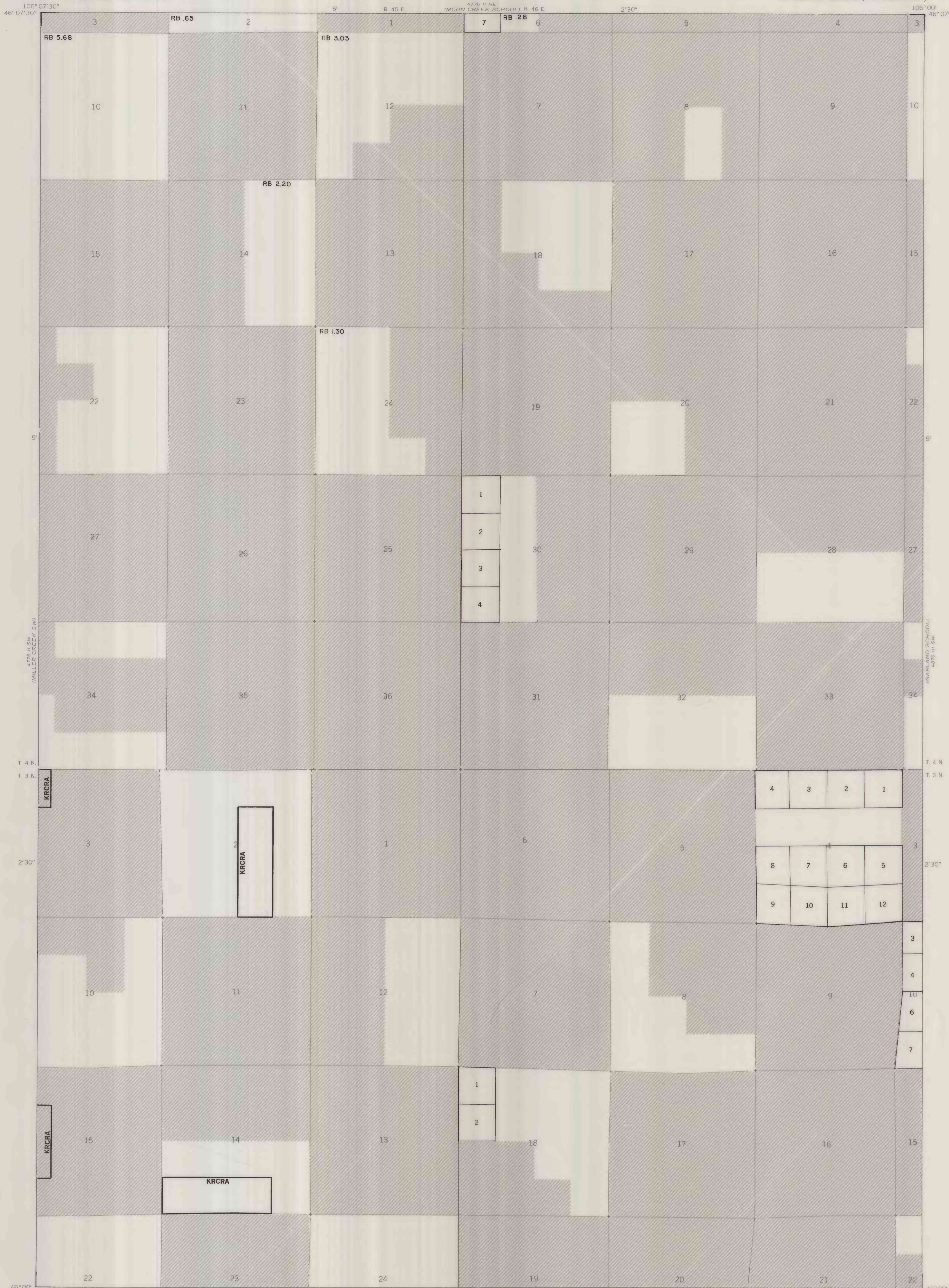

EXPLANATION

KRCRA  
BOUNDARY OF KNOWN RECOVERABLE COAL RESOURCE AREA (KRCRA)—Area of KRCRA indicated by label.

NON-FEDERAL COAL LAND—Land for which the Federal Government does not own the coal rights.

RB 3.03

TOTAL RESERVE BASE (RB) OF COAL PER SECTION—In millions of short tons, calculated for each section of Federal land following the guidelines given in U.S. Geol. Survey Bulletin 1450-B (1976). To convert short tons to metric tons, multiply short tons by 0.9072.

4	3	2	1
5	6		
6			
7			

SECTION OF LAND—Showing lots and lot numbers.

NOTE: BLM coal plat data indicating areas of coal ownership current as of August 9, 1977.

REFERENCE

U.S. Bureau of Mines and U.S. Geological Survey, 1976, Coal resource classification system of the U.S. Bureau of Mines and U.S. Geological Survey: U.S. Geol. Survey Bull. 1450-B, 7 p.

Base map from U.S. Geological Survey, 1969

Compiled in 1977

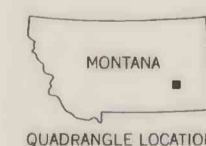
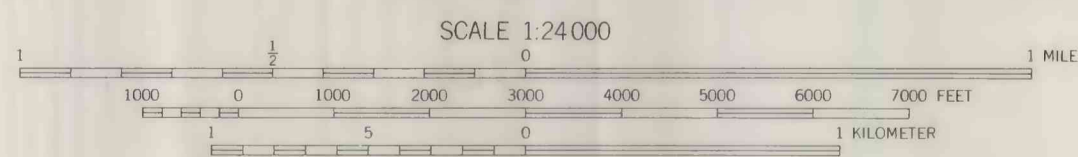
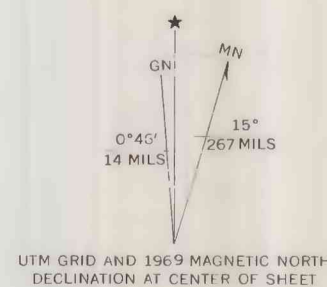

COAL RESOURCE OCCURRENCE MAP OF THE MILLER CREEK  
QUADRANGLE, CUSTER COUNTY, MONTANA  
BY  
COLORADO SCHOOL OF MINES RESEARCH INSTITUTE  
1978