

JACK CREEK NW 1/4
JACK CREEK NW 1/4

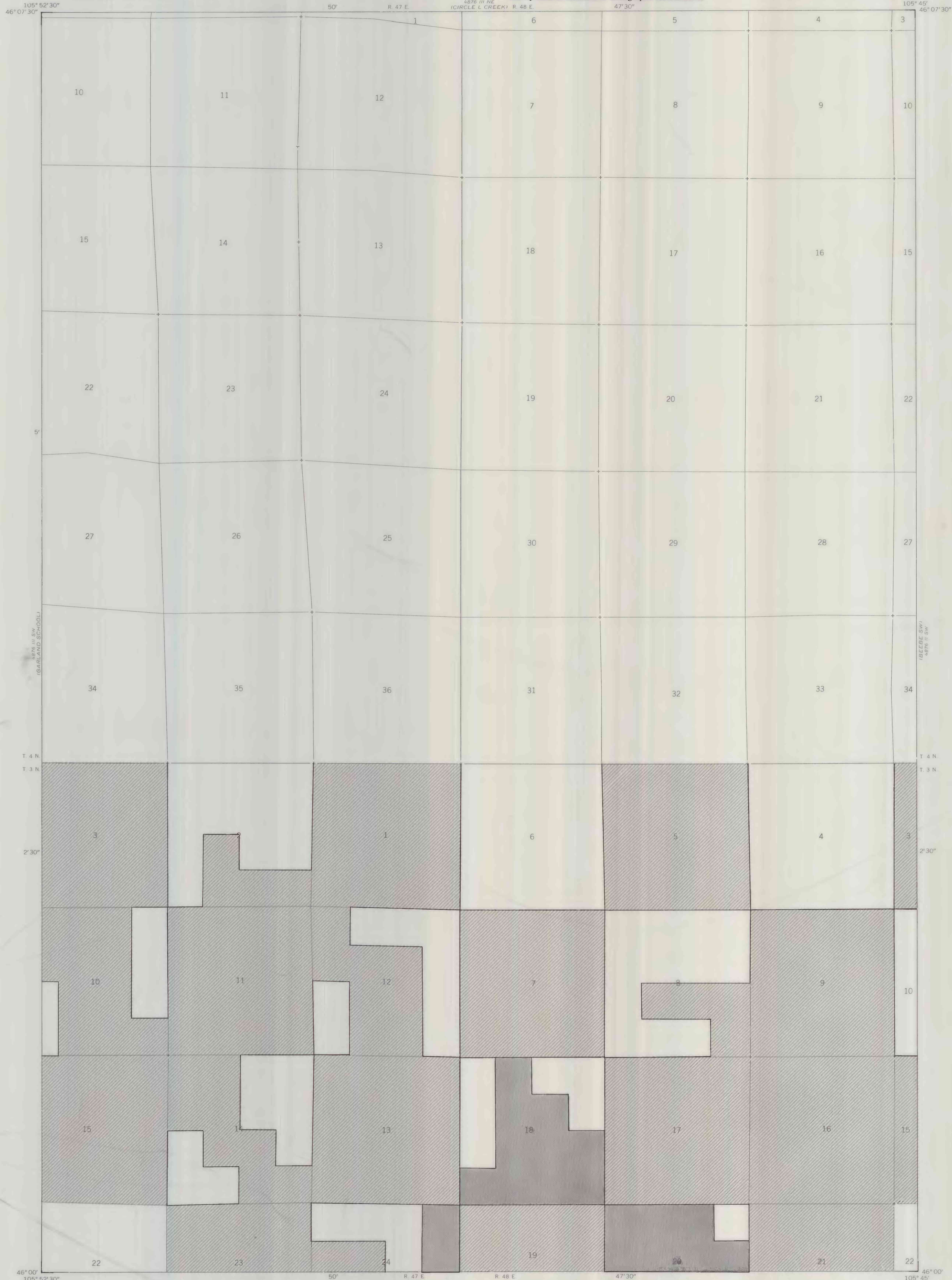
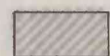
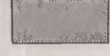
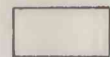

EXPLANATION

-  NON-FEDERAL COAL LAND—Land for which the Federal Government does not own the coal rights and for which the coal-development potential is not rated.
-  AREA OF HIGH COAL-DEVELOPMENT POTENTIAL—Area has mining-ratio values ranging from 0 to 10.
-  AREA WITH NO COAL-DEVELOPMENT POTENTIAL FOR SURFACE MINING—Area contains no known coal in beds 5 feet (1.5 m) or more thick within 200 feet (61 m) of the surface.

Base map from U.S. Geological Survey, 1969

SCALE 1:24,000

Compiled in 1977

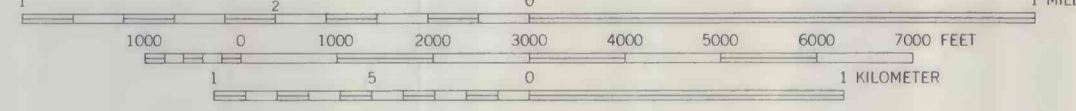
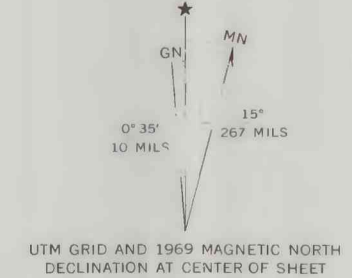

COAL DEVELOPMENT POTENTIAL MAP OF THE JACK CREEK QUADRANGLE,
CUSTER COUNTY, MONTANA

BY
COLORADO SCHOOL OF MINES RESEARCH INSTITUTE
1978