

This report has not been edited for conformity with  
U.S. Geological Survey editorial standards or  
stratigraphic nomenclature.

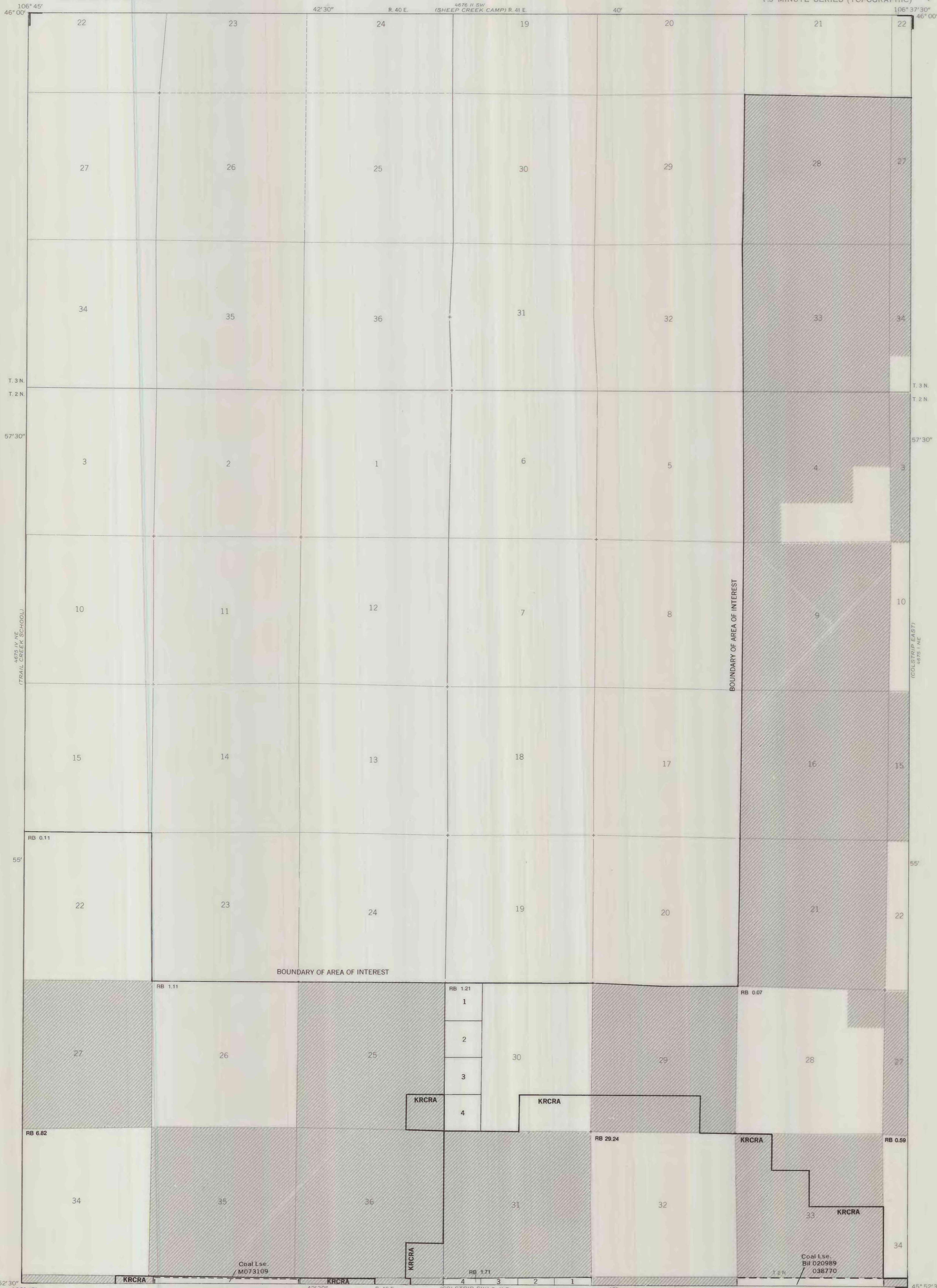

EXPLANATION

**KRCRA**  
BOUNDARY OF KNOWN RECOVERABLE COAL  
RESOURCE AREA (KRCRA)—Area of KRCRA indi-  
cated by label.

NON-FEDERAL COAL LAND—Land for which the Federal  
Government does not own the coal rights.

**RB 29.24**

**TOTAL RESERVE BASE (RB) OF COAL PER SECTION—**  
In millions of short tons, calculated for each section of  
Federal land following the guidelines given in U.S. Geol.  
Survey Bulletin 1450-B (1976). To convert short tons to  
metric tons, multiply short tons by 0.9072.

4	3	2	1
5	6		
6			
7			

SECTION OF LAND—Showing lots and lot numbers.

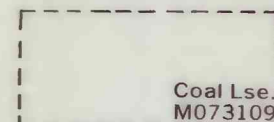

AREA OF COAL LEASE ON FEDERAL COAL LAND—  
Showing coal lease number. Area of Federal coal lands  
on which the Federal Government has entered into a  
contractual agreement for development of the coal  
deposits.

NOTE: BLM coal plat data indicating areas of coal ownership  
current as of August 9, 1977.

REFERENCE

U.S. Bureau of Mines and U.S. Geological Survey, 1976, Coal  
resource classification system of the U.S. Bureau of Mines  
and U.S. Geological Survey: U.S. Geol. Survey Bull.  
1450-B, 7 p.

Base map from U.S. Geological Survey, 1971

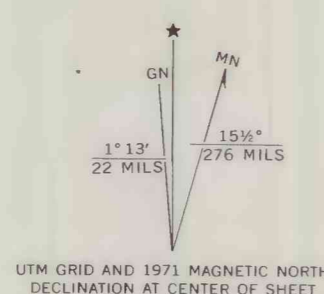

UTM GRID AND 1971 MAGNETIC NORTH  
DECLINATION AT CENTER OF SHEET

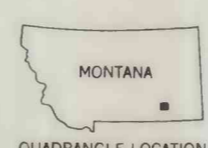
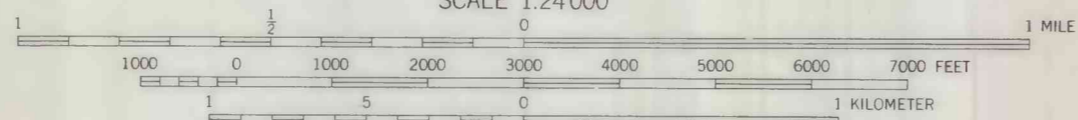

QUADRANGLE LOCATION

COAL RESOURCE OCCURRENCE MAP OF THE COLSTRIP WEST QUADRANGLE,  
ROSEBUD COUNTY, MONTANA

BY  
COLORADO SCHOOL OF MINES RESEARCH INSTITUTE  
1978

PLATE 2  
BOUNDARY AND COAL  
DATA MAP