

EXPLANATION



NON-FEDERAL COAL LAND--Land for which the Federal Government does not own the coal rights.

RB 146.0

TOTAL RESERVE BASE (RB) OF COAL PER SECTION--In millions of short tons, calculated for each section of Federal land following the guidelines given in U.S. Geol. Survey Bulletin 1450-B. To convert Short tons to metric tons, multiply by 0.907.

4	3	2	1
5	6		
6	7		
7	8		

SECTION OF LAND--Showing lots and lot numbers.

REFERENCE

U.S. Bureau of Mines and U.S. Geological Survey, 1976, Coal resource classification system of the U.S. Bureau of Mines and U.S. Geological Survey: U.S. Geol. Survey Bull. 1450-B, 7 p.

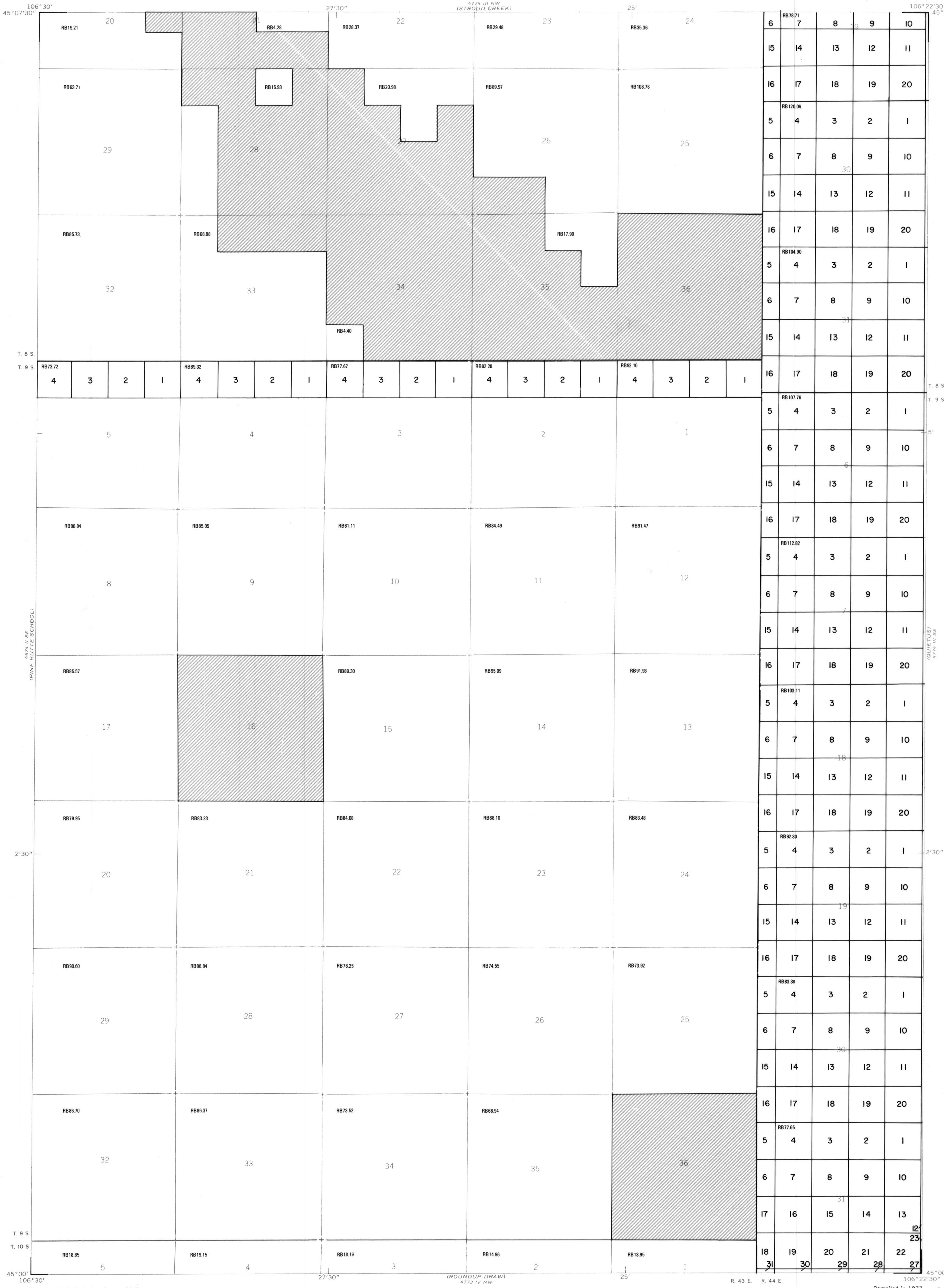

Base from U.S. Geological Survey, 1972

SCALE 1:24 000

R. 43 E. R. 44 E.

Compiled in 1977

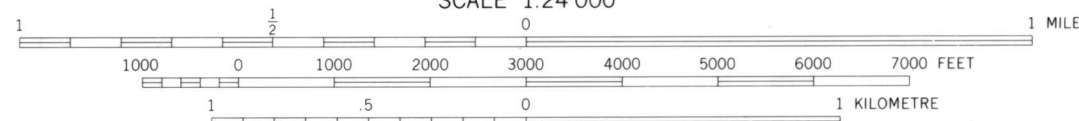
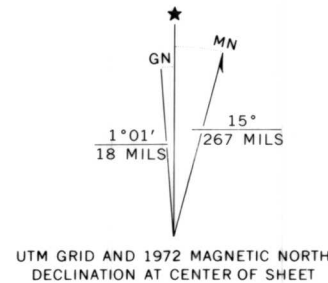

COAL RESOURCE OCCURRENCE AND COAL DEVELOPMENT POTENTIAL
MAPS OF THE FORKS RANCH QUADRANGLE, BIG HORN COUNTY, MONTANA

By
W. C. CULBERTSON, L. N. ROBINSON, AND T. M. GAFFKE
1979