

EXPLANATION

— 16 —
ISOPACHS OF THE COAL BED—
Showing thickness, in feet.
Isopach interval 1 foot.

○ 17
DRILL HOLE—Showing thickness
of coal bed, in feet.

To convert feet to meters,
multiply by 0.3.

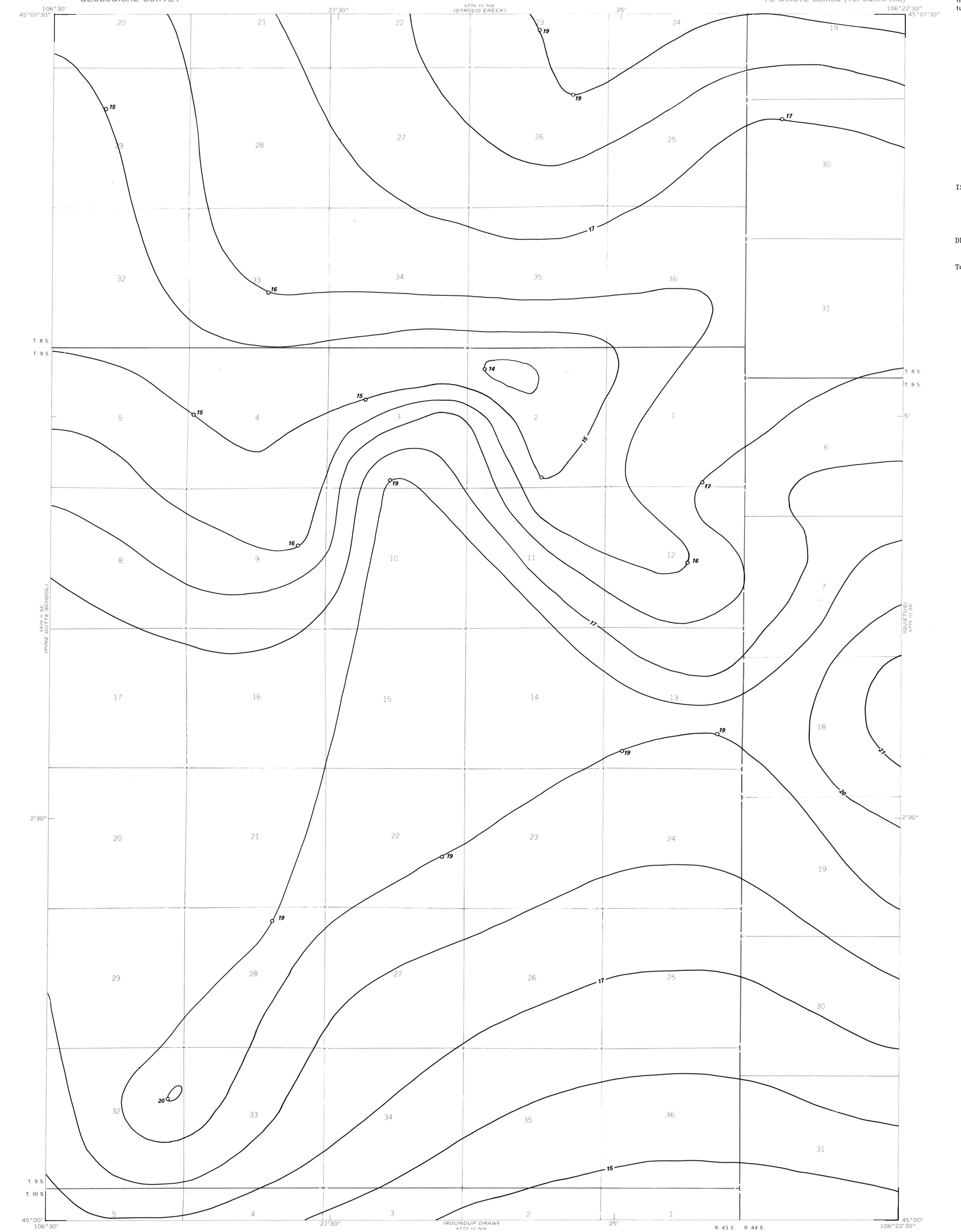

COAL RESOURCE OCCURRENCE AND COAL DEVELOPMENT POTENTIAL
MAPS OF THE FORKS RANCH QUADRANGLE, BIG HORN COUNTY, MONTANA

By
W. C. CULBERTSON, L. N. ROBINSON, AND T. M. GAFFKE
1979