

EXPLANATION

NON-FEDERAL COAL LAND--Land for  
which the Federal Government  
does not own the coal rights.

← SL →  
STRIPPING LIMIT LINE--Boundary  
for surface mining of the  
coal bed (in this quadrangle,  
the 200-foot-overburden iso-  
pach). Arrows point toward  
the area suitable for surface  
mining. Recovery factor of  
85 percent within that area  
in this quadrangle.

RB	RI 85%	(Measured resources)
0.05	0.04	(Indicated resources)
0.11	0.09	(Inferred resources)

IDENTIFIED STRIPPABLE COAL  
RESOURCES--Showing totals  
for Reserve Base (RB) and  
Reserves (R), in millions of  
short tons, for each section  
or part(s) of section of  
Federal coal land within the  
stripping-limit line. Dash  
indicates no resources in  
that category. Reserve Base  
(RB) x the Recovery Factor  
(85 percent) = Reserves (R).

RB	(Measured resources)
0.05	(Indicated resources)
0.11	(Inferred resources)

IDENTIFIED NON-STRIPPABLE COAL  
RESOURCES--Showing totals for  
Reserve Base (RB), in mil-  
lions of short tons, for each  
section or part(s) of section  
of Federal coal land outside  
the stripping-limit line.  
Dash indicates no resources  
in that category.

Recovery factors have not been  
established for underground  
development of coal in this  
quadrangle. Therefore,  
Reserves (R) were not calcu-  
lated for the coal bed in  
areas outside the stripping-  
limit line where the over-  
burden thickness exceeds  
200 feet (61 m).

To convert short tons to metric  
tons, multiply by 0.907.

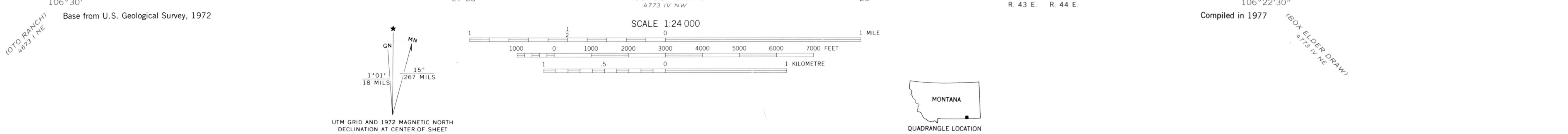
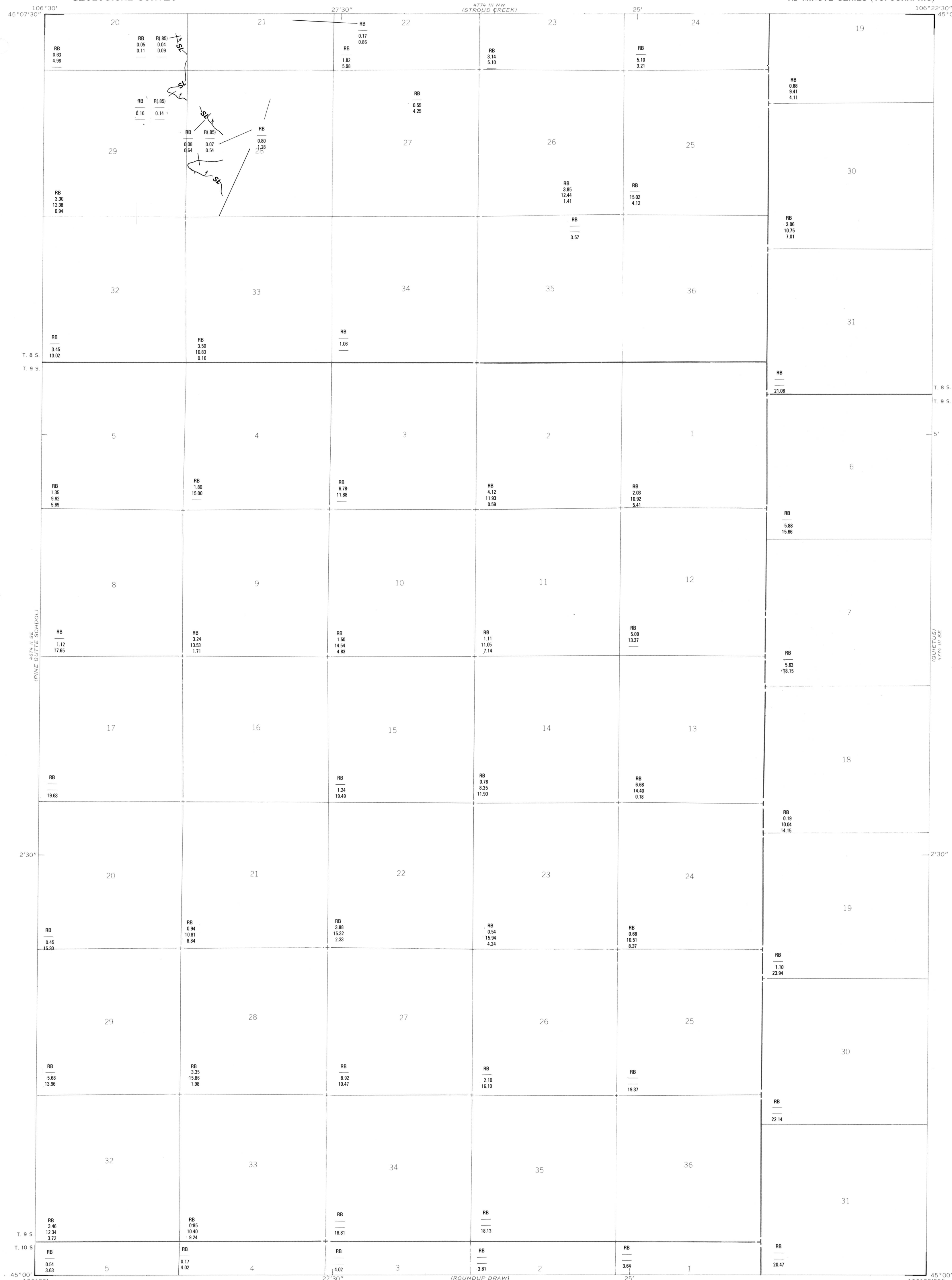

COAL RESOURCE OCCURRENCE AND COAL DEVELOPMENT POTENTIAL  
MAPS OF THE FORKS RANCH QUADRANGLE, BIG HORN COUNTY, MONTANA

By  
W. C. CULBERTSON, L. N. ROBINSON, AND T. M. GAFFKE  
1979