

EXPLANATION



NON-FEDERAL COAL LAND--Land for
which the Federal Government
does not own the coal rights.

RB (Measured resources)
— (Indicated resources)
0.07 (Inferred resources)

IDENTIFIED NON-STRIPPABLE COAL
RESOURCES--Showing totals
for Reserve Base (RB), in
millions of short tons, for
each section or part(s) of
section of Federal coal land
outside the stripping-limit
line. Dash indicates no
resources in that category.

BOUNDARY OF RESERVE BASE
COAL--Drawn along the 5-foot
(1.5 m) coal isopach. Arrows
point toward area of Reserve
Base coal.

Recovery factors have not been
established for underground
development of coal in this
quadrangle. Therefore,
Reserves (R) were not calcu-
lated for the coal bed in
areas outside the stripping-
limit line where the over-
burden thickness exceeds
200 feet (61 m).

To convert short tons to metric
tons, multiply by 0.907.

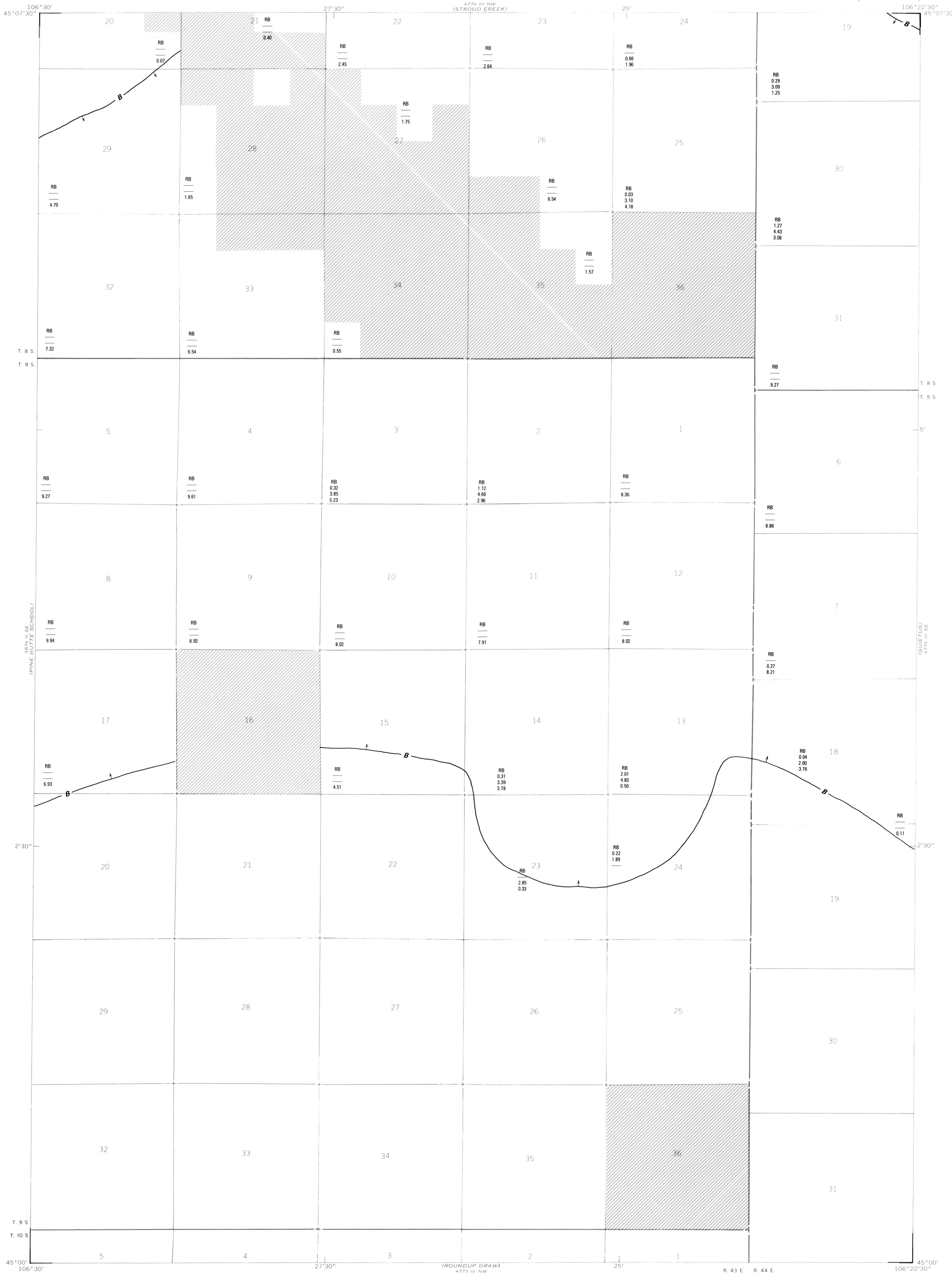

Base from U.S. Geological Survey, 1972

SCALE 1:24 000

Compiled in 1977

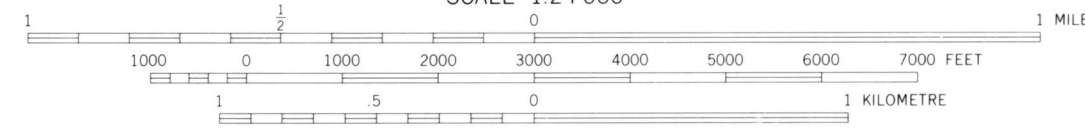
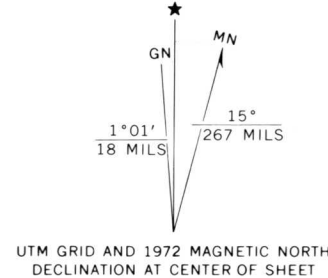

COAL RESOURCE OCCURRENCE AND COAL DEVELOPMENT POTENTIAL
MAPS OF THE FORKS RANCH QUADRANGLE, BIG HORN COUNTY, MONTANA

By
W. C. CULBERTSON, L. N. ROBINSON, AND T. M. GAFFKE
1979