

EXPLANATION

— 15 —
ISOPACHS OF THE COAL BED—
Showing thickness in feet.
Isopach interval 1 foot.

○ 15
DRILL HOLE—Showing thickness
of coal bed, in feet.

To convert feet to meters,
multiply by 0.3.

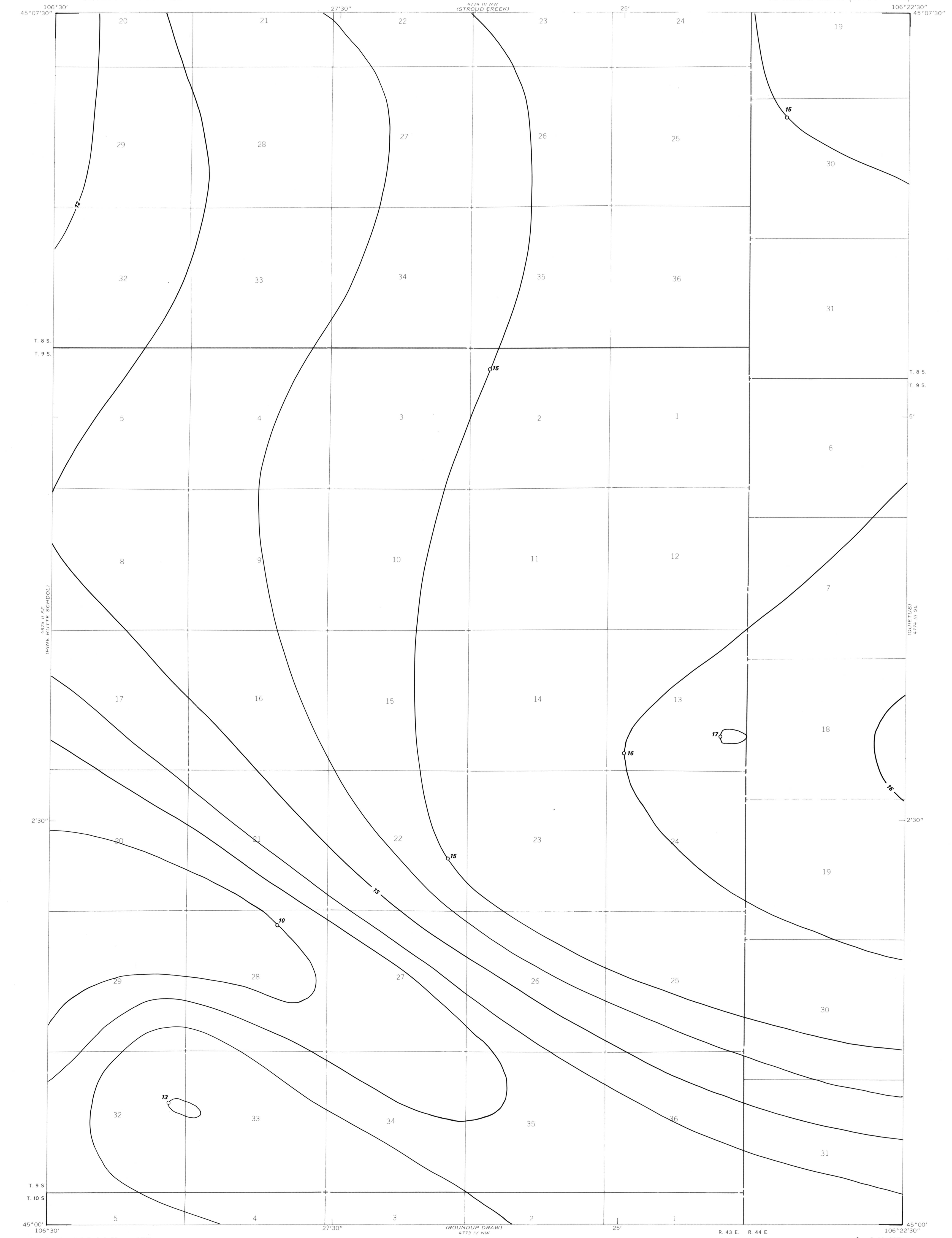

Base from U.S. Geological Survey, 1972

SCALE 1:24 000

Compiled in 1977

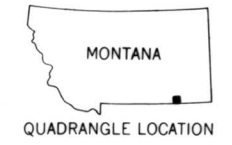
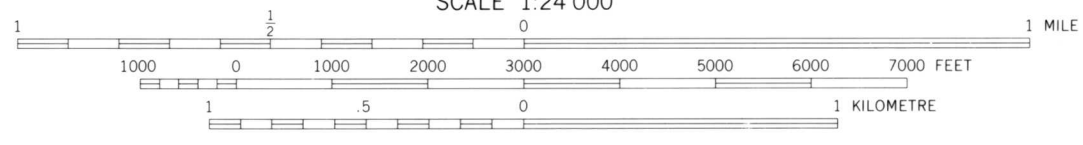
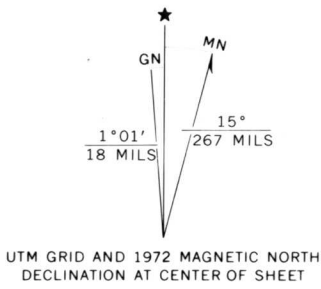

COAL RESOURCE OCCURRENCE AND COAL DEVELOPMENT POTENTIAL
MAPS OF THE FORKS RANCH QUADRANGLE, BIG HORN COUNTY, MONTANA
By
W. C. CULBERTSON, L. N. ROBINSON, AND T. M. GAFFKE
1979