

EXPLANATION



NON-FEDERAL COAL LAND--Land for  
which the Federal Government  
does not own the coal rights.

RB (Measured resources)  
— (Indicated resources)  
- - - (Inferred resources)

IDENTIFIED NON-STRIPPABLE COAL  
RESOURCES--Showing totals  
for Reserve Base (RB), in  
millions of short tons, for  
each section or part(s) of  
section of Federal coal land  
outside the stripping-limit  
line. Dash indicates no  
resources in that category.

Recovery factors have not been  
established for underground  
development of coal in this  
quadrangle. Therefore,  
Reserves (R) were not calcu-  
lated for the coal bed in  
areas outside the stripping-  
limit line where the over-  
burden thickness exceeds  
200 feet (61 m).

To convert short tons to metric  
tons, multiply by 0.907.

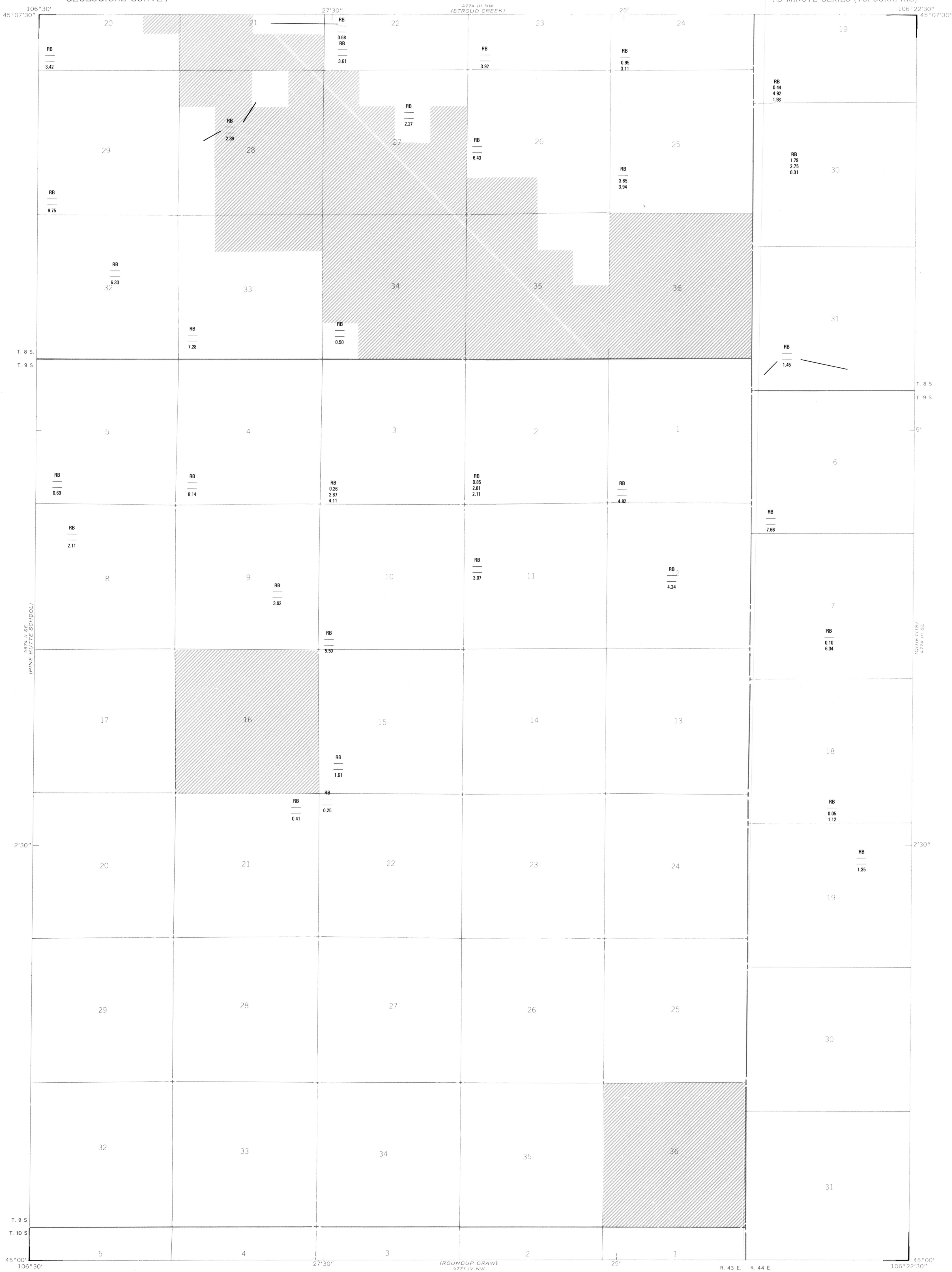

Base from U.S. Geological Survey, 1972

(ROUNDUP DRAW)  
4773 1/4 NW

SCALE 1:24 000

R. 43 E. R. 44 E.

Compiled in 1977

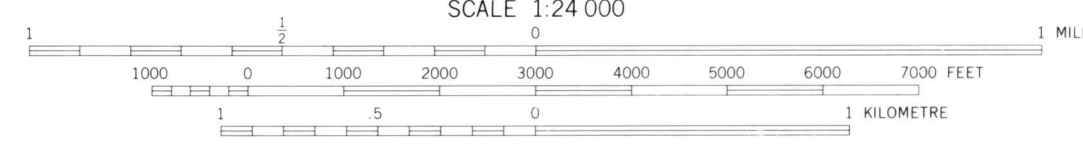
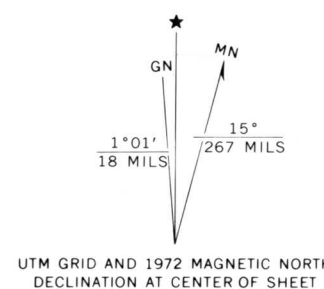

COAL RESOURCE OCCURRENCE AND COAL DEVELOPMENT POTENTIAL  
MAPS OF THE FORKS RANCH QUADRANGLE, BIG HORN COUNTY, MONTANA

By

W. C. CULBERTSON, L. N. ROBINSON, AND T. M. GAFFKE  
1979