

EXPLANATION

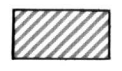

NON-FEDERAL COAL LAND--Land for which the Federal Government does not own the coal rights, and for which the coal-development potential is not rated.



AREA OF HIGH COAL-DEVELOPMENT POTENTIAL FOR SURFACE-MINING METHODS--Area has mining ratio values ranging from 0 to 10.

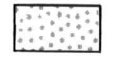

AREA OF MODERATE COAL-DEVELOPMENT POTENTIAL FOR SURFACE-MINING METHODS--Area has mining ratio values ranging from 10 to 15.

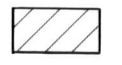

AREA OF LOW COAL-DEVELOPMENT POTENTIAL FOR SURFACE-MINING METHODS--Area has mining ratio values greater than 15.

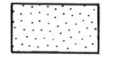

AREA NOT HAVING POTENTIAL FOR SURFACE MINING METHODS--Area does not contain coal 5 feet (1.5 m) or more thick within 200 feet (61 m) of the surface.

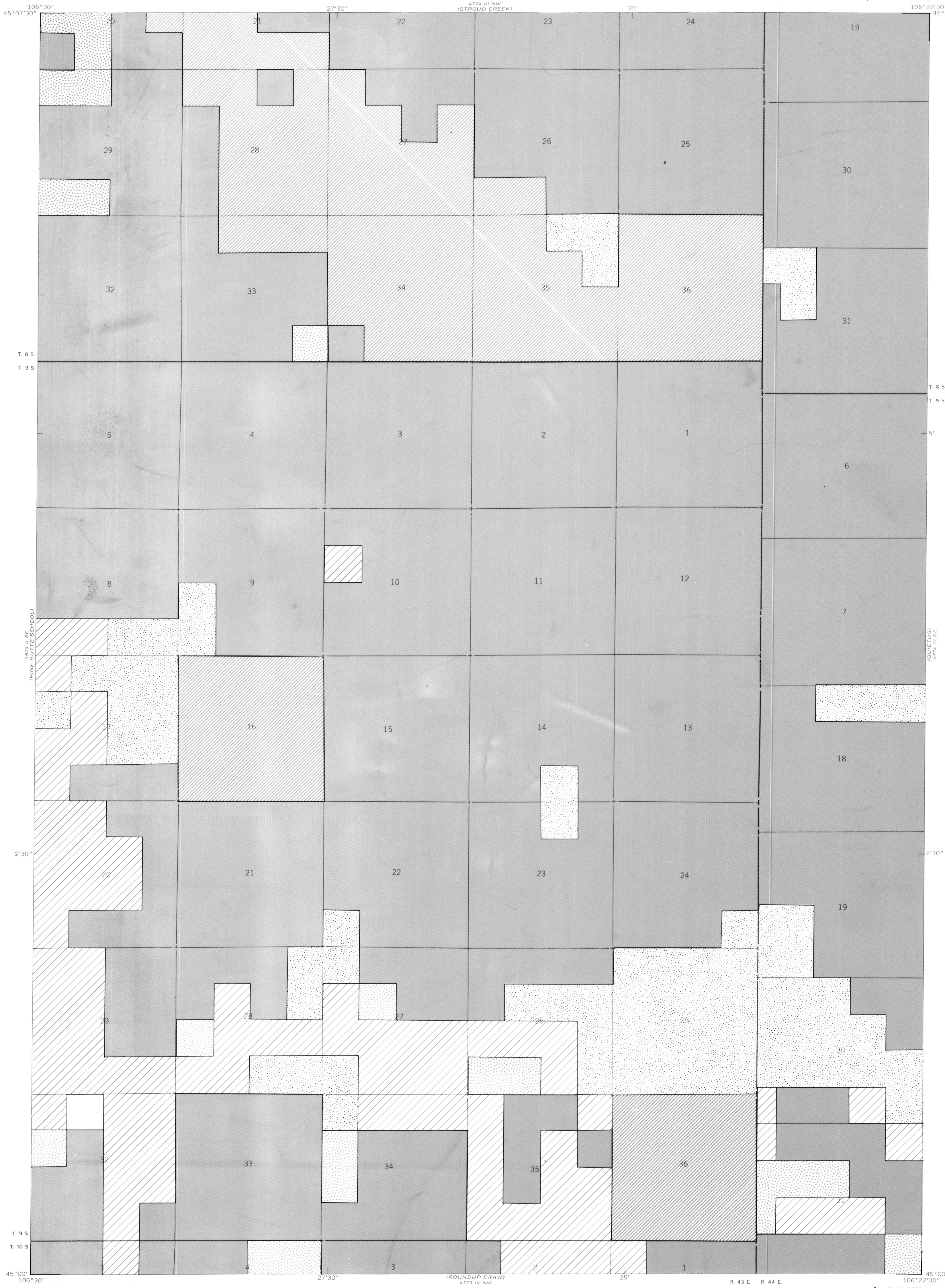

Base from U.S. Geological Survey, 1972

SCALE 1:24 000

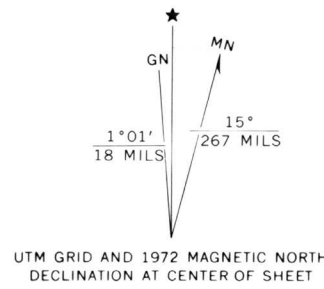
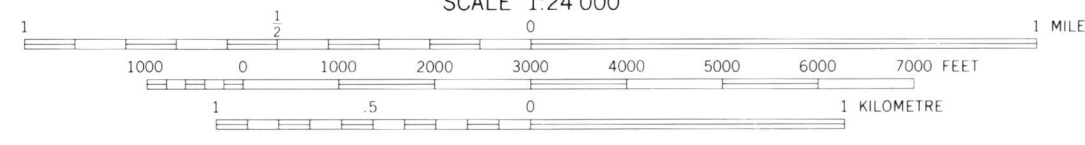

COAL RESOURCE OCCURRENCE AND COAL DEVELOPMENT POTENTIAL
MAPS OF THE FORKS RANCH QUADRANGLE, BIG HORN COUNTY, MONTANA

By

W. C. CULBERTSON, L. N. ROBINSON, AND T. M. GAFFKE
1979