

EXPLANATION

 NON-FEDERAL COAL—Land for which the Federal Government does not own the coal rights.

RB (Measured resources)  
0.5 (Indicated resources)  
0.7 (Inferred resources)

IDENTIFIED COAL RESOURCES OF COAL BED—Showing totals for Reserve Base (RB), in millions of short tons, for each section or part(s) of section of Federal coal land outside the stripping-limit line. Dash indicates no resources in that category.

To convert short tons to metric tonnes multiply short tons by 0.9072.

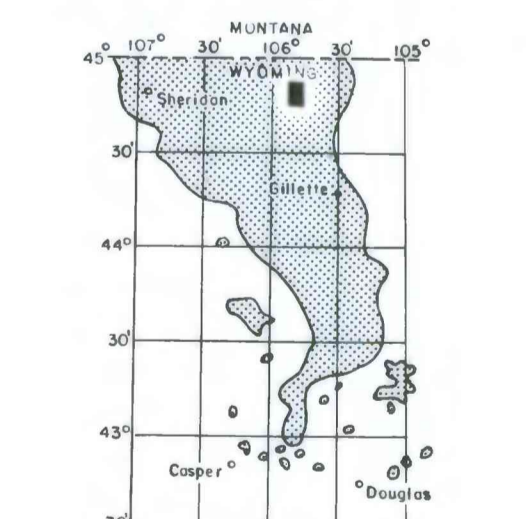
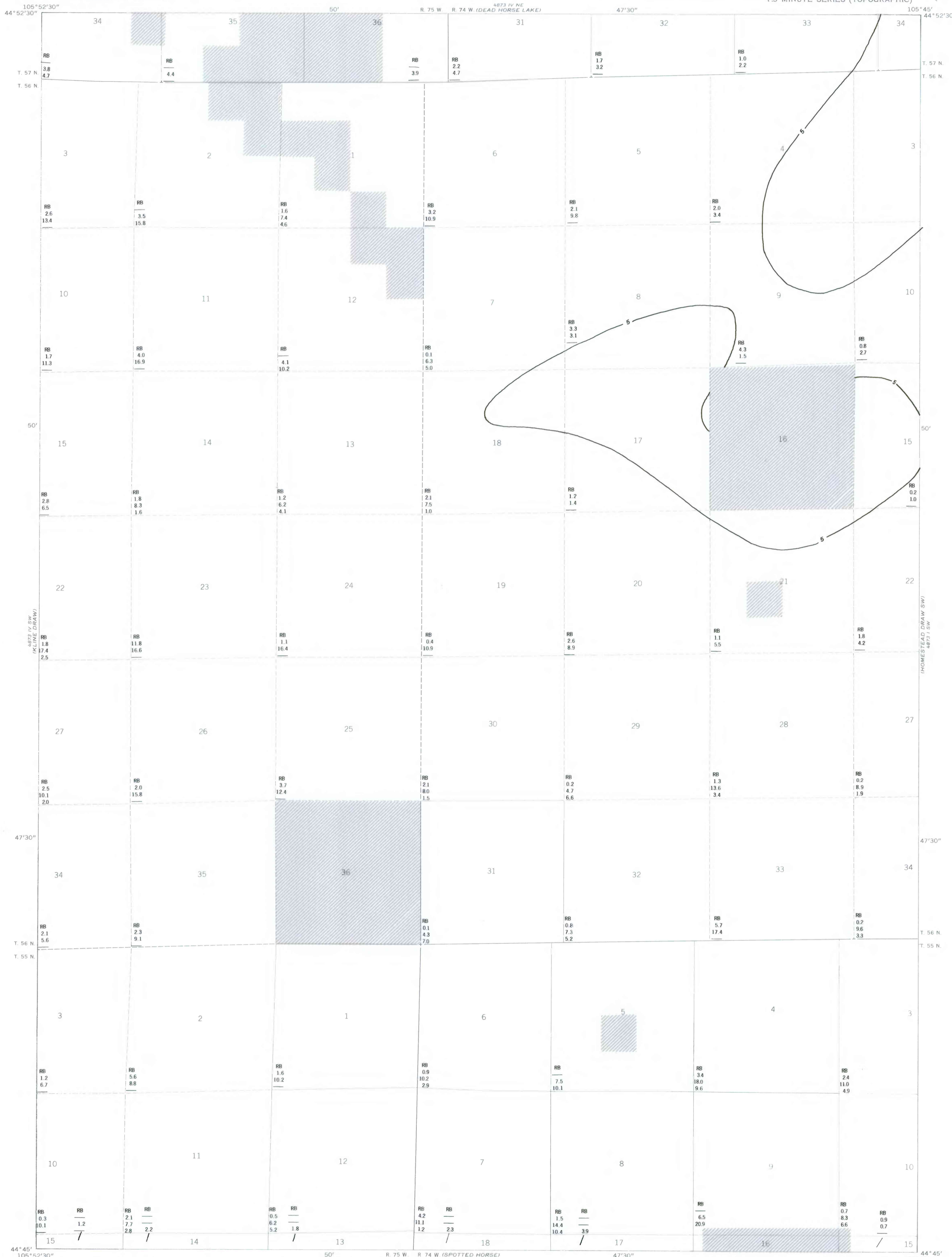

MAP SHOWING LOCATION OF THE RESERVOIR CREEK QUADRANGLE AND THE POWDER RIVER BASIN KNOWN RECOVERABLE COAL RESOURCE AREA (STIPPLED), WYOMING

COAL RESOURCE OCCURRENCE MAP OF THE RESERVOIR CREEK  
QUADRANGLE, CAMPBELL COUNTY, WYOMING  
BY  
**IntraSearch**  
1978

This report has not been edited for conformity with Geological Survey editorial standards or stratigraphic nomenclature.

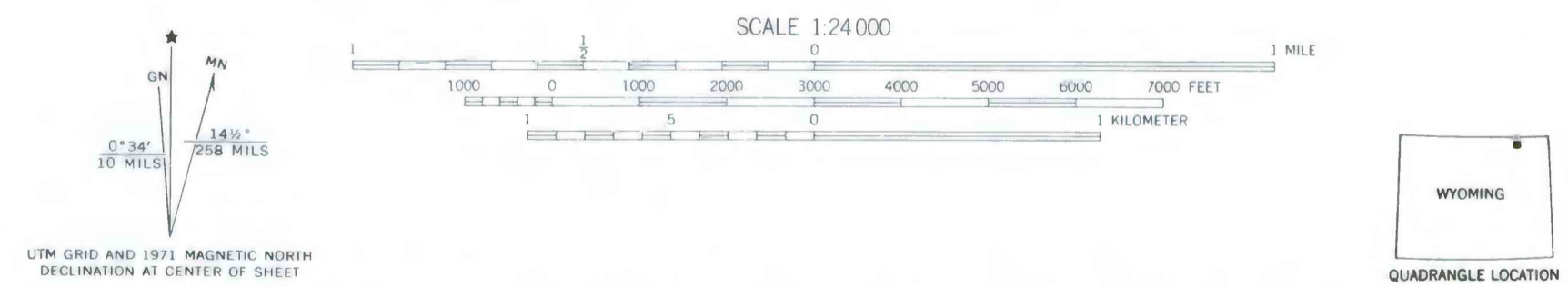

Base from U.S. Geological Survey, 1971

Compiled in 1978