

This report has not been edited for conformity with U.S. Geological Survey editorial standards or stratigraphic nomenclature.

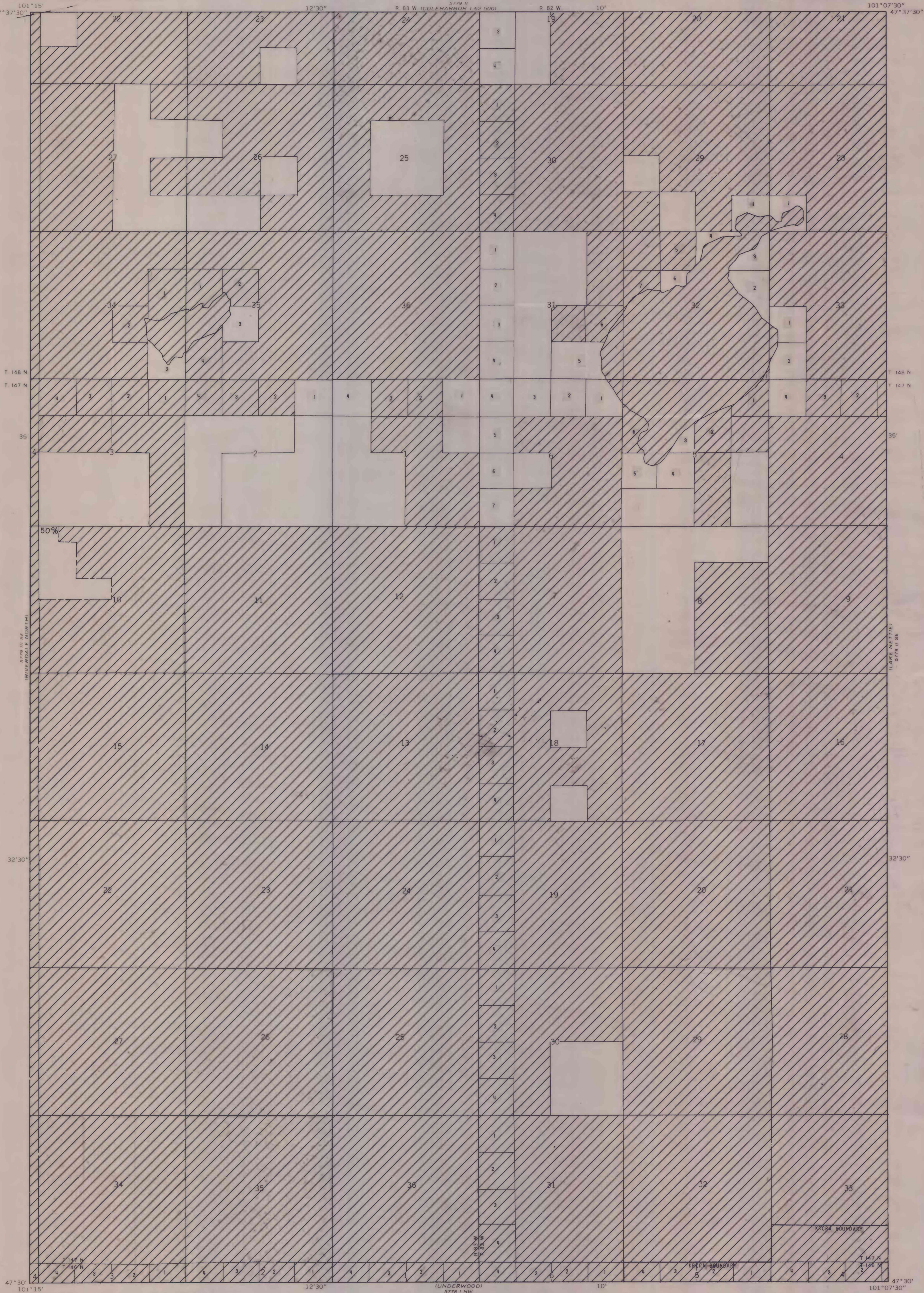

EXPLANATION



NON-FEDERAL COAL LAND - Land for which the Federal Government does not own the coal rights.

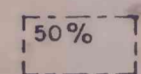

RESTRICTED FEDERAL COAL RIGHTS - Showing the percentage of Federal Government ownership.

4	3	2	1
5	6		
6			
7			

SECTION OF LAND - Showing lots and lot numbers.

REFERENCE

U.S. Bureau of Mines and U.S. Geological Survey, 1976. Coal resource classification system of the U.S. Bureau of Mines and U.S. Geological Survey, U.S. Geol. Survey Bull. 1450-B, 7 p.

Bureau of Land Management data current as of March 31, 1978.

BASE FROM U.S. GEOLOGICAL SURVEY, 1970

(UNDERWOOD)
5779 1 NW
SCALE 1:24 000

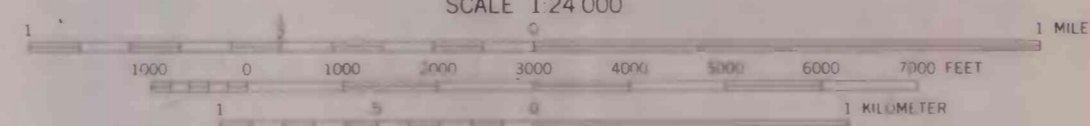

1978 AND 1972 MAGNETIC NORTH
DECLINATION AT GREATERTON SHEET

NORTH DAKOTA
QUADRANGLE LOCATION

COAL RESOURCE OCCURRENCE MAP OF THE COLEHARBOR QUADRANGLE,
McLEAN COUNTY, NORTH DAKOTA

BY
WOODWARD-CLYDE CONSULTANTS
1978